

MAAX SUBMITTAL SPECIFICATIONS

Utile Factory Sleek back wall 48"

MODEL NUMBER 103421-305

DIMENSIONS: 48" x 1 1/8" x 80"



Project :
Contractor :
MAAX Representative : Tel :
Date :

www.maax.com

Vivez l'expérience
MAAX®
Enjoy the experience

STANDARD FEATURES

- Realistic looking tile and grout
- Solid, one-piece walls: Sturdy and durable
- Mistake-proof Ulok system makes assembly simple and quick
- Corner or alcove shower and tub shower installation
- 10-year warranty
- 1 corner shelf included

OPTIONS

- Glass shelf
- 18" modern straight grab bar with flange
- Glass shelf (10-Pack)
- 24" modern straight grab bar with flange
- 30" modern straight grab bar with flange
- 36" modern straight grab bar with flange

UNIQUE FEATURES

- Ulok system

SYSTEMS

- None

DOOR SELECTION

Combine with MAAX's complete shower door offering visit www.maax.com

CERTIFICATIONS

Maax products adhere to one or more of the following certifications:



2018-01-08

MAAX SUBMITTAL SPECIFICATIONS

Utile Factory Sleek back wall 48"

MODEL NUMBER 103421-305

TECHNICAL DRAWINGS

BACK WALL

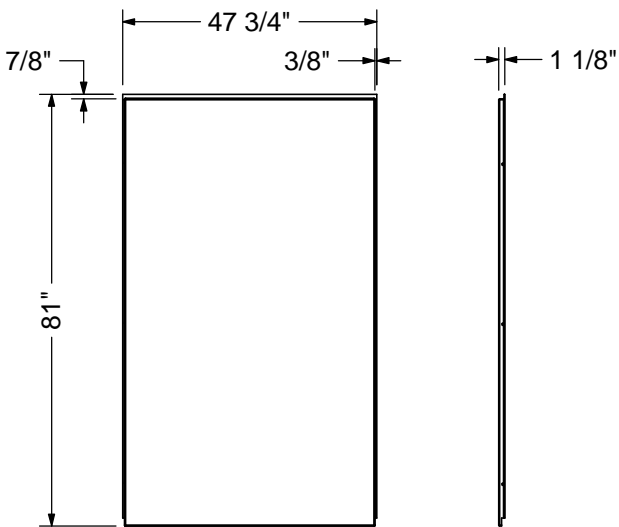

SIDE WALL

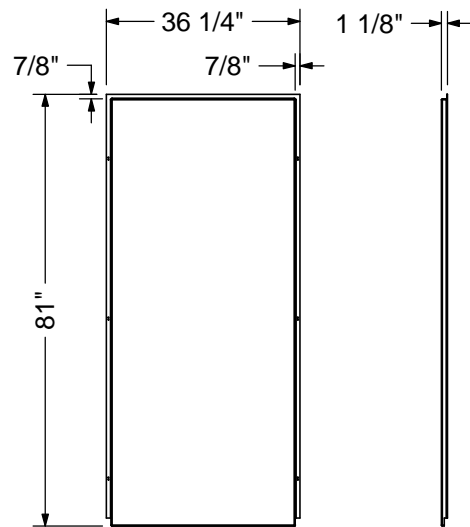

TOP VIEW (ASSEMBLED)

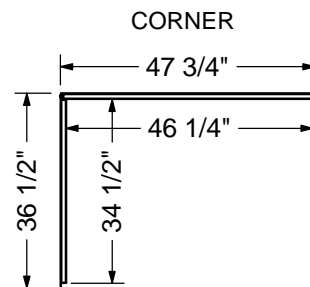
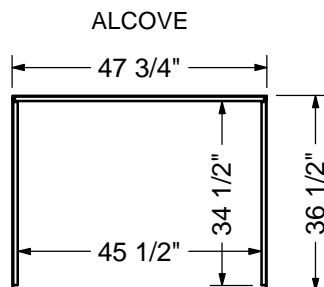

This product is designed to be installed in a building that conforms with the requirements of the National Building Code of Canada 2005

All dimensions are approximate. Structure measurements must be verified against the unit to ensure proper fit.