

MAAX SUBMITTAL SPECIFICATIONS

Vichy 6032 A

MODEL NUMBER 102941

DIMENSIONS: 60" x 33" x 20" Acrylic



Vivez l'expérience
MAAX[®]
Enjoy the experience

STANDARD FEATURES

- Relaxing armrests and ergonomic backrest
- Headrest
- Integrated apron with optional access panel (specify when ordering)
- Tiling flange
- Alcove installation only with end drain
- Available with right or left-hand drain



OPTIONS

- Flexible main hose 9 ft for air push control
- Acrylic apron with access
- Metal trim kit for Air Push Control
- One chromatherapy light

UNIQUE FEATURES

- Tiling Flange

SYSTEMS

-  MAAX Professional Whirlpool
-  Aeroeffect **DOOR**
-  Combined Whirlpool/Aeroeffect

SELECTION

Combine with MAAX's complete shower door offering visit www.maax.com

CERTIFICATIONS

Maax products adhere to one or more of the following certifications:



Project :
Contractor :
MAAX Representative : Tel :
Date :

www.maax.com

2018-01-08

MAAX SUBMITTAL SPECIFICATIONS

Vichy 6032 A

MODEL NUMBER 102941

TECHNICAL DRAWINGS

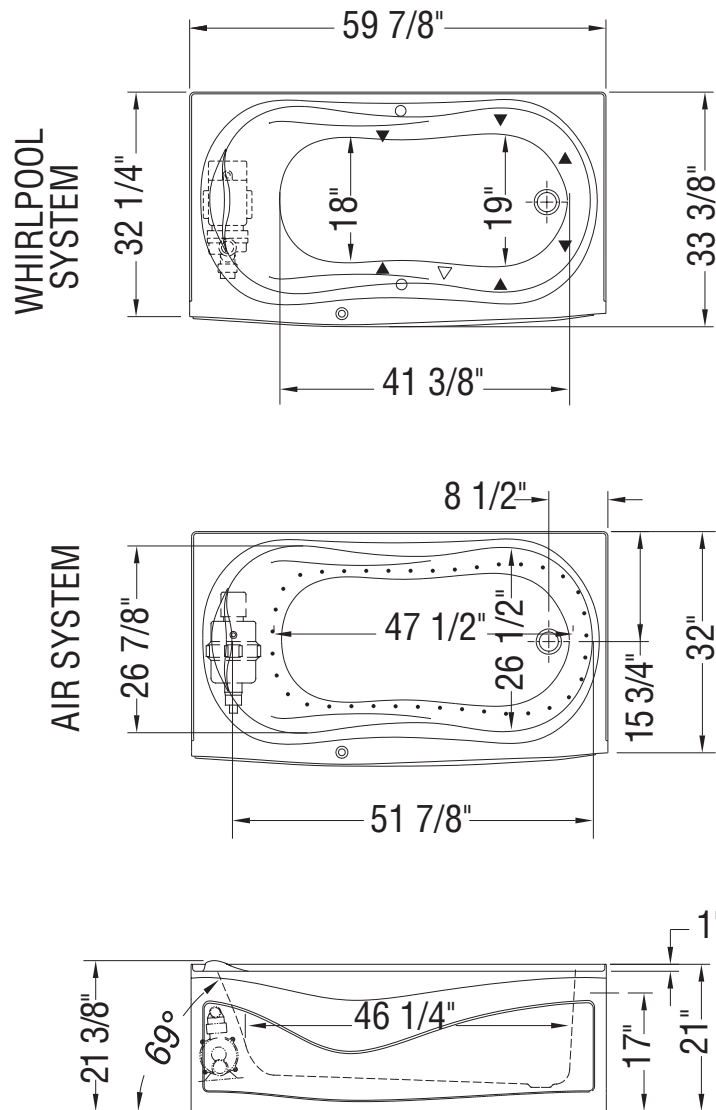

- (▲): Indicates Whirlpool jets positioning
- (•): Indicates airjets positioning
- (△): Indicates suction positioning

All dimensions are approximate. Structure measurements must be verified against the unit to ensure proper fit.