

OUTLOOK™ BFTS-60F 2-PIECE TUB SHOWER

ADA COMPLIANT



DATE: _____

JOB NAME: _____

CUSTOMER: _____

QUOTE #: _____

SHIP TO: _____

PO #: _____

PHONE #: _____

QTY: _____

SPECIAL NOTES: _____

_____/_____/_____
PLUMBING CONTRACTOR APPROVAL DATE

_____/_____/_____
GENERAL CONTRACTOR APPROVAL DATE

_____/_____/_____
ENGINEER APPROVAL DATE

_____/_____/_____
ARCHITECT APPROVAL DATE

**To complete your order, this document must be signed and faxed to the MAAX Order Desk nearest you.
Please see reverse for fax number.**

INT. DIM.	56-1/2 x 31 x 74 (1435 x 787 x 1880)
EXT. DIM.	59-7/8 X 33-1/4 X 77 (1521 X 845 X 1956)
THRESHOLD HT.	N/A
WEIGHT	200 lbs (91 kg) gross
WARRANTY	Fiberglass - Three years
CODE LISTED	ADA
STANDARD FEATURES	<ul style="list-style-type: none"> • Reinforced unit • Left or right hand drain, please specify • Textured bottom

INCLUDED OPTIONS

Please specify colors/finishes when ordering

- Rectangular Fold-Up Seat or Drop-In Seat:
 - ☐ Naugahyde (381) ☐ Phenolic (382) ☐ Left ☐ Right
- 12-in. Straight Grab Bar:
 - ☐ White (001) ☐ Stainless Steel (106)
- 3 x 24-in. Straight Grab Bar:
 - ☐ White (001) ☐ Stainless Steel (106)
- 60-in. Curtain Rod with Grommets: Stainless Steel (106)
- 60-in. White Vinyl Shower Curtain with Stainless Steel Hooks (106)

WHIRLPOOL SYSTEM

☐ Whirlpool

ADDITIONAL ACCESSORIES AND OPTIONS¹

Please specify colors/finishes when ordering

- ☐ **Straight Grab Bar**
 - ☐ 12 in. ☐ 18 in. ☐ 24 in. ☐ 30 in. ☐ 42 in. ☐ 48 in.
 - ☐ White (001) ☐ Stainless Steel (106)
- ☐ **Horizontal L-Shaped Grab Bar**
 - ☐ White (001) ☐ Stainless Steel (106)
- ☐ **Built-In Soap Dish***
 - ☐ White (001) ☐ Stainless Steel (106)
- ☐ **Pressure Balance Mixing Valve with**
 - 1-function Hand-Held Shower including Slide Bar with 60-in. Hose and Vacuum Breaker: Chrome (084)*
 - ☐ 24-in. Slide Bar ☐ 36-in. Slide Bar

* Pressure balance mixing valve and soap dish are not factory installed.

¹Please indicate custom positionings on reverse side drawings.
Additional charges may apply.



Please indicate custom positionings*

* Repositioning the grab bar or seat outside of the compliant zones render the unit no longer compliant. Consult code regulations.

Right-hand model shown.

Unless otherwise specified, the option and grab bar positioning is pre-determined by the seat location; please specify seat location when ordering (R/L).

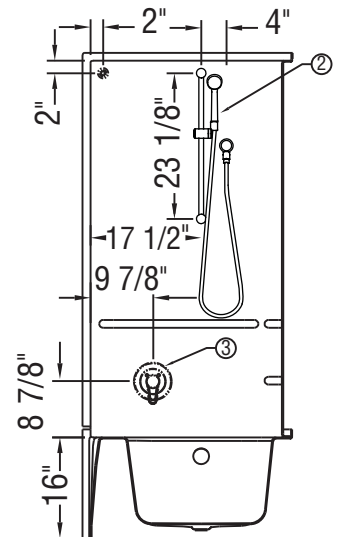
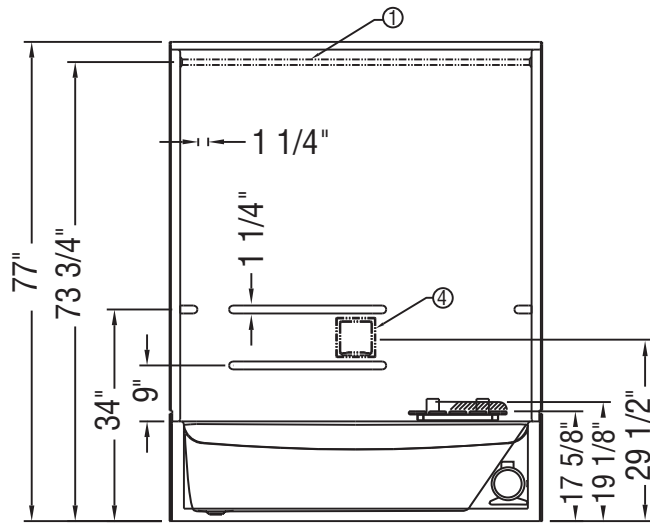
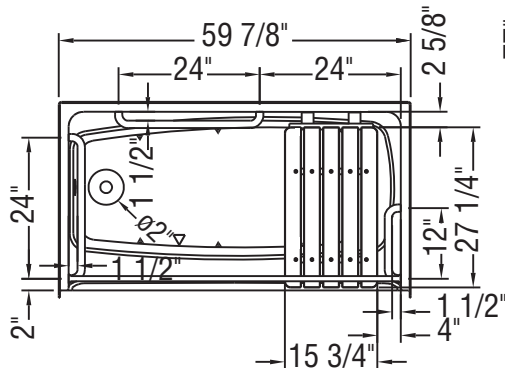

① Curtain rod (included)

② Hand-held shower (slide bar factory installed)

③ Pressure valve (not factory installed)

④ Soap dish (not factory installed)

FRAMING

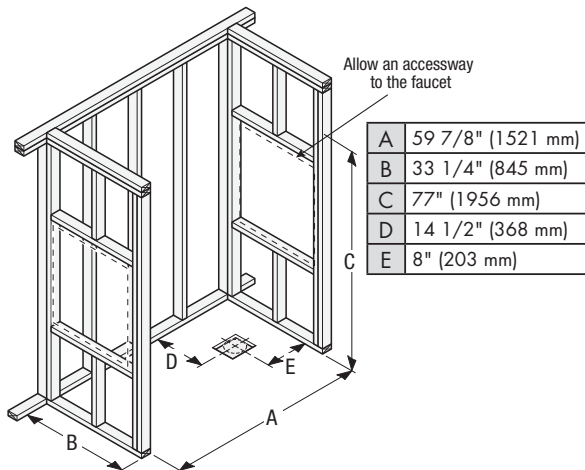

CLEARANCE

Tub Shower 60"x32"				
	ADA	ADA (MA) ¹	ADA (MN) ²	
A	60" Min	48" Min	60" Min	
B	30" ³	48" ⁴	36" Min	30" ³ 48" ⁴

¹ (MA) Massachusetts

² (MN) Minnesota

³ Entry #B

⁴ Entry #A

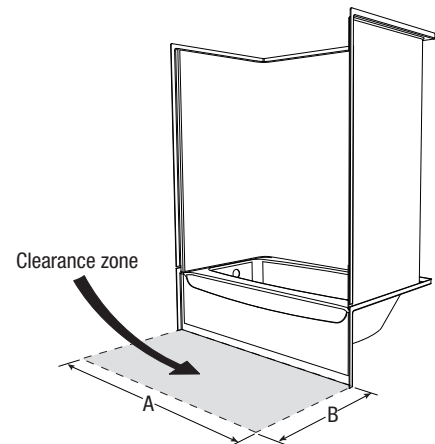

Please fax to:

MAAX Beauce, Quebec: 1-800-201-8308

MAAX Lachine, Quebec: 1-888-361-2045

MAAX Armstrong, British Columbia: 1-888-514-4442