



Buy it for looks. Buy it for life.®

# Specifications

## DESCRIPTION

- Metal construction
- Installs on 10"(254mm) centers minimum
- Designed to be installed on finished decks up to 3-3/8" (86mm)
- 24" quick connect hoses
- Integral 1/2" PEX connections
- Includes (2) 1/2" CPVC adapters
- Includes brass test plug
- 140715 kit available separately to connect to 1/2" cold expansion PEX

## OPERATION

- Can be installed with any Moen deck mounted roman tub trim kit
- Rotate hot side handle counterclockwise to open (clockwise to close) and the cold side handle clockwise to open (counterclockwise to close)

## FLOW

- Designed to deliver 13 gpm at 45 psi. (49L/min)

## CARTRIDGE

- Nonmetallic and stainless steel materials

## STANDARDS

- Designed and manufactured to comply with the applicable requirements of: ASME A112.18.1/CSA B-125.1, ASTM F1807, CSA B137.5 for PEX, ASTM D2846, CSA B137.6 for CPVC and all applicable requirements referenced therein
- 1/2" PEX fittings compatible with PEX tubing manufactured to ASTM F877
- 1/2" CPVC fittings manufactured to ASTM D2846

## WARRANTY

- Lifetime limited warranty against leaks, drips and finish defects to the original consumer purchaser
- 5 year warranty if used in commercial installations

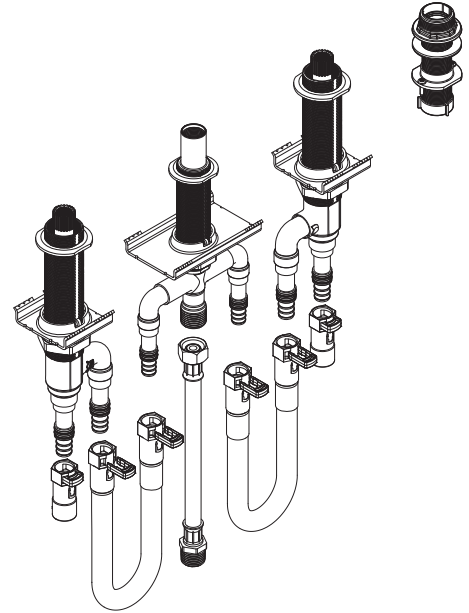

**Roman Tub High Flow Rough-In Valve (Adjustable Type)**

**Model: 9793**

**(104465 Thermostatic mixing valve sold separately)**

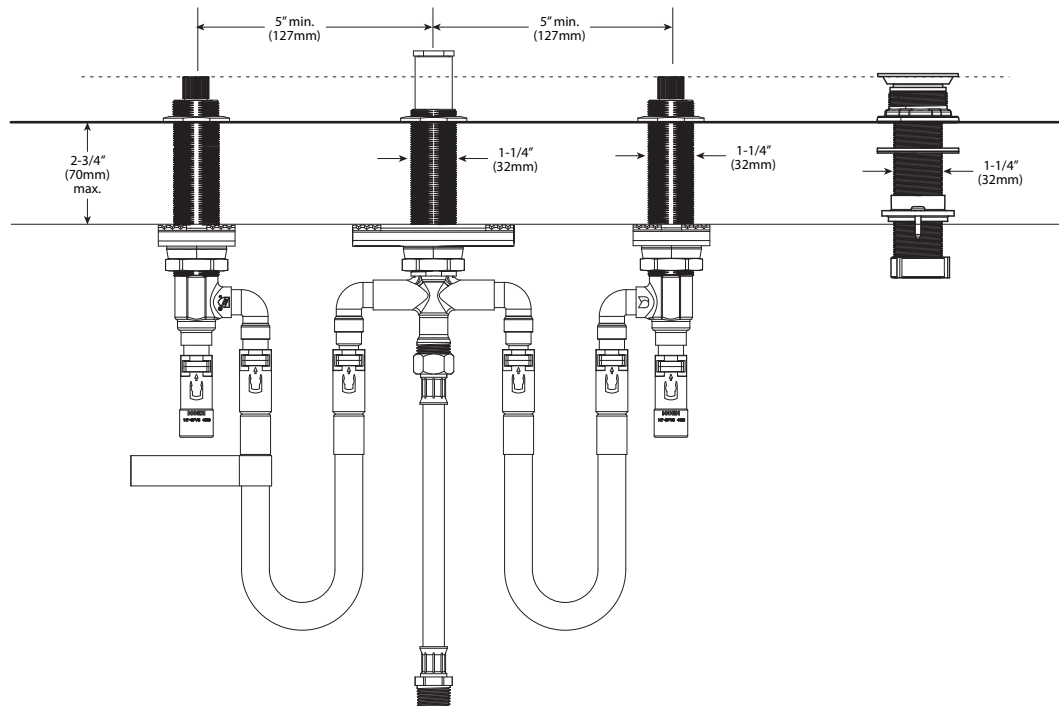

## CRITICAL DIMENSIONS

(DO NOT SCALE)

**FOR MORE INFORMATION CALL: 1-800-BUY-MOEN**

**www.moen.com**