



# MODA™ ICE MAKER OUTLET BOX TECHNICAL SPECIFICATION

Job Name _____	Item # _____
Location _____	
Engineer _____	Contractor _____
PO # _____	Tag _____
Representative _____	

## SPECIFICATIONS

Oatey MODA™ ice maker supply boxes shall be used in residential or commercial applications requiring a supply valve recessed in the wall. The MODA™ ice maker box assembly contains a ¼" OD compression valve pre-installed in a PVC box, with inter-locking wing flanges on each side. The wing flanges shall allow installation on a single stud, or between two studs using the included side brackets. No additional components shall be required for a between stud installation. Valves shall be a two-piece design, permitting field replacement, and shall be secured with a stainless steel retention clip. Valves are available with or without water hammer arrestors and shall be installed upright or inverted. The assembly shall include an emergency drain port for protection from tubing leaks.

## APPROVALS & LISTINGS

Valves	ASME A112.18.1 / CSA B125.1 NSF / ANSI 61 & 372
Water Hammer Arrestors	ASSE 1010
Boxes	IAPMO-Listed, PS-54



## FEATURES & MATERIALS

Outlet Box & Brackets	PVC
Valve Body	Forged Brass C46500 No Lead
Valve Retention Clip	Stainless Steel
Valve O-Rings	NSF/FDA Approved EPDM (2)
Temperature Rating (Valve)	250° F / 121° C
Max Testing Pressure	100 psi (Air) / 250 psi (Water)

## DIMENSIONS

[A]:	Box Width	8.00"	[E]:	Bracket Length	8.00"
[B]:	Box Depth	3.38"	[F]:	Faceplate Width	6.00"
[C]:	Box Height	4.85"	[G]:	Faceplate Height	6.45"
[D]:	Bracket Width	4.00"	[H]:	Faceplate Depth	1.25"

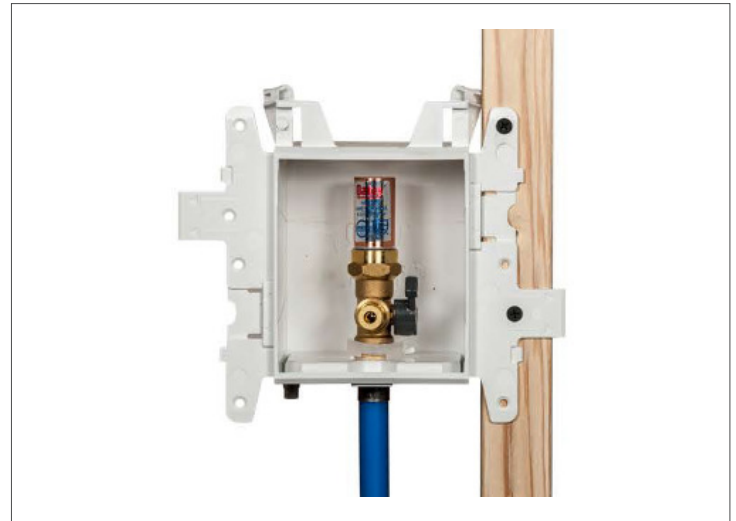

## Accessory Components Included:



Side Brackets (2)



Faceplate (1)



Sticker Cover  
(For Debris Protection)

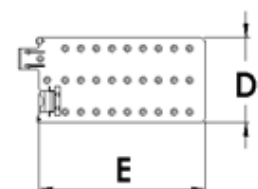
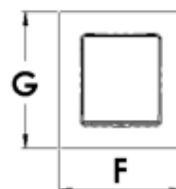
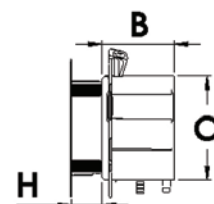
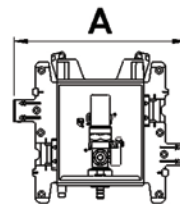

Access BIM/Revit content through [www.oatey.com](http://www.oatey.com)



**MODA™ ICE MAKER  
OUTLET BOX  
TECHNICAL SPECIFICATION**

**PRODUCT SELECTOR**

NO HAMMER ARRESTORS				HAMMER ARRESTORS			
✓	Product Number	Description	Ctn. Qty.	✓	Product Number	Description	Ctn. Qty.
	37679	MODA Ice Maker, Copper (Male), Standard	12		37687	MODA Ice Maker, Copper (Male), Standard	12
	37681	MODA Ice Maker, F1807 PEX (Brass), Standard	12		37689	MODA Ice Maker, F1807 PEX (Brass), Standard	12
	37682	MODA Ice Maker, F2159 PEX (PPSU), Standard	12		37690	MODA Ice Maker, F2159 PEX (PPSU), Standard	12
	37683	MODA Ice Maker, F1960 PEX (Brass), Standard	12		37691	MODA Ice Maker, F1960 PEX (Brass), Standard	12
	37684	MODA Ice Maker, F1960 PEX (PPSU), Standard	12		37692	MODA Ice Maker, F1960 PEX (PPSU), Standard	12
	37680	MODA Ice Maker, CPVC (Male), Standard	12		37688	MODA Ice Maker, CPVC (Male), Standard	12
	37686	MODA Ice Maker, Push Connect, Standard	12		37694	MODA Ice Maker, Push Connect, Standard	12
	37695	MODA Ice Maker, Copper (Male), Contractor	12		37703	MODA Ice Maker, Copper (Male), Contractor	12
	37697	MODA Ice Maker, F1807 PEX (Brass), Contractor	12		37705	MODA Ice Maker, F1807 PEX (Brass), Contractor	12
	37698	MODA Ice Maker, F2159 PEX (PPSU), Contractor	12		37706	MODA Ice Maker, F2159 PEX (PPSU), Contractor	12
	37699	MODA Ice Maker, F1960 PEX (Brass), Contractor	12		37707	MODA Ice Maker, F1960 PEX (Brass), Contractor	12
	37700	MODA Ice Maker, F1960 PEX (PPSU), Contractor	12		37708	MODA Ice Maker, F1960 PEX (PPSU), Contractor	12
	37696	MODA Ice Maker, CPVC (Male), Contractor	12		37704	MODA Ice Maker, CPVC (Male), Contractor	12

Standard packs shipped with faceplates on boxes, contractor packs ship with faceplates packaged separately.