



MODA™ ICE MAKER SUPPLY BOX WITH STAINLESS STEEL HOSE TECHNICAL SPECIFICATION

SPECIFICATIONS

Oatey's Ice Maker Supply Box with Hose shall be used in commercial or residential applications which require supply valves recessed into the wall. The box includes 6' Stainless Steel Hose for connection to appliance. Provides quick, safe water supply and shut-off for refrigerator icemaker and water dispenser. Stainless steel hose allows for easy connection to appliance

APPROVALS AND LISTINGS

Valves	NSF Standard 61, Section 9
Boxes	IAPMO Listed



FEATURES & MATERIALS

Box Material	High Impact Polystyrene
Hose Material	Stainless Steel
Faceplate	7-3/8" Diameter
Snap-On Faceplate	Accommodates Up To 1" Drywall

DIMENSIONS

[A]:	Box Width	6.70"	[F]:	Bracket Height	2.06"
[B]:	Box Height	5.24"	[G]:	Bracket Width	7.62"
[C]:	Box Opening Width	5.06"	[H]:	Faceplate Width	7.43"
[D]:	Box Opening Height	5.22"	[I]:	Faceplate Height	0.72"
[E]:	Box Depth	3.08"	[J]:		

Job Name	Item #
Location	
Engineer	Contractor
PO #	Tag
Representative	



Accessory Components Included:



Side Brackets (2)



Faceplate (1)

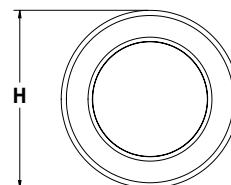
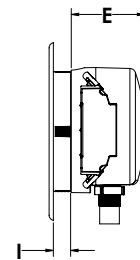
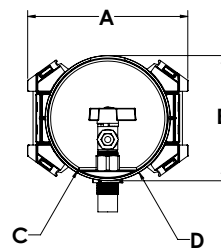

Access BIM/Revit content through www.oatey.com



**MODA™ ICE MAKER
SUPPLY BOX WITH
STAINLESS STEEL HOSE
TECHNICAL SPECIFICATION**

PRODUCT SELECTOR

ICE MAKER SUPPLY BOX WITH STAINLESS STEEL HOSE			
✓	Product Number	Description	CTN. QTY.
	39265	Round IMOB ¼ Turn Copper Contractor pack, SS Hose LL	12
	39266	Round IMOB ¼ Turn Copper Standard Pack, SS Hose LL	6
	39267	Round IMOB ¼ Turn CPVC Standard Pack, SS Hose LL	6
	39207	¼ turn brass ball valve - low lead - copper sweat - standard pack	6
	39208	¼ turn brass ball valve - low lead - CPVC - standard pack	6
	39209	¼ turn brass ball valve - low lead ½" ASTM F1807 Pex standard pack	6
	39210	¼ turn brass ball valve - Low Lead ½" ASTM F 1960 Pex standard pack	6
	39211	¼ turn brass hammer ball valve - - low lead - copper sweat - standard pack	6
	39212	¼ turn brass hammer ball valve - low lead - CPVC standard pack	6
	39213	¼ turn brass hammer ball valve - Low Lead ½" ASTM F 1807 Pex standard pack	6
	39214	¼ Turn, Round, F1960 Hammer, Low Lead – Standard Pack	6
	39215	Round Ice Maker outlet box face plate	6
	39216	Plain box - standard pack - no valve	6
	38768	Brackets 4" Long Plastic	12
	38648	Brackets 12" Long Plastic	12