



## ICE MAKER OUTLET BOXES TECHNICAL SPECIFICATION

Job Name _____	Item # _____
Location _____	
Engineer _____	Contractor _____
PO # _____	Tag _____
Representative _____	

### SPECIFICATIONS

Oatey Ice Maker boxes shall be used in commercial or residential applications which require supply valves recessed into the wall. Available water hammer arrestor option provides water pressure shock arrestors required for installation on supply lines to quick closing valves. Provides quick, safe water supply and shut-off for refrigerator, ice maker and water dispenser. Includes 2 support brackets

### APPROVALS AND LISTINGS



### DESCRIPTION

Box	high impact polystyrene
Valves	ASME A112.18.1 / CSA B125.1 NSF / ANSI 61 & 372
Water Hammer Arrestors	ASSE 1010
Snap-on faceplate	accommodates up to 1" drywall

### DIMENSIONS

[A]:	Box Width	6.42"	[F]:	Bracket Height	2.19"
[B]:	Box Height	6.00"	[G]:	Bracket Width	4.22"
[C]:	Box Opening Width	5.83"	[H]:	Faceplate Width	8.19"
[D]:	Box Opening Height	5.83"	[I]:	Faceplate Height	8.07"
[E]:	Box Depth	3.50"	[J]:	Faceplate Depth	0.95"

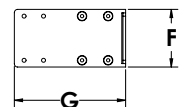
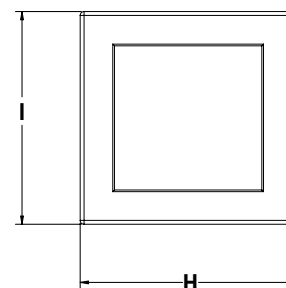
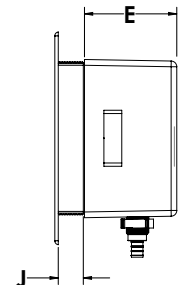
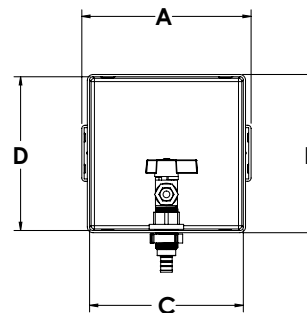

Access BIM/Revit content through [www.oatey.com](http://www.oatey.com)



## ICE MAKER OUTLET BOXES TECHNICAL SPECIFICATION

### PRODUCT SELECTOR

ICE MAKER OUTLET BOXES			
✓	Product Number	Description	CTN. QTY.
	39156	Square, 1/4 Turn, Copper, Low Lead - Standard Pack	6
	39157	Square, 1/4 Turn, Copper, Low Lead - Contractor Pack	12
	39145	Square, 1/4 Turn, Copper, Low Lead - Standard Pack, 6' SS Hose	6
	39155	Square, 1/4 Turn, CPVC, Low Lead - Standard Pack	6
	39158	Square, 1/4 Turn, F1807, Low Lead - Standard Pack	6
	39160	Square, 1/4 Turn, F1807, Low Lead - Contractor Pack	12
	39146	Square, 1/4 Turn, F1807, Low Lead - Standard Pack, 6' SS Hose	6
	39161	Square, 1/4 Turn, F1960 Low Lead - Standard Pack	6
	39154	Square, 1/4 Turn, F1960 Low Lead - Standard Pack, 6' SS Hose	6
	39162	Square, Boiler Drain Copper, Low Lead, NAFTA - Standard Pack	6
	39152	Square, 1/4 Turn, Copper, Hammer, Low Lead - Standard Pack	6
	39151	1/4 Turn Brass Hammer Ball Valve Low Lead - Copper Sweat – Display Box	6
	39142	Square, 1/4 Turn, Copper, Hammer, Low Lead - Standard Pack, 6' SS Hose	6
	39148	Square, 1/4 Turn, CPVC, Hammer, Low Lead - Standard Pack	6
	39143	Square, 1/4 Turn, CPVC, Hammer, Low Lead - Standard Pack, 6' SS Hose	6
	39149	Square, 1/4 Turn, F1807, Hammer, Low Lead - Standard Pack	6
	39148	1/4 Turn Brass Hammer Ball Valve Low Lead - CPVC - Standard	6
	39159	Square 1/4 Turn CPVC Low Lead – Contractor Pack	12
	39150	Square, 1/4 Turn, F1960, Hammer, Low Lead - Standard Pack	6
	39153	Square, 1/4 Turn, CPVC, Low Lead - Standard Pack, 6' SS Hose	6
ACCESSORIES			
	38810	Square, Plain Box, No Valves - Standard Pack	6
	38806	Square, Plain Box, No Valves, With Grommet - Standard Pack	6
	38942	Square, Plastic Faceplate	24
	38768	Brackets 4" Long Plastic	12
	38648	Brackets 12" Long Plastic	12

Valves meet ASME A112.18.1 Water Hammer Arrestors meet ASSE 1010.

Data is subject to manufacturing tolerances.