

Quick-Connect



Quick-Connect Plumbing Products Catalog and Price List

Effective September 4, 2012

Throughout this book you will see products highlighted with **LEAD FREE***. These are Watts products that comply with Lead Free laws in California, VT, MD, and LA. As well as Federal "Reduction of Lead in Drinking Water Act" requirements. For more information on our Lead Free products, please visit our Lead Free informational web site at WeAreLeadFree.net.

*The wetted surface of this product contacted by consumable water contains less than 0.25% of lead by weight.

Electronic is Green!

For the latest Watts pricing information in electronic format, visit our Data Exchange at:

www.wattswater.com/dataexchange

- Download product and list price data in .csv, .pdf, .tsv, .xls and .xml formats
- Easy access to list price data for business systems
- Sign up for e-mail alerts when data is updated
- Access other Watts Water Technologies brands pricing data

Table of Contents

Terms & Conditions	2
Technical Information	3-5
Features	6

TYPE	DESCRIPTION	PAGE
------	-------------	------

Series 10

Tees

Type 23	Tee - Union	7
Type 24R	Tee - Reducing	7

Elbows

Type 17	Elbow - Union	7
Type 17R	Elbow - Reducing Union	7
Type 18	Elbow - Stackable	7
Type 19	Elbow - Male	7

Connectors

Type 15	Connector - Union	8
Type 15R	Connector - Reducing Union	8
Type 10	Connector - Female	8
Type 01	Connector - Male	8

Stems

Type 14R	Stem - Reducing	9
Type 27	Stem - Male	9

Stops

Type 45	End Stop	9
---------	----------------	---

Valves

Type 39	Valve - Union Stop	9
Type 62	Valve - Male Stop	9
Type 53	Valve - Female Stop	9

Series 35 and 45

Tees

Type 23	Tee - Union	10
Type 24R	Tee - Reducing	10
Type 26	Tee - Double Reducing	11
Type 30	Tee - Male Thread	11
Type 31	Tee - Female Iron Pipe Thread	11
Type 33	Tee - Stackable	11
Type 33R	Tee - Reducing Stackable	11
Type 34	Tee - Stackable Branch	11

Elbows

Type 12	Elbow - Stackable Hose Barb	12
Type 17	Elbow - Union	12
Type 17R	Elbow - Reducing Union	12
Type 18	Elbow - Stackable	12
Type 21	Elbow - Drop Ear	13
Type 19	Elbow - Male	13
Type 20	Elbow - Female Swivel	13
Type 22	Elbow - Union 45°	13
Type 22S	Elbow - Stackable 45°	13

Connectors

Type 01	Connector - Male	14
Type 10	Connector - Female	14
Type 11	Connector - Stackable Hose Barb Union	15
Type 13	Connector - Hose Barb Union	15
Type 14	Connector - Reducing Stems	15
Type 15	Connector - Union	15
Type 15R	Connector - Reducing Union	16
Type 16	Connector - Slip Coupling	16

TYPE	DESCRIPTION	PAGE
------	-------------------	------

Connectors - cont.

Type 27	Connector - Male Stem	16
Type 28	Connector - Female Stem	16

End Stops

Type 45	End Stop	16-17
---------	----------------	-------

Pump Fittings

Type 75	Pump Fitting - Union Pump	17
Type 76	Pump Fitting - Elbow	17

Valves

Type 38	Valve - 3-Way Selector	17
Type 39	Valve - Stop	17
Type 39R	Valve - Reducing Stop	17
Type 40	Valve - Union Check	17
Type 41	Valve - 3-Way Bypass	17
Type 43	Valve - Stackable	18
Type 43R	Valve - Reducing Stackable	18
Type 50	Valve - Tee	18
Type 51	Valve - Threaded Tee	18
Type 52	Valve - Female In-Line	18
Type 53	Valve - Female Angle	18
Type 54	Valve - Female Angle	18
Type 55	Valve - In-Line	18
Type 56	Valve - Angle	18
Type 57	Valve - Male Angle	19
Type 58	Valve - Angle	19
Type 59	Valve - Panel Mount	19
Type 61	Valve - Adapter Stop	19

Miscellaneous

Type 47	Collet Clip	19
Type 159	O-Ring Assembly	19
Type 161	Cone Seal	19
Type 162	Pipe Inserts	20
Type 163	Collet Clip Covers	20

Manifolds

Type 89	Manifold Single Union Body	20
Type 90	Manifold Single Stem Body - Right	20
Type 91	Manifold Single Stem Body - Left	20
Type 81	Manifold Single Side Mounting Kit	20
Type 83	Manifold Dual Union Body	20
Type 84	Manifold Dual Stem Body	20
Type 80	Manifold Dual Side Mounting Kit	21

Manifold Accessories

Type 82	Manifold Divider Plug	21
Type 85	Manifold Return End	21
Type 86	Manifold Label Plate - Red	21
Type 87	Manifold Label Plate - Blue	21
Type 88	Manifold Valve Repair Kit	21
Type 80-MT	Manifold Tool	21
Type 14	Reducing Stems	21
Type 46	End Plugs	21
	Manifold Dimensions	22
	Manifold Elements	23
	Manifold Styles	24

Sizing Matrix

Example: 3575-10 = Series 35, Type 75, ½" CTS

¾ CTS = 08 OD	¼ OD = 04	1/8 NPT/S = 02	¾ Hose Barb = 06	CL ¾ = 13	7/16 UNS = 01
½ CTS = 10 OD	¾ OD = 06	¼ NPT/S = 04	½ Hose Barb = 08	FG ¾ = 14	
¾ CTS = 14 OD	½ OD = 08	¾ NPT/S = 06	¾ Hose Barb = 12	MG ¾ = 14	
1 CTS = 18 OD		½ NPT/S = 08		¾ BSP = 12	
		¾ NPT/S = 12			
		1 NPT/S = 16			

Terms and conditions

FREIGHT TERMS: All shipments are F.O.B. shipping point. Shipments from factory less than 1000 lbs. are F.O.B. factory. Factory shipments of \$2500 and over within the continental U.S.A. will be prepaid and allowed when made at the lowest motor carrier transportation rate.

TERMS OF SALE: All sales are F.O.B. shipping point.

PAYMENT TERMS: The invoices are due and payable 30 days from the date of invoice. A 2% cash discount allowed on net amount of invoice if paid on or before the 10th of the following month. Invoices dated on or after the 25th will be considered as dated the first of the next month. Postmark on envelope will be considered date of check.

PURCHASE ORDER FORMS: Orders submitted on customer's own purchase order forms will be accepted only with the express understanding that no statements, clauses, or conditions contained in said order form will be binding on the Seller if they in any way modify the Seller's own terms and conditions of sales.

SPECIAL PRODUCTS: Orders for special or modified products are non-cancelable.

LIMITED WARRANTY: A. Watts Regulator Co. ("Watts") warrants its WaterPEX® cross-linked polyethylene tubing, barbed PEX fittings, brass and plastic Quick-Connect fittings and manifolds, factory manufactured copper manifolds and Quick-Connect accessories to be free of defects in material and workmanship when used under normal usage in potable water systems, and installed in accordance with all Watts printed installation instructions. Specific warranty durations apply as follows:

1. Watts WaterPEX® cross-linked polyethylene (non-barrier PEX) pipe, brass and plastic barbed PEX fittings, and factory manufactured copper manifolds when installed as a system using Watts WaterPEX pipe, Watts brass or plastic barbed PEX fittings, and Watts factory manufactured copper manifolds for a period of twenty-five (25) years from the date of original shipment.
2. Watts WaterPEX® cross-linked polyethylene (non-barrier PEX) pipe, when installed with brass or plastic barbed PEX fittings manufactured by others that meet the applicable ASTM Standards (brass - ASTM F 1807) (plastic - ASTM F 2159) for a period of ten (10) years from the date of original shipment.
3. Watts WaterPEX® brass or plastic barbed PEX fittings and factory manufactured copper manifolds when installed with cross-linked polyethylene (non-barrier PEX) pipe manufactured by others that meet the ASTM F 876 requirements for a period of ten (10) years from the date of original shipment.
4. Series 10, 35, and 45/LF45 Quick-Connect fittings and manifolds for a period of twenty-five (25) years from the date of original shipment.
5. All other valves and accessories sold under the Watts WaterPEX or Watts Quick-Connect brand name for a period of two (2) years from the date of original shipment.

Watts's obligation will be to repair or replace, at its discretion, any of these products proven to be defective in material or workmanship when these products are covered under this limited warranty.

B. In the event of a system malfunction or leak caused by defective Watts warranted materials (and not by incorrect installation, incorrect handling procedures or by jobsite or installation damage), a reasonable pre-approved amount will be allowed for repair materials and repair labor. In the event of a leak occurring in a factory manifold, you may contact Watts for either a free replacement manifold or any parts reasonably needed to repair such a leak (freight prepaid). Note that Watts limits its warranty to its tubing, valves and accessories, fittings and manifolds. Watts does not warrant the connection on any installation, as the integrity of the connection is subject to the workmanship of the contractor/installer. The connection is the sole responsibility of the person who installs it.

C. In order to qualify for a warranty remedy under paragraph B, you must contact Watts in advance and receive a written authorization for this remedy from an authorized Watts representative. Repair materials, repair labor and freight expenses not authorized in writing in advance by Watts in this way will not be compensated.

D. To qualify for the warranty described above, you must do the following:

1. Use good construction techniques to install our materials, as specified in our current design and installation guidelines and technical notes. This must include field pressure testing our warranted materials before they are covered by concrete or otherwise made inaccessible.
2. Install Watts WaterPEX® and Watts Quick-Connect materials according to all guidelines and manuals published by Watts.
3. Install Watts WaterPEX® and Watts Quick-Connect products in a system that will not operate at temperatures or at pressures that exceed the rating printed on the tubing.
4. The Watts warranted product must be installed in compliance with local building and plumbing codes.
- E. Evidence of tampering, mishandling, neglect, accidental damage, freeze damage or unauthorized repairs that cause damage to Watts's warranted products will void any warranty coverage for those particular products. All field connections are specifically excluded from the terms of this warranty.
- F. Watts provides a complete plumbing system offering so that it is possible to complete an installation with Watts products. However, it is possible that other manufacturers' tubing and/or fittings may be installed in any given installation. Providing that the tubing and/or fittings are manufactured to their applicable ASTM standards, and have been certified by a recognized third-party testing agency, the Watts product in the given installation will continue to be covered under this warranty. In the event of a system malfunction or leak that has other tubing and/or fitting manufacturers' components installed within the failed system, Watts will be responsible only for proven defects in material or workmanship in the Watts products. Products manufactured by another company should be reported to that manufacturer for its warranty response.

G. Disclaimer of Warranty. **THE WARRANTY SET FORTH HEREIN IS GIVEN EXPRESSLY AND IS THE ONLY WARRANTY GIVEN BY WATTS WITH RESPECT TO THE PRODUCTS LISTED IN PARAGRAPH A. WATTS MAKES NO OTHER WARRANTIES, EXPRESS OR IMPLIED. WATTS HEREBY SPECIFICALLY DISCLAIMS ALL OTHER WARRANTIES, EXPRESS OR IMPLIED, INCLUDING BUT NOT LIMITED TO THE IMPLIED WARRANTIES OF MERCHANTABILITY AND FITNESS FOR A PARTICULAR PURPOSE.**

H. Limitation of Liability. The remedy described above shall constitute the sole and exclusive remedy for breach of warranty, and, apart from that remedy, Watts shall not be responsible for any incidental, special or consequential damages, including without limitation, lost profits or the cost of repairing or replacing other property which is damaged if these warranted products do not work properly, other costs resulting from labor charges, delays, vandalism, negligence, fouling caused by foreign material, damage from adverse water conditions, adverse chemical environments, or any other circumstances over which Watts has no control. This warranty shall be invalidated by any abuse, misuse, misapplication or improper installation of the product. Some states do not allow limitations on how long an implied warranty lasts, and some states do not allow the exclusion or limitation of incidental or consequential damages. Therefore the above limitations may not apply to you. This Limited Warranty gives you specific legal rights, and you may have other rights that vary from state to state. You should consult applicable state laws to determine your rights. **SO FAR AS IS CONSISTENT WITH APPLICABLE STATE LAW, ANY IMPLIED WARRANTIES THAT MAY NOT BE DISCLAIMED, INCLUDING THE IMPLIED WARRANTIES OF MERCHANTABILITY AND FITNESS FOR A PARTICULAR PURPOSE, ARE LIMITED IN DURATION TO ONE YEAR FROM THE DATE OF ORIGINAL SHIPMENT.**

I. RETURNED GOODS – CREDIT: No material shall be returned without authorization. When credit is issued, it will be at the price originally invoiced, less handling charges, based on the costs of reconditioning, boxing, etc. Products which are obsolete or made to special order are not returnable.

NOTE: Prices and terms are subject to change without notice and supersede all previous quotations. The right is reserved to change or modify product design or construction without prior notice and without incurring an obligation to make such changes and modifications on products previously or subsequently sold.

Material Specifications

Body:	Polypropylene
Collet:	Acetal
O-Ring:	EPDM
Spacer:	Acetal
Collet Cover:	Acetal

Fitting Performance

Series 10	Max.	150psi @ 70°F	(10.3 bar @ 20°C)
	Max.	60psi @ 140°F	(4.1 bar @ 60°C)
	Min.	33°F @ 0.5°C	

Thread Torque Values

Size	Max. Torque Values
1/8", 1/4" (3.8mm)	13.3 in - lbs. (1.5 Nm)
3/8", 1/2" (10, 15mm)	26.6 in - lbs. (3.0 Nm)

Approvals



FDA: Watts Series 10 fittings are produced from FDA approved materials.



ANSI/NSF-61: Watts Series 10 products are tested, certified, and approved for contact with drinking water.

Watts Quick-Connect fittings are designed for low pressure fluids. For other applications please refer to our Technical Service Department. Tubing should be supported at minimum of 36" to prevent excessive load to the connectors. Do not install tubing supports closer than 3 inches from the connector ends. We strongly recommend that new installations be thoroughly tested prior to use. Do not use with explosive gases, petroleum products, or other fuels.

Watts Quick-Connect Series 10 products are designed and manufactured to be trouble free for many years of service life. Series 10 products are designed and manufactured in polypropylene, a high performance thermal plastic material. All Series 10 products are approved and certified to NSF-61. Series 10 products are available in standard imperial inch sizes. The Watts Quick-Connect design allows for quick and easy connections without installation tools. Simply cut the plastic, copper, CPVC or polybutylene piping and snap a Watts Quick-Connect fitting in place for a zero leak connection.

Caution: The polypropylene material used in the Quick-Connect fittings can be compromised by exposure to volatile organic compounds (VOC's) and caustic chemicals. Therefore, **DO NOT** expose this product to any such chemical or foreign substance, which would include exposure to the following products: **Pipe Dopes (thread sealants)**, bug sprays, lubricants, cleaners, paints, bleaches, acids, solder fluxes, plastic piping primers and cements, oxidizing agents, alkaline solutions, thinners, fuels, oil based caulks, hydrocarbons, spray foam of foaming agents (insulation).



Watts recommends that all fittings and parts be stored in their original packaging until installation to protect the fitting internals from dirt and debris that may cause damage to the o-ring and the o-ring guide.

It is also recommended that all threaded connections be made with Teflon® tape only.

Failure to follow these instructions will void the warranty and possibly result in leaks and water damage.

Material Specifications

Body:	Polysulfone
Collet:	Nylon
O-Ring:	EPDM
Spacer:	Acetal
Collet Cover:	Acetal
Tube Insert:	Polysulfone

Fitting Performance

35 Series	100psi @ 180°F 6.8 bar @ 82°C	250psi @ 75°F 17.25 bar @ 24°C
-----------	----------------------------------	-----------------------------------

Thread Torque Values

Size	Min. Torque Values	Max. Torque Values
1/2"	17.7 in - lbs.	26.5 in - lbs.
3/4"	22.7 in - lbs.	31 in - lbs.

Approvals



FDA: Watts Series 35 fittings are produced from FDA approved materials.



ANSI/NSF-61: Watts Series 35 products are tested, certified, and approved for contact with drinking water.



ANSI/NSF-14: Watts Series 35 products are tested, certified, and approved to NSF-14 standards.



CSA B137.5: Watts Series 35 products are tested, certified, and approved to Canadian standard CSA B137.5.



ASTM F877: Watts Series 35 products are tested, certified, and approved to ASTM F877 performance standards.



NSF-U.P.: Watts Series 35 products are tested, certified, and approved and meet the requirements of the Uniform Plumbing Code.



IAPMO ASSE 1061-2006: Watts Series 35 fittings are tested, certified and approved to ASSE 1061-2006 for Quick-Connect fittings.

Watts Quick-Connect 35 Series products are designed and manufactured to be trouble free for many years of service life. 35 Series products are designed and manufactured in polysulfone, a high performance thermal plastic material. All 35 Series products are approved and certified to NSF-61, NSF-14, CSA B137.5, ASTM F877, and to the Uniform Plumbing Code (U.P. Code) and ASSE 1061-2006. 35 Series products are available in standard imperial inch sizes. The Watts Quick-Connect design allows for quick and easy connections without installation tools. Simply cut the plastic, copper, CPVC or polybutylene piping and snap a Watts Quick-Connect fitting in place for a zero leak connection.

Caution: The polysulfone material used in the Quick-Connect fittings can be compromised by exposure to volatile organic compounds (VOC's) and caustic chemicals. Therefore, **DO NOT** expose this product to any such chemical or foreign substance, which would include exposure to the following products: **Pipe Dopes**



(thread sealants), bug sprays, lubricants, cleaners, paints, bleaches, acids, solder fluxes, plastic piping primers and cements, oxidizing agents, alkaline solutions, thinners, fuels, oil based caulks, hydrocarbons, spray foam of foaming agents (insulation).

Watts recommends that all fittings and parts be stored in their original packaging until installation to protect the fitting internals from dirt and debris that may cause damage to the o-ring and the o-ring guide.

It is also recommended that all threaded connections be made with Teflon® tape only.

Failure to follow these instructions will void the warranty and possibly result in leaks and water damage.

Watts Quick-Connect fittings are designed for low pressure fluids. For other applications please refer to our Technical Service Department. Tubing should be supported at minimum of 36" to prevent excessive load to the connectors. Do not install tubing supports closer than 3 inches from the connector ends. We strongly recommend that new installations be thoroughly tested prior to use. Do not use with explosive gases, petroleum products, or other fuels.

Material Specifications

Body:	Brass UNS C36500 ASTM B283
LF45 Series Body:	Lead Free* Brass Alloy
Collet:	Nylon
O-Ring:	EPDM
Spacer:	Acetal
Collet Cover:	Acetal
Tube Insert:	Polysulfone

Fitting Performance

45/LF45 Series	250psi @ 75°F	(17.25 bar @ 24°C)
	80psi @ 240°F	(5.15 bar @ 115.5°C)

Approvals



ANSI/NSF-61: Watts Series 45/LF45 Quick-Connect fittings are tested, certified and approved for contact with drinking water.



ANSI/NSF-14: Watts Series 45/LF45 Quick-Connect fittings are tested, certified and approved to NSF-14 standards.



CSA B137.5: Watts Series 45/LF45 Quick-Connect fittings are tested, certified and approved to Canadian standard CSA B137.5.



ASTM F877: Watts Series 45/LF45 Quick-Connect fittings are tested, certified and approved to ASTM F877 performance standards.



IAPMO ASSE 1061-2006: Watts Series 45/LF45 Quick-Connect fittings are tested, certified and approved to ASSE 1061.

Watts Quick-Connect fittings are designed for low pressure fluids. For other applications please refer to our Technical Service Department. Tubing should be supported at minimum of 36" to prevent excessive load to the connectors. Do not install tubing supports closer than 3 inches from the connector ends. We strongly recommend that new installations be thoroughly tested prior to use. Do not use with explosive gases, petroleum products, or other fuels.

*The wetted surface of this product contacted by consumable water contains less than 0.25% of lead by weight.

Watts Series 45/LF45 Quick-Connect fittings are designed and manufactured to be trouble free for many years of service. All Series 45/LF45 fittings incorporate a heavy duty brass body and the proven collet and O-ring design. All Series 45/LF45 fittings are tested, approved and certified to NSF-61, NSF-14, CSA B137.5, ASTM F877 and ASSE 1061. Series 45/LF45 fittings are available in standard imperial inch sizes. The unique design of Series 45/LF45 fittings allows for quick and easy connections without installation tools.

Caution: The polysulfone material used in the Quick-Connect fittings can be compromised by exposure to volatile organic compounds (VOC's) and caustic chemicals. Therefore, **DO NOT** expose this product to any such chemical or foreign substance, which would include exposure to the following products: **Pipe Dopes (thread sealants)**, bug sprays, lubricants, cleaners, paints, bleaches, acids, solder fluxes, plastic piping primers and cements, oxidizing agents, alkaline solutions, thinners, fuels, oil based caulks, hydrocarbons, spray foam or foaming agents (insulation).



Watts recommends that all fittings and parts be stored in their original packaging until installation to protect the fitting internals from dirt and debris that may cause damage to the o-ring and the o-ring guide.

It is also recommended that all threaded connections be made with Teflon® tape only.

Failure to follow these instructions will void the warranty and possibly result in leaks and water damage.

All Series 45/LF45 Fittings come complete with a removable collet cover to prevent accidental release of the fitting prior to pressurization. To remove this cover, gently pry off, and push back onto the pipe.

Features

Making A Connection



1 Cut the pipe or tubing squarely using a sharp tubing cutter (plastic) or rotary copper pipe cutter (copper). Inspect the outside diameter of the pipe or tubing to be sure there is no damage, nicks, burrs, or debris. Deburr and clean pipe or tubing as necessary.

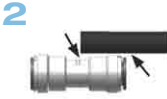

2 Measure the insertion depth on the pipe or tubing end. 35 Series fittings have an insertion line molded into the body of the fitting. For 45 Series fittings, use the Insertion Depth Guide provided with the fitting.



3 For PEX Pipe, gently insert a pipe stiffener (provided for each connection with fitting) into the pipe end.*

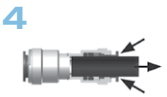

4 Make certain to push the tubing completely into the fitting until it comes into contact with the internal tube stop.

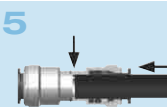

5 To disconnect, ensure system has been depressurized before removing fitting. Gently pry off collet cover and push back away from fitting, exposing the collet. Push the collet in squarely against the face of the fitting. With the collet held securely in this position, the tubing can be removed.

O-Ring Guide

All Watts Quick-Connect fittings incorporate an exclusive O-ring Guide for improved reliability. This unique feature insures zero-leak connections by:

- Protecting the O-ring from damage during connection
- Increasing the connectors' side load capacity
- Correctly aligning the tubing with the O-ring every time.
- Prevents the O-ring from becoming dislodged.

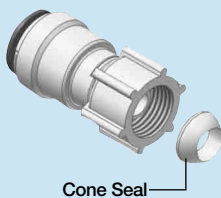
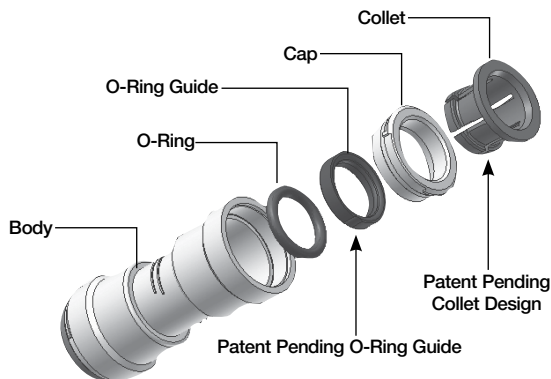

Watts Quick-Connect fittings utilize a swivel nut with NPS straight threads and a cone seal. This allows the installer to thread onto NPT, NPS, BSP, and most threads without tools or thread sealant. Simply thread on, hand tight, for a zero leak seal.

Connect to Multiple Materials

The Watts Quick-Connect fittings incorporate Stainless Steel Gripping Teeth in its Collet. These corrosion resistant teeth allow Quick-Connect fittings to interconnect with multiple materials without the need for special tools, or tube inserts.

- PEX, LDPE, MDPE, & HDPE Tubings
- Copper
- CPVC
- Polybutylene

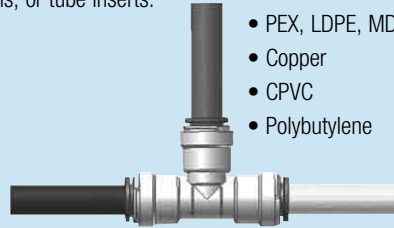

Rotates under pressure

After a joint is made the tubing can still swivel while connected, even under maximum pressure. The ability to rotate under pressure makes these connectors ideal for vibrating and dynamic applications.



Highest Flow

Watts Quick-Connect fittings join the tubing on the outside. Because there is no barb fitting on the inside of the tubing the flow capacity is increased by more than 30%. Only Quick-Connect fittings offer complete flow, allowing for a more efficient system.



Create mini-manifolds

With Quick-Connect fittings small lengths of tubing can be eliminated by using our stackable connector configurations. Simply snap together Tees and/or Elbows to create a mini-manifold of fittings. Because Quick-Connect fittings rotate the direction of the tubing can be oriented by a simple twist, reducing the amount of tubing required to plumb a water system.



* To comply with ASSE 1061, a tube stiffener (provided) must be used on all PEX pipe connections Series 35 and 45 only.

Series 10



1023-04



1024R-060604

Model	Ordering Code	Size & Connection	UPC	Ind. Bag	Inner Ctn	Mstr Ctn	Unit Weight (lbs)	List Price
-------	---------------	-------------------	-----	----------	-----------	----------	-------------------	------------

Series 10 Tees

Type 23 Union Tee

LEAD FREE*	1023B-04	0666115	1/4" OD	098268426502	10	20	200	.15	\$18.75
	1023B-06	0666116	3/8" OD	098268426519	10	10	100	.30	\$22.75
	1023B-08	0666117	1/2" OD	098268426526	10	6	60	.45	\$28.50

Type 24R Reducing Tee

LEAD FREE*	1024RB-060604	0666118	3/8" OD x 3/8" OD x 1/4" OD	098268426533	10	10	100	.30	\$24.25
	1024RB-080806	0666119	1/2" OD x 1/2" OD x 3/8" OD	098268426540	10	5	50	.50	\$31.75



1017-04



1017RB-0604

Series 10 Elbows

Type 17 Union Elbow

LEAD FREE*	1017B-04	0666120	1/4" OD	098268426557	10	30	300	.10	\$14.75
	1017B-06	0666121	3/8" OD	098268426564	10	10	100	.20	\$22.50
	1017B-08	0666122	1/2" OD	098268426571	10	10	100	.30	\$36.50

Type 17R Reducing Union Elbow

LEAD FREE*	1017RB-0604	0666146	3/8" OD x 1/4" OD	098268426816	10	20	200	.10	\$25.00
------------	-------------	---------	-------------------	--------------	----	----	-----	-----	---------

Type 18 Stackable Elbow

LEAD FREE*	1018B-04	0666142	1/4" OD	098268426779	10	25	250	.15	\$18.00
	1018B-06	0666143	3/8" OD	098268426786	10	10	100	.25	\$22.50
	1018B-08	0666144	1/2" OD	098268426793	10	8	80	.40	\$27.50



1018-06



1019-0402

Type 19 Male Elbow

LEAD FREE*	1019B-0402	0666135	1/4" OD x 1/8" NPTF	098268426700	10	30	300	.10	\$13.25
	1019B-0404	0666136	1/4" OD x 1/4" NPTF	098268426717	10	30	300	.05	\$15.00
	1019B-0406	0666137	1/4" OD x 3/8" NPTF	098268426724	10	20	200	.20	\$17.75
	1019B-0604	0666138	3/8" OD x 1/4" NPTF	098268426731	10	10	100	.15	\$19.75
	1019B-0606	0666139	3/8" OD x 3/8" NPTF	098268426748	10	20	200	.15	\$20.50
	1019B-0806	0666140	1/2" OD x 3/8" NPTF	098268426755	10	10	100	.25	\$25.75
	1019B-0808	0666141	1/2" OD x 1/2" NPTF	098268426762	10	10	100	.15	\$26.50

*The wetted surface of this product contacted by consumable water contains less than 0.25% of lead by weight.

Series 10

Model	Ordering Code	Size & Connection	UPC	Ind. Bag	Inner Ctn	Mstr Ctn	Unit Weight (lbs)	List Price
-------	---------------	-------------------	-----	----------	-----------	----------	-------------------	------------

Series 10 Connectors

Type 15 Union Connector

LEAD FREE	1015B-04	0666110	¼" OD	098268426458	10	30	300	.10	\$13.00
	1015B-06	0666111	¾" OD	098268426465	10	10	100	.20	\$17.50
	1015B-08	0666112	½" OD	098268426472	10	10	100	.30	\$20.50

Type 15R Reducing Union

LEAD FREE	1015RB-0604	0666113	¾" OD x ¼" OD	098268426489	10	20	200	.15	\$17.75
	1015RB-0806	0666114	½" OD x ¾" OD	098268426496	10	8	80	.35	\$24.25

Type 10 Female Connector

LEAD FREE	1010B-0401	0666147	¼" OD x ⅞" UNS	098268426823	10	20	200	.20	\$19.25
	1010B-0601	0666148	¾" OD x ⅞" UNS	098268426830	10	20	200	.18	\$20.00
	1010B-0404	0666123	¼" OD x ¼" NPTF	098268426588	10	20	200	.15	\$29.75
	1010B-0604	0666124	¾" OD x ¼" NPTF	098268426595	10	20	200	.15	\$30.75

Type 01 Male Connector

LEAD FREE	1001B-0402	0666125	¼" OD x ⅞" NPTM	098268426601	10	30	300	.05	\$8.50
	1001B-0404	0666126	¼" OD x ¼" NPTM	098268426618	10	30	300	.10	\$9.75
	1001B-0406	0666127	¼" OD x ¾" NPTM	098268426625	10	30	300	.10	\$13.25
	1001B-0408	0666128	¼" OD x ½" NPTM	098268426632	10	25	250	.15	\$17.00
	1001B-0602	0666129	¾" OD x ⅞" NPTM	098268426649	10	25	250	.15	\$17.00
	1001B-0604	0666130	¾" OD x ¼" NPTM	098268426656	10	20	200	.15	\$14.50
	1001B-0606	0666131	¾" OD x ¾" NPTM	098268426663	10	20	200	.15	\$16.75
	1001B-0608	0666132	¾" OD x ½" NPTM	098268426670	10	20	200	.15	\$26.00
	1001B-0806	0666133	½" OD x ¾" NPTM	098268426687	10	15	150	.20	\$22.50
	1001B-0808	0666134	½" OD x ½" NPTM	098268426694	10	15	150	.15	\$24.25



1015-06



1015R-0604



1010B-0604



1001B-0402

*The wetted surface of this product contacted by consumable water contains less than 0.25% of lead by weight.

Series 10



1014R-0604

LEAD FREE*

Model	Ordering Code	Size & Connection	UPC	Ind. Bag	Inner Ctn	Mstr Ctn	Unit Weight (lbs)	List Price
-------	---------------	-------------------	-----	----------	-----------	----------	-------------------	------------

Series 10 Stems

Type 14R Reducing Stem

1014RB-0604	0666145	3/8" OD x 1/4" OD	098268426809	10	30	300	.05	\$14.50
-------------	---------	-------------------	--------------	----	----	-----	-----	---------

Type 27 Male Stem

1027B-0402	0666104	1/4" OD x 1/8" NPTM	098268426397	10	30	300	.10	\$11.75
1027B-0404	0666105	1/4" OD x 1/4" NPTM	098268426403	10	30	300	.10	\$11.00
1027B-0604	0666106	3/8" OD x 1/4" NPTM	098268426410	10	10	100	.20	\$12.25
1027B-0606	0666107	3/8" OD x 3/8" NPTM	098268426427	10	10	100	.20	\$12.00
1027B-0806	0666108	1/2" OD x 3/8" NPTM	098268426434	10	10	100	.20	\$13.50



1027-0606

LEAD FREE*



1045-04

LEAD FREE*

Series 10 Stops

Type 45 End Stop

1045B-04	0666109	1/4" OD	098268426441	10	50	500	.05	\$20.25
----------	---------	---------	--------------	----	----	-----	-----	---------



1039

LEAD FREE*

Series 10 Valves

Type 39 Union Stop Valve

1039B-04	0666102	1/4" OD	098268426373	10	8	80	.45	\$42.25
1039B-06	0666103	3/8" OD	098268426380	10	6	60	.55	\$44.75



1062

LEAD FREE*

Type 62 Male Stop Valve

1062B-04	0666100	1/4" OD x 1/4" NPTM	098268426359	10	8	80	.45	\$42.25
1062B-06	0666101	3/8" OD x 3/8" NPTM	098268426366	10	6	60	.55	\$44.75



1053-0604

LEAD FREE*

Type 53 Female Angle Valve

1053B-0404	0666149	1/4" OD x 1/4" NPTF	098268426847	10	8	80	.45	\$46.50
1053B-0604	0666150	3/8" OD x 1/4" NPTF	098268427134	10	6	60	.50	\$48.50

*The wetted surface of this product contacted by consumable water contains less than 0.25% of lead by weight.

Series 35 and 45/LF45 Tees

Model	Ordering Code	Size & Connection	UPC	Ind. Bag	Inner Ctn	Mstr Ctn	Unit Weight (lbs)	List Price
-------	---------------	-------------------	-----	----------	-----------	----------	-------------------	------------

Type 23 Union Tees

Package Type: Poly Bag

LEAD FREE*	3523B-08	0650007	3/8" x 3/8" x 3/8" CTS	098268303315	1	24	120	0.08	\$5.25
	3523B-10	0650008	1/2" x 1/2" x 1/2" CTS	098268303322	1	24	120	0.13	\$5.50
	3523B-14	0650009	3/4" x 3/4" x 3/4" CTS	098268303339	1	8	40	0.22	\$9.25
	3523B-18	0651176	1" x 1" x 1" CTS	098268353174	1	8	40	0.22	\$11.50
	4523B-10	0651147	1/2" x 1/2" x 1/2" CTS	098268340785	1	12	120	0.35	\$10.50
LEAD FREE*	4523B-14	0651148	3/4" x 3/4" x 3/4" CTS	098268340792	1	12	120	0.65	\$12.25
	4523B-18	0651149	1" x 1" x 1" CTS	098268340808	1	6	60	0.95	\$19.50
	LF4523B-10	0652027	1/2" x 1/2" x 1/2" CTS	098268436822	1	12	120	0.44	\$12.75
	LF4523B-14	0652028	3/4" x 3/4" x 3/4" CTS	098268436839	1	12	120	0.68	\$14.75
	LF4523B-18	0652029	1" x 1" x 1" CTS	098268436846	1	6	60	0.94	\$23.50



3523



LF4523



Type 24R Reducing Tees

Package Type: Poly Bag

LEAD FREE*	3524RB-101004	0650033	1/2" x 1/2" x 1/4" OD	098268303742	1	24	120	0.10	\$12.25
	3524RB-141410	0650034	3/4" x 3/4" x 1/2" CTS	098268303759	1	8	40	0.15	\$8.25
	3524RB-181814	0651177	1" x 1" x 3/4" CTS	098268353181	1	8	40	0.20	\$9.75
	4524RB-141410	0651150	3/4" x 3/4" x 1/2" CTS	098268340815	1	12	120	0.70	\$11.75
	4524RB-181814	0651151	1" x 1" x 3/4" CTS	098268340822	1	6	60	0.95	\$20.75
LEAD FREE*	4524RB-141014	0651152	3/4" x 1/2" x 3/4" CTS	098268340631	1	12	120	0.65	\$12.00
	4524RB-181418	0651153	1" x 3/4" x 1" CTS	098268340648	1	6	60	1.00	\$21.75
	LF4524RB-141410	0652030	3/4" x 3/4" x 1/2" CTS	098268436853	1	12	120	0.64	\$14.25
	LF4524RB-181814	0652031	1" x 1" x 3/4" CTS	098268436860	1	6	60	0.98	\$25.00
	LF4524RB-141014	0652032	3/4" x 1/2" x 3/4" CTS	098268436877	1	12	120	0.63	\$14.50
LEAD FREE*	LF4524RB-181418	0652033	1" x 3/4" x 1" CTS	098268436884	1	6	60	0.96	\$26.25



3524R



LF4524R



Tee Sizing

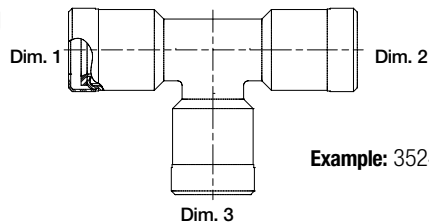

Example: 3524RB-141410 = Dim.1 (3/4") Dim. 2 (3/4") Dim. 3 (1/2")

*The wetted surface of this product contacted by consumable water contains less than 0.25% of lead by weight.

Series 35 and 45/LF45 Tees

Model	Ordering Code	Size & Connection	UPC	Ind. Bag	Inner Ctn	Mstr Ctn	Unit Weight (lbs)	List Price
-------	---------------	-------------------	-----	----------	-----------	----------	-------------------	------------



3526



LF4526



Type 26 Double Reducing Tees

Package Type: Poly Bag

LEAD FREE*	3526B-141010	0650949	3/4" x 1/2" x 1/2" CTS	098268320800	1	14	140	0.16	\$7.75
	4526RB-141010	0651154	3/4" x 1/2" x 1/2" CTS	098268340655	1	12	120	0.65	\$11.00
	4526RB-181414	0651155	1" x 3/4" x 3/4" CTS	098268340662	1	6	60	1.00	\$21.25
LEAD FREE*	LF4526RB-141010	0652034	3/4" x 1/2" x 1/2" CTS	098268436891	1	12	120	0.74	\$13.25
	LF4526RB-181414	0652035	1" x 3/4" x 3/4" CTS	098268436907	1	6	60	1.0	\$25.50

Type 30 Male Thread Tees

Package Type: Poly Bag



3530

LEAD FREE*	3530B-1008	0650028	1/2" x 1/2" x 1/2" NPT	098268303698	1	24	120	0.05	\$4.50
------------	------------	---------	------------------------	--------------	---	----	-----	------	--------

Type 31 Female Iron Pipe Thread Tees

Package Type: Poly Bag



4531B

	4531B-141614	0651250	3/4" x 3/4" x 1" FIP	098268447873	1	12	120	0.71	\$26.50
	4531B-181618	0651251	1" x 1" x 1" FIP	098268447880	1	6	60	0.94	\$35.00

Type 33 Stackable Tees

Package Type: Poly Bag



3533

LEAD FREE*	3533B-08	0650018	3/8" x 3/8" x 3/8" CTS	098268303445	1	24	120	0.05	\$4.25
	3533B-10	0650019	1/2" x 1/2" x 1/2" CTS	098268303452	1	16	80	0.05	\$4.75
	3533B-14	0650020	3/4" x 3/4" x 3/4" CTS	098268303469	1	8	40	0.15	\$7.25
	3533B-18	0651178	1" x 1" x 1" CTS	098268353013	1	8	40	0.20	\$9.00

Type 33R Reducing Stackable Tees

Package Type: Poly Bag



3533R

LEAD FREE*	3533RB-1004	0650026	1/2" CTS x 1/4" CTS	098268303674	1	16	80	0.11	\$10.25
	3533RB-1410	0650702	3/4" CTS x 1/2" CTS	098268309003	1	8	40	0.19	\$9.25

Type 34 Stackable Branch Tees

Package Type: Poly Bag



3534

LEAD FREE*	3534B-10	0650024	1/2" x 1/2" x 1/2" CTS	098268303636	1	24	120	0.05	\$5.75
------------	----------	---------	------------------------	--------------	---	----	-----	------	--------

*The wetted surface of this product contacted by consumable water contains less than 0.25% of lead by weight.

Series 35 and 45/LF45 Elbows



3512

LEAD FREE

Type 12 Stackable Hose Barb Elbows

Package Type: Poly Bag

Model	Ordering Code	Size & Connection	UPC	Ind. Bag	Inner Ctn	Mstr Ctn	Unit Weight (lbs)	List Price
3512B-1008	0650229	1/2" CTS x 1/2" Barb	098268307214	1	24	120	0.05	\$1.80



3517



LF4517



Type 17 Union Elbows

Package Type: Poly Bag

LEAD FREE	3517B-08	0650046	3/8" CTS	098268304633	1	24	120	0.05	\$5.25
	3517B-10	0650047	1/2" CTS	098268304640	1	24	120	0.05	\$6.00
	3517B-14	0650048	3/4" CTS	098268304657	1	16	80	0.10	\$9.25
	3517B-18	0650951	1" CTS	098268320824	1	10	100	0.24	\$10.50
	4517B-10	0651131	1/2" CTS	098268341089	1	12	120	0.30	\$7.50
LEAD FREE	4517B-14	0651132	3/4" CTS	098268341096	1	12	120	0.50	\$9.25
	4517B-18	0651133	1" CTS	098268340976	1	6	60	0.80	\$16.25
	LF4517B-10	0652011	1/2" CTS	098268436655	1	12	120	0.30	\$9.00
	LF4517B-14	0652012	3/4" CTS	098268436662	1	12	120	0.50	\$11.25
	LF4517B-18	0652013	1" CTS	098268436679	1	6	60	0.80	\$19.50



LF4517R



Type 17R Reducing Union Elbow

Package Type: Poly Bag

LEAD FREE	4517RB-1410	0651134	3/4" x 1/2" CTS	098268340983	1	12	120	0.45	\$9.00
	4517RB-1814	0651135	1" x 3/4" CTS	098268340990	1	6	60	0.65	\$15.75
	LF4517RB-1410	0652014	3/4" x 1/2" CTS	098268436686	1	12	120	0.43	\$11.00
	LF4517RB-1814	0652015	1" x 3/4" CTS	098268436693	1	6	60	0.69	\$19.00

Type 18 Stackable Elbows

Package Type: Poly Bag



3518



LF4518



LEAD FREE	3518B-08	0650058	3/8" CTS x 3/8" OD	098268304787	1	24	120	0.05	\$3.25
	3518B-10	0650059	1/2" CTS x 1/2" OD	098268304800	1	24	120	0.05	\$3.75
	3518B-14	0650060	3/4" CTS x 3/4" OD	098268304817	1	16	80	0.10	\$5.00
	3518B-18	0651174	1" CTS x 1" OD	098268353150	1	16	80	0.15	\$6.50
	4518B-10	0651136	1/2" CTS x 1/2" OD	098268341003	1	12	120	0.30	\$7.25
LEAD FREE	4518B-14	0651137	3/4" CTS x 3/4" OD	098268341010	1	12	120	0.55	\$10.25
	4518B-18	0651138	1" CTS x 1" OD	098268341027	1	6	60	0.70	\$15.50
	LF4518B-10	0652016	1/2" CTS x 1/2" OD	098268436709	1	12	120	0.29	\$8.75
	LF4518B-14	0652017	3/4" CTS x 3/4" OD	098268436716	1	12	120	0.57	\$12.50
	LF4518B-18	0652018	1" CTS x 1" OD	098268436723	1	6	60	0.72	\$18.75

*The wetted surface of this product contacted by consumable water contains less than 0.25% of lead by weight.

Series 35 and 45/LF45 Elbows

Model	Ordering Code	Size & Connection	UPC	Ind. Bag	Inner Ctn	Mstr Ctn	Unit Weight (lbs)	List Price
-------	---------------	-------------------	-----	----------	-----------	----------	-------------------	------------

Type 21 Drop Ear Elbows

Package Type: Poly Bag



LEAD FREE*



LEAD FREE*



3521B-1008	0650065	1/2" CTS x 1/2" NPT	098268304879	1	8	40	0.10	\$5.50
4521B-1008	0651145	1/2" CTS x 1/2" FPT	098268340761	1	6	60	0.35	\$6.75
4521B-1412	0651146	3/4" CTS x 3/4" FPT	098268340778	1	6	60	0.58	\$13.25
LF4521B-1008	0652025	1/2" CTS x 1/2" FPT	098268436808	1	6	60	0.37	\$8.25

Type 19 Male Elbows

Package Type: Poly Bag



3519B-1006	0650160	1/2" CTS x 3/8" NPT	098268306248	1	24	120	0.07	\$4.25
3519B-1008	0650161	1/2" CTS x 1/2" NPT	098268306255	1	24	120	0.07	\$3.75
3519B-1816	0651175	1" CTS x 1" NPT	098268353167	1	16	80	0.15	\$6.50

Type 20 Female Swivel Elbows

Package Type: Poly Bag



LEAD FREE*

3520B-0808	0650130	3/8" CTS x 1/2" NPS	098268305920	1	24	120	0.07	\$4.50
3520B-0813	0650131	3/8" CTS x 3/4" Closet	098268305937	1	24	120	0.05	\$7.00
3520B-1008	0650132	1/2" CTS x 1/2" NPS	098268305944	1	24	120	0.05	\$5.00
3520B-1012	0650133	1/2" CTS x 3/4" NPS	098268305951	1	24	120	0.12	\$6.25
3520B-1013	0650134	1/2" CTS x 3/4" Closet	098268305975	1	24	120	0.05	\$4.25
3520B-1014	0650135	1/2" CTS x 3/4" FGHT	098268305982	1	24	120	0.05	\$8.00

Type 22 Union Elbow 45°

Package Type: Poly Bag



LEAD FREE*

4522B-10	0651139	1/2" CTS 45°	098268341034	1	12	120	0.25	\$7.50
4522B-14	0651140	3/4" CTS 45°	098268340839	1	12	120	0.40	\$10.50
4522B-18	0651141	1" CTS 45°	098268340846	1	6	60	0.60	\$15.50
LF4522B-10	0652019	1/2" CTS 45°	098268436730	1	12	120	0.22	\$9.00
LF4522B-14	0652020	3/4" CTS 45°	098268436754	1	12	120	0.43	\$12.75
LF4522B-18	0652021	1" CTS 45°	098268436761	1	6	60	0.58	\$18.75

Type 22S Stackable Elbow 45°

Package Type: Poly Bag



4522SB-10	0651142	1/2" CTS x 1/2" OD 45°	098268340853	1	12	120	0.20	\$7.00
4522SB-14	0651143	3/4" CTS x 3/4" OD 45°	098268340747	1	12	120	0.45	\$9.50
4522SB-18	0651144	1" CTS x 1" OD 45°	098268340754	1	6	60	0.55	\$13.25

*The wetted surface of this product contacted by consumable water contains less than 0.25% of lead by weight.

Series 35 and 45/LF Connectors

Model	Ordering Code	Size & Connection	UPC	Ind. Bag	Inner Ctn	Mstr Ctn	Unit Weight (lbs)	List Price
-------	---------------	-------------------	-----	----------	-----------	----------	-------------------	------------

Type 01 Male Connectors

Package Type: Poly Bag

LEAD FREE*	3501B-0806	0650952	3/8" CTS x 3/8" MPT	098268320831	1	15	150	0.04	\$2.75
	3501B-1006	0650953	1/2" CTS x 3/8" MPT	098268320848	1	15	150	0.02	\$3.25
	3501B-0808	0650174	3/8" CTS x 1/2" MPT	098268306392	1	24	120	0.10	\$3.15
	3501B-1008	0650175	1/2" CTS x 1/2" MPT	098268306408	1	24	120	0.05	\$3.50
	3501B-1012	0650176	1/2" CTS x 3/4" MPT	098268306415	1	24	120	0.05	\$4.00
	3501B-1014	0650177	1/2" CTS x 3/4" MGHT	098268306422	1	24	120	0.07	\$4.25
	3501B-1412	0650178	3/4" CTS x 3/4" MPT	098268306439	1	24	120	0.05	\$4.75
	3501B-1816	0650983	1" CTS x 1" MPT	098268334890	1	24	120	0.50	\$5.00
	4501B-1008	0651128	1/2" CTS x 1/2" MPT	098268341058	1	12	120	0.25	\$5.50
	4501B-1412	0651129	3/4" CTS x 3/4" MPT	098268341065	1	12	120	0.35	\$6.50
LEAD FREE*	4501B-1812	0651190	1" CTS x 3/4" MPT	098268357516	1	6	60	0.30	\$9.25
	4501B-1816	0651130	1" CTS x 1" MPT	098268341072	1	6	60	0.50	\$12.00
	LF4501B-1008	0652008	1/2" CTS x 1/2" MPT	098268436624	1	12	120	0.26	\$6.75
	LF4501B-14 12	0652009	3/4" CTS x 3/4" MPT	098268436631	1	12	120	0.34	\$8.00
	LF4501B-1816	0652010	1" CTS x 1" MPT	098268436648	1	6	60	0.49	\$14.50



Type 10 Female Connectors

Package Type: Poly Bag

LEAD FREE*	3510B-0808	0650103	3/8" CTS x 1/2" NPS	098268305647	1	24	120	0.05	\$4.25
	3510B-1008	0650104	1/2" CTS x 1/2" NPS	098268305654	1	24	120	0.09	\$4.00
	3510B-1012	0650105	1/2" CTS x 3/4" NPS	098268305661	1	24	120	0.10	\$6.25
	3510B-1013	0650106	1/2" CTS x 3/4" Closet	098268305678	1	24	120	0.05	\$4.25
	3510B-1014	0650107	1/2" CTS x 3/4" FGHT	098268305685	1	24	120	0.05	\$8.00
	3510B-1412	0650108	3/4" CTS x 3/4" NPS	098268305692	1	24	120	0.10	\$7.75
	3510B-1816	0651170	1" CTS x 1" NPS	098268353112	1	24	120	0.13	\$6.25
	4510B-1008	0651125	1/2" CTS x 1/2" FPT	098268341157	1	12	120	0.25	\$5.50
	4510B-1412	0651126	3/4" CTS x 3/4" FPT	098268341164	1	6	60	0.20	\$6.50
	4510B-1812	0651191	1" CTS x 3/4" FPT	098268357523	1	6	60	0.30	\$9.25
LEAD FREE*	4510B-1816	0651127	1" CTS x 1" FPT	098268341041	1	6	60	0.53	\$12.00
	LF4510B-1008	0652005	1/2" CTS x 1/2" FPT	098268436594	1	12	120	0.26	\$6.75
	LF4510B-1412	0652006	3/4" CTS x 3/4" FPT	098268436600	1	6	60	0.38	\$8.00
	LF4510B-1816	0652007	1" CTS x 1" FPT	098268436617	1	6	60	0.53	\$14.50



*The wetted surface of this product contacted by consumable water contains less than 0.25% of lead by weight.

Series 35 and 45/LF45 Connectors - cont.

Model	Ordering Code	Size & Connection	UPC	Ind. Bag	Inner Ctn	Mstr Ctn	Unit Weight (lbs)	List Price
-------	---------------	-------------------	-----	----------	-----------	----------	-------------------	------------

Type 11 Stackable Hose Barb Unions

Package Type: Poly Bag

LEAD FREE*	3511B-1008	0650227	1/2" CTS x 1/2" Barb	098268307191	1	24	120	0.04	\$1.70
-------------------	------------	---------	----------------------	--------------	---	----	-----	------	--------



3513

Type 13 Hose Barb Fittings

Package Type: Poly Bag

LEAD FREE*	3513B-1008	0650222	1/2" CTS x 1/2" Barb	098268307139	1	24	120	0.05	\$3.00
	3513B-1412	0650954	3/4" CTS x 3/4" Barb	098268320855	1	28	280	0.05	\$5.75
	3513B-1816	0651171	1" CTS x 1" Barb	098268353129	1	24	120	0.10	\$5.50

Type 14 Reducing Stems

Package Type: Poly Bag



3514

LEAD FREE*	3514B-1008	0650151	1/2" CTS x 3/8" CTS	098268306156	1	24	120	0.10	\$2.75
	3514B-1410	0650152	3/4" CTS x 1/2" CTS	098268306163	1	24	120	0.05	\$3.50
	3514B-1810	0650768	1" CTS x 1/2" CTS	098268309867	1	24	120	0.07	\$5.75
	3514B-1814	0650767	1" CTS x 3/4" CTS	098268309850	1	24	120	0.10	\$6.50

Type 15 Union Connectors

Package Type: Poly Bag



3515

LEAD FREE*	3515B-08	0650073	3/8" CTS	098268304992	1	24	120	0.05	\$4.25
	3515B-10	0650074	1/2" CTS	098268305005	1	24	120	0.05	\$4.75
	3515B-14	0650075	3/4" CTS	098268305012	1	24	120	0.15	\$6.25
	3515B-18	0650950	1" CTS	098268320817	1	10	100	0.08	\$10.25
	4515B-10	0651120	1/2" CTS	098268341102	1	12	120	0.29	\$7.50
	4515B-14	0651121	3/4" CTS	098268341119	1	12	120	0.48	\$8.25
	4515B-18	0651122	1" CTS	098268341126	1	6	60	0.61	\$15.75
LEAD FREE*	LF4515B-10	0652000	1/2" CTS	098268436549	1	12	120	0.21	\$9.00
	LF4515B-14	0652001	3/4" CTS	098268436556	1	12	120	0.33	\$10.00
	LF4515B-18	0652002	1" CTS	098268436563	1	6	60	0.42	\$19.00



LF4515



*The wetted surface of this product contacted by consumable water contains less than 0.25% of lead by weight.

Series 35 and 45/LF45 Connectors - cont.

Model	Ordering Code	Size & Connection	UPC	Ind. Bag	Inner Ctn	Mstr Ctn	Unit Weight (lbs)	List Price
-------	---------------	-------------------	-----	----------	-----------	----------	-------------------	------------

Type 15R Reducing Union Connectors

Package Type: Poly Bag



3515R



LF4515R



3515RB-1004	0650084	½" CTS x ¼" OD	098268305104	1	24	120	0.08	\$9.25
3515RB-1008	0650085	½" CTS x ¾" CTS	098268305111	1	24	120	0.07	\$4.50
3515RB-1410	0650725	¾" CTS x ½" CTS	098268309355	1	24	120	0.13	\$5.75
3515RB-1814	0651173	1" CTS x ¾" CTS	098268353143	1	24	120	0.14	\$6.25
4515RB-1410	0651123	¾" CTS x ½" CTS	098268341133	1	12	120	0.37	\$8.00
4515RB-1814	0651124	1" CTS x ¾" CTS	098268341140	1	6	60	0.62	\$19.25
LF4515RB-1410	0652003	¾" CTS x ½" CTS	098268436570	1	12	120	0.27	\$9.75
LF4515RB-1814	0652004	1" CTS x ¾" CTS	098268436587	1	6	60	0.38	\$23.25

Type 16 Slip Coupling

Package Type: Poly Bag



4516

4516B-10	0651195	½" CTS	098268424836	1	10	120	0.35	\$11.75
4516B-14	0651196	¾" CTS	098268424843	1	10	120	0.47	\$14.50
4516B-18	0651197	1" CTS	098268424850	1	6	60	0.65	\$20.50

Type 27 Male Stem

Package Type: Poly Bag



3527-1008

3527B-1008	0650791	½" CTS x ½" NPT	098268424621	1	24	120	0.08	\$1.50
------------	---------	-----------------	--------------	---	----	-----	------	--------

Type 28 Female Stem

Package Type: Poly Bag



3528-1008

3528B-1008	0650792	½" CTS x ½" NPS	098268424638	1	10	100	0.08	\$1.75
------------	---------	-----------------	--------------	---	----	-----	------	--------

Series 35 and 45/LF45 Ends

Type 45 End Stops

Package Type: Poly Bag



3545

3545B-08	0650235	⅜" CTS	098268307351	1	24	120	0.04	\$3.00
3545B-10	0650236	½" CTS	098268307368	1	24	120	0.07	\$3.00
3545B-14	0650709	¾" CTS	098268309089	1	24	120	0.05	\$4.25
3545B-18	0650771	1" CTS	098268309898	1	24	120	0.05	\$6.50

*The wetted surface of this product contacted by consumable water contains less than 0.25% of lead by weight.

Series 35 and 45/LF45 Ends - cont.

Model	Ordering Code	Size & Connection	UPC	Ind. Bag	Inner Ctn	Mstr Ctn	Unit Weight (lbs)	List Price
-------	---------------	-------------------	-----	----------	-----------	----------	-------------------	------------

Type 45 End Stops

Package Type: Poly Bag

4545B-10	0651156	1/2" CTS	098268340679	1	12	120	0.18	\$6.25
4545B-14	0651157	3/4" CTS	098268340686	1	6	60	0.20	\$7.75
4545B-18	0651158	1" CTS	098268340693	1	6	60	0.25	\$15.75
LF4545B-10	0652036	1/2" CTS	098268436914	1	12	120	0.12	\$7.50
LF4545B-14	0652037	3/4" CTS	098268436921	1	6	60	0.19	\$9.50
LF4545B-18	0652038	1" CTS	098268436938	1	6	60	0.25	\$19.00



LF4545B

Series 35 Pump Fittings

Type 75 Union Pump Fittings

Package Type: Poly Bag

3575B-10	0650190	1/2" CTS	098268306552	1	24	120	0.05	\$3.75
----------	---------	----------	--------------	---	----	-----	------	--------



3575

Type 76 Elbow Pump Fittings

Package Type: Poly Bag

3576B-10	0650194	1/2" CTS	098268306590	1	24	120	0.05	\$4.00
----------	---------	----------	--------------	---	----	-----	------	--------



3576

Series 35 Valves

Type 38 3-Way Selector Valve

Package Type: Poly Bag

3538B-10	0650262	1/2" CTS	098268308082	1	8	40	0.30	\$21.00
----------	---------	----------	--------------	---	---	----	------	---------



3538

Type 39 Stop Valves

Package Type: Poly Bag

3539B-08	0650245	3/8" CTS	098268307580	1	24	120	0.05	\$8.25
3539B-10	0650246	1/2" CTS	098268307597	1	16	80	0.10	\$8.75
3539B-14	0650789	3/4" CTS	098268310177	1	16	80	0.90	\$11.25



3539

Type 39R Reducing Stop Valve

Package Type: Poly Bag

3539RB-1004	0650251	1/2" CTS x 1/4" OD	098268307924	1	16	80	0.10	\$15.00
-------------	---------	--------------------	--------------	---	----	----	------	---------



3539R

Type 40 Union Check Valve

Package Type: Poly Bag

3540B-10	0650271	1/2" CTS	098268308174	1	24	120	0.05	\$5.00
----------	---------	----------	--------------	---	----	-----	------	--------



3540

Type 41 3-Way Bypass Valve

Package Type: Poly Bag

3541B-10	0650264	1/2" CTS	098268308105	1	8	40	0.15	\$21.25
----------	---------	----------	--------------	---	---	----	------	---------



3541

*The wetted surface of this product contacted by consumable water contains less than 0.25% of lead by weight.

Series 35 Valves - cont.



3543

Type 43 Stackable Valve

Package Type: Poly Bag

Model	Ordering Code	Size & Connection	UPC	Ind. Bag	Inner Ctn	Mstr Ctn	Unit Weight (lbs)	List Price
3543B-10	0650255	1/2" CTS	098268307962	1	16	80	0.10	\$6.75



3543R

Type 43R Reducing Stackable Valve

Package Type: Poly Bag

Model	Ordering Code	Size & Connection	UPC	Ind. Bag	Inner Ctn	Mstr Ctn	Unit Weight (lbs)	List Price
3543RB-1004	0650259	1/2" CTS x 1/4" OD	098268308051	1	16	80	0.16	\$11.50



3550

Type 50 Tee Valves

Package Type: Poly Bag

Model	Ordering Code	Size & Connection	UPC	Ind. Bag	Inner Ctn	Mstr Ctn	Unit Weight (lbs)	List Price
3550B-1008	0650712	1/2" CTS x 3/8" CTS	098268309164	1	12	60	0.18	\$15.25
3550B-1004	0651188	1/2" CTS x 1/4" OD	098268357905	1	12	60	0.10	\$13.25



3551

Type 51 Threaded Tee Valve

Package Type: Poly Bag

Model	Ordering Code	Size & Connection	UPC	Ind. Bag	Inner Ctn	Mstr Ctn	Unit Weight (lbs)	List Price
3551B-0808	0650955	1/2" NPS x 1/2" NPT x 3/8" CTS	098268320862	1	15	150	0.05	\$9.50



3552

Type 52 Female In-Line Valves

Package Type: Poly Bag

Model	Ordering Code	Size & Connection	UPC	Ind. Bag	Inner Ctn	Mstr Ctn	Unit Weight (lbs)	List Price
3552B-0806	0651204	1/2" NPS x 1/4" CTS	098268433555	1	16	80	0.08	\$5.75
3552B-0808	0651205	1/2" NPS x 3/8" CTS	098268433562	1	16	80	0.08	\$6.00



3553

Type 53 Female Angle Valves

Package Type: Poly Bag

Model	Ordering Code	Size & Connection	UPC	Ind. Bag	Inner Ctn	Mstr Ctn	Unit Weight (lbs)	List Price
3553B-0608	0651206	1/2" NPS x 1/4" CTS	098268433579	1	16	80	0.08	\$6.25
3553B-0808	0651207	1/2" NPS x 3/8" CTS	098268433586	1	16	80	0.08	\$6.75



3554

Type 54 Female Angle Valve

Package Type: Poly Bag

Model	Ordering Code	Size & Connection	UPC	Ind. Bag	Inner Ctn	Mstr Ctn	Unit Weight (lbs)	List Price
3554B-1408	0651208	1/2" NPS x 3/4" MGHT	098268433593	1	16	80	0.11	\$8.00



3555

Type 55 In-Line Valves

Package Type: Poly Bag

Model	Ordering Code	Size & Connection	UPC	Ind. Bag	Inner Ctn	Mstr Ctn	Unit Weight (lbs)	List Price
3555B-1006	0651200	1/2" CTS x 1/4" CTS	098268433517	1	16	80	0.08	\$7.50
3555B-1008	0651201	1/2" CTS x 3/8" CTS	098268433524	1	16	80	0.08	\$7.00



3556

Type 56 Angle Valves

Package Type: Poly Bag

Model	Ordering Code	Size & Connection	UPC	Ind. Bag	Inner Ctn	Mstr Ctn	Unit Weight (lbs)	List Price
3556B-1006	0651202	1/2" CTS x 1/4" CTS	098268433531	1	16	80	0.08	\$7.25
3556B-1008	0651203	1/2" CTS x 3/8" CTS	098268433548	1	16	80	0.08	\$6.75

*The wetted surface of this product contacted by consumable water contains less than 0.25% of lead by weight.

Series 35 Valves - cont.



3557

LEAD FREE*

Model	Ordering Code	Size & Connection	UPC	Ind. Bag	Inner Ctn	Mstr Ctn	Unit Weight (lbs)	List Price
Type 57 Male Angle Valve								
Package Type: Poly Bag								
3557B-1408	0651209	½" NPT x ¾" MGHT	098268433609	1	16	80	0.10	\$7.50



3558

LEAD FREE*

Type 58 Angle Valve								
Package Type: Poly Bag								
3558B-1014	0651210	½" CTS x ¾" MGHT	098268433616	1	16	80	0.08	\$6.25



3559

LEAD FREE*

Type 59 Panel Mount Valves								
Package Type: Poly Bag								
3559B-08	0650956	¾" CTS	098268320879	1	15	150	0.16	\$9.50
3559B-10	0650957	½" CTS	098268320886	1	15	150	0.19	\$9.50



3561

LEAD FREE*

Type 61 Adapter Stop Valves								
Package Type: Poly Bag								
3561B-0604	0651211	¼" OD x ¾" Male Comp x ¾" Female Comp	098268433623	1	8	40	0.16	\$8.25
3561B-0606	0651212	¾" OD x ¾" Male Comp x ¾" Female Comp	098268433630	1	8	40	0.16	\$8.25

Series 35 Miscellaneous



3547

Type 47 Collet Clips

Package Type: Poly Bag

3547B-08	0650291	¾" CTS	098268308556	3	24	120	0.03	\$1.25
3547B-10	0650292	½" CTS	098268308631	3	24	120	0.03	\$1.25
3547B-14	0650293	¾" CTS	098268308648	3	24	120	0.05	\$1.25
3547B-18	0650772	1" CTS	098268309904	3	24	120	0.03	\$1.25



159

Type 159 O-Ring Assembly

Package Type: Poly Bag

159B-08	0650963	¾" CTS	098268321159	1	24	120	0.01	\$0.90
159B-10	0650718	½" CTS	098268309270	1	24	120	0.01	\$1.00
159B-14	0650719	¾" CTS	098268309287	1	24	120	0.14	\$1.25
159B-18	0651172	1" CTS	098268353136	1	24	120	0.31	\$2.25



161

Type 161 Cone Seals

Package Type: Poly Bag

161B-08	0650723	½" NPS	098268309331	1	24	120	0.03	\$0.90
161B-12	0650724	¾" NPS/FGHT	098268309348	1	24	120	0.008	\$1.50

*The wetted surface of this product contacted by consumable water contains less than 0.25% of lead by weight.

Series 35 Miscellaneous - cont.

Model	Ordering Code	Size & Connection	UPC	Ind. Bag	Inner Ctn	Mstr Ctn	Unit Weight (lbs)	List Price
-------	---------------	-------------------	-----	----------	-----------	----------	-------------------	------------

Type 162 Pipe Inserts

Package Type: Poly Bag



162

LEAD FREE

162-08	0651214	3/8" CTS	098268433654	1	24	120	0.008	\$0.15
162-10	0651160	1/2" CTS	098268340716	1	24	120	0.008	\$0.85
162-14	0651161	3/4" CTS	098268340723	1	24	120	0.008	\$0.90
162-18	0651162	1" CTS	098268340730	1	24	120	0.008	\$0.95

Type 163 Collet Covers

Package Type: Poly Bag



163

163-08	0651213	3/8" CTS	098268433647	1	24	120	0.008	\$0.20
163-10	0651164	1/2" CTS	098268342475	1	24	120	0.008	\$0.85
163-14	0651165	3/4" CTS	098268342482	1	24	120	0.007	\$0.85
163-18	0651166	1" CTS	098268342499	1	24	120	0.008	\$0.85

Series 35 Manifolds - Single



3589

Type 89 Manifolds - Single Union Body

Package Type: Poly Bag

LEAD FREE

3589B-1810	0650764	1" CTS x 1/2" CTS	098268309829	1	6	60	0.20	\$18.75
------------	---------	-------------------	--------------	---	---	----	------	---------



3590

Type 90 Manifolds - Single Stem Body - Right

Package Type: Poly Bag

LEAD FREE

3590B-1810	0650765	1" CTS x 1/2" CTS	098268309836	1	5	50	0.31	\$16.00
------------	---------	-------------------	--------------	---	---	----	------	---------



3591

Type 91 Manifolds - Single Stem Body - Left

Package Type: Poly Bag

LEAD FREE

3591B-1810	0650766	1" CTS x 1/2" CTS	098268309843	1	5	50	0.15	\$16.00
------------	---------	-------------------	--------------	---	---	----	------	---------



3581

Type 81 - Manifold Single Side Mounting Kits

Package Type: Poly Bag

3581B-18	0650769	For 35 Series	098268309874	1	24	120	0.12	\$8.00
----------	---------	---------------	--------------	---	----	-----	------	--------

Series 35 Manifolds - Dual



3583

Type 83 Manifolds - Dual Union Body

Package Type: Poly Bag

LEAD FREE

3583B-1810	0650757	1" CTS x 1/2" CTS	098268309751	1	3	30	0.40	\$33.00
------------	---------	-------------------	--------------	---	---	----	------	---------



3584

Type 84 Manifolds - Dual Stem Body

Package Type: Poly Bag

LEAD FREE

3584B-1810	0650758	1" CTS x 1/2" CTS	098268309768	1	2	20	0.66	\$28.00
------------	---------	-------------------	--------------	---	---	----	------	---------

*The wetted surface of this product contacted by consumable water contains less than 0.25% of lead by weight.

Series 35 Manifolds - Dual - cont.



Type 80 Manifold Dual Side Mounting Kits

Package Type: Poly Bag

Model	Ordering Code	Size & Connection	UPC	Ind. Bag	Inner Ctn	Mstr Ctn	Unit Weight (lbs)	List Price
3580B-18	0650770	For 35 Series	098268309881	1	24	120	0.05	\$8.50

Series 35 Manifold Accessories



Type 82 Manifold Divider Plugs

Package Type: Poly Bag

Model	Ordering Code	Size & Connection	UPC	Ind. Bag	Inner Ctn	Mstr Ctn	Unit Weight (lbs)	List Price
3582B-18	0650759	For 35 Series	098268309775	1	24	120	0.04	\$3.50



Type 85 Manifold Return Ends

Package Type: Poly Bag

Model	Ordering Code	Size & Connection	UPC	Ind. Bag	Inner Ctn	Mstr Ctn	Unit Weight (lbs)	List Price
3585B-18	0650760	1" CTS	098268309782	1	12	120	0.90	\$12.00



Type 86 Manifold Label Plates

Package Type: Poly Bag

Model	Ordering Code	Size & Connection	UPC	Ind. Bag	Inner Ctn	Mstr Ctn	Unit Weight (lbs)	List Price
3586B-18	0650761	Red - For 35 and Metric	098268309799	1	24	120	0.03	\$1.25



Type 87 Manifold Label Plates

Package Type: Poly Bag

Model	Ordering Code	Size & Connection	UPC	Ind. Bag	Inner Ctn	Mstr Ctn	Unit Weight (lbs)	List Price
3587B-18	0650762	Blue - For 35 and Metric	098268309805	1	24	120	0.05	\$1.25



Type 88 Manifold Valve Repair Kits

Package Type: Poly Bag

Model	Ordering Code	Size & Connection	UPC	Ind. Bag	Inner Ctn	Mstr Ctn	Unit Weight (lbs)	List Price
3588B-10	0650763	1/2" Spool	098268309812	1	24	120	0.07	\$3.75



Type 80-MT Manifold Tool

Package Type: Poly Bag

Model	Ordering Code	Size & Connection	UPC	Ind. Bag	Inner Ctn	Mstr Ctn	Unit Weight (lbs)	List Price
3580-MT	0650975	Easy Removal of Outlets	098268326703	1	-	10	0.21	\$6.00



Type 14 Reducing Stems

Package Type: Poly Bag

Model	Ordering Code	Size & Connection	UPC	Ind. Bag	Inner Ctn	Mstr Ctn	Unit Weight (lbs)	List Price
3514B-1810	0650768	1" CTS x 1/2" CTS	098268309867	1	24	120	0.07	\$5.75
3514B-1814	0650767	1" CTS x 3/4" CTS	098268309850	1	24	120	0.10	\$6.50



Type 46 End Plugs

Package Type: Poly Bag

Model	Ordering Code	Size & Connection	UPC	Ind. Bag	Inner Ctn	Mstr Ctn	Unit Weight (lbs)	List Price
3546B-18	0650773	1" CTS	098268310009	1	24	120	0.08	\$4.25

*The wetted surface of this product contacted by consumable water contains less than 0.25% of lead by weight.

Installation Dimensions

35 Series Quick-Connect Manifold

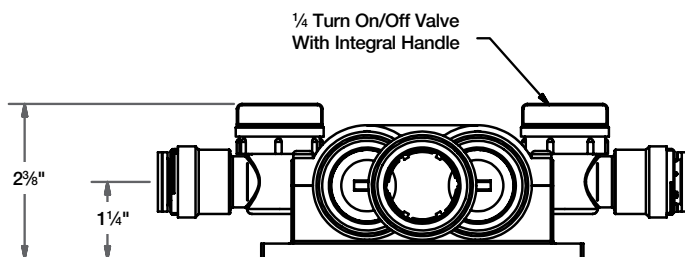
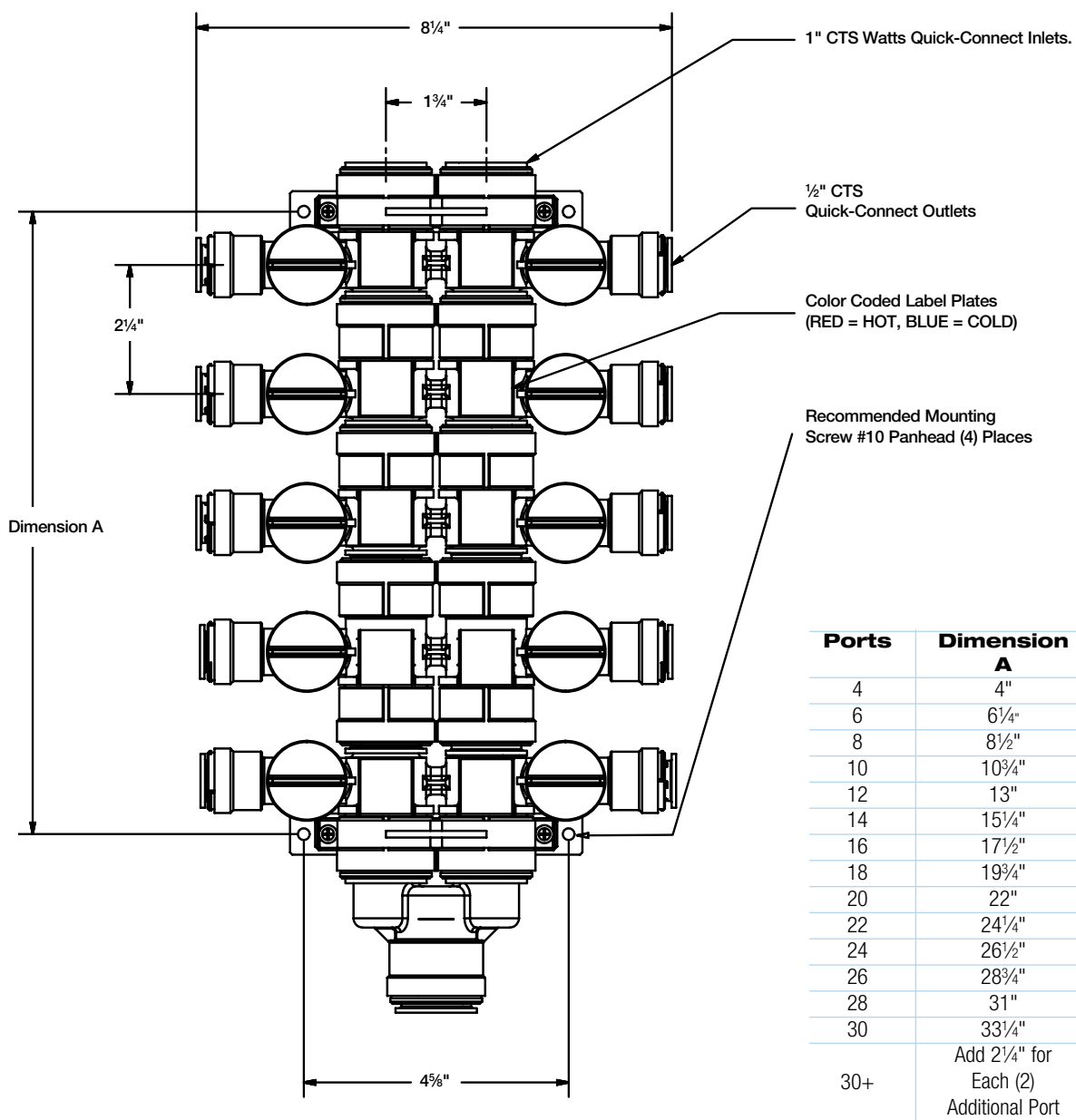

35 Series Quick-Connect Manifold Dual Side Style

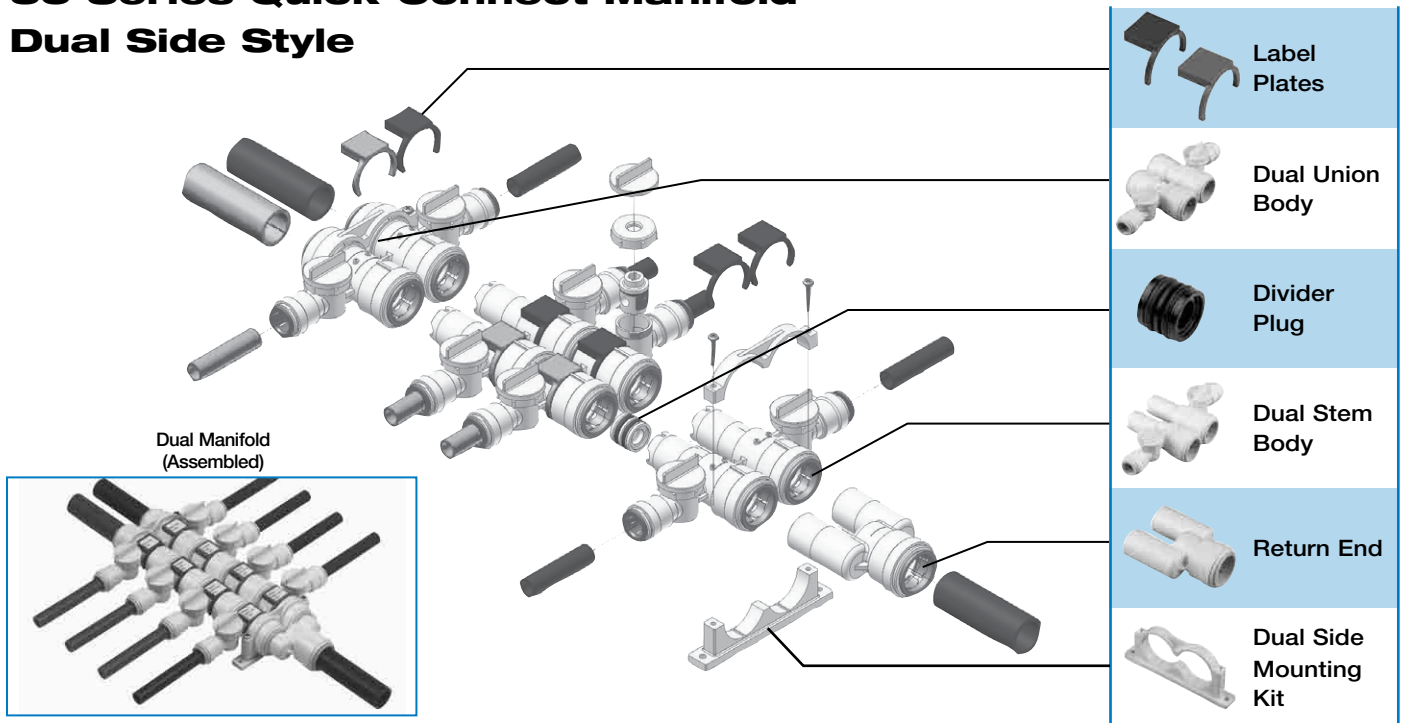

Features

- Integral High-Flow Shutoff Valves
- Eliminates Fittings
- Modular design allows for flexibility
- Increase water flow
- Serviceable Shutoff Valves
- Single and Dual Sections can be connected together
- Field Configurable
- Available in single or dual outlet configurations

Single Side Style

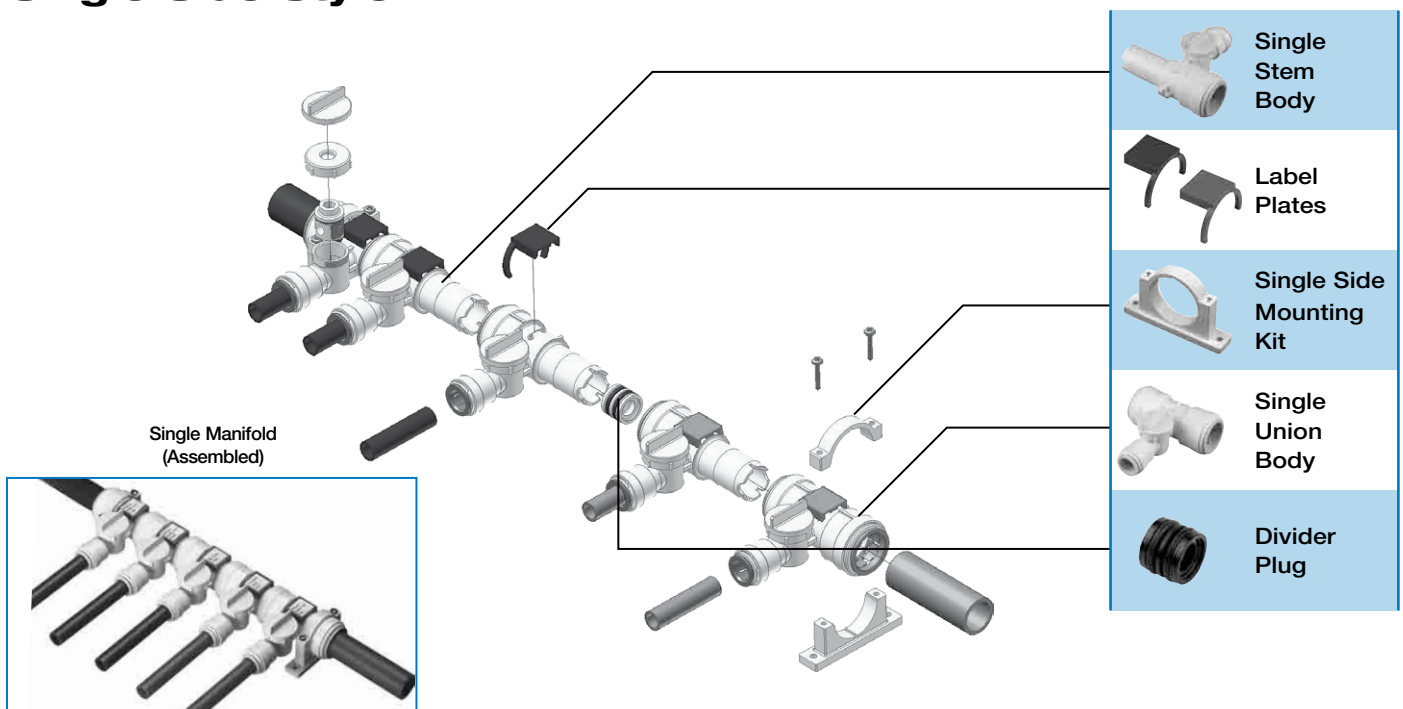

Configuration Styles

35 Series Quick-Connect Manifold

Watts Manifolds operate much like an electrical breaker box. The main water supply lines bring water into the manifold and individual distribution lines move water out to each fixture. All outlets have a built in valve which allows you the ability to stop the water flow to any single fixture without shutting down the entire water system.

The new Watts Manifold System utilizes an exclusive modular design. Manifold Sections can be purchased individually and simply snapped together to create the ideal configuration for each application.

Features

Performance ratings

100psi@180°F 6.8 bar @ 82°C

250psi@75°F 17.25 bar @ 24°C

- Complies with NSF and FDA standards
- All Inlets are 1" CTS, use a Reducing Stem to create other inlet sizes

Single Examples

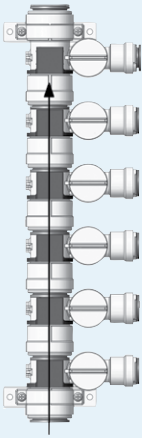
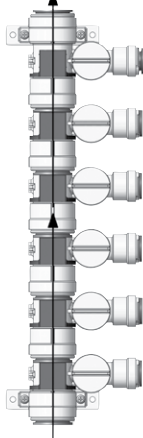
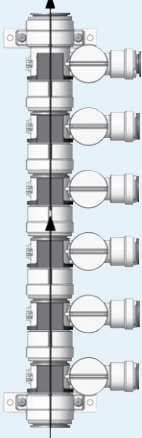
1 Quick-Connect Inlet Single Temperature Use (Hot or Cold)	2 Quick-Connect Inlets Single Temperature Use (Hot or Cold)	2 Quick-Connect Inlets Dual Temperature Use (Hot & Cold)
		

Dual Examples

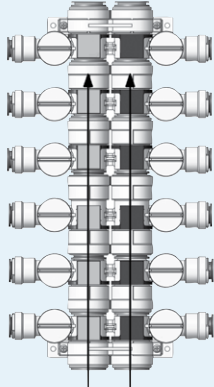
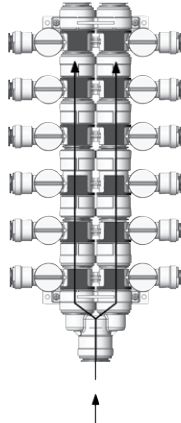
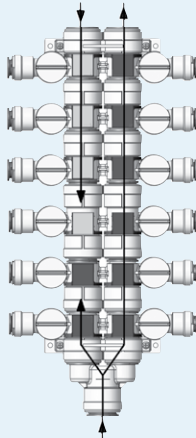
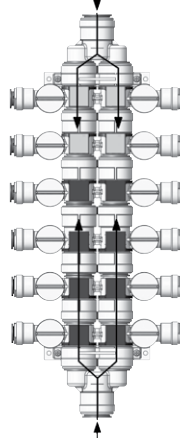
2 Quick-Connect Inlets	1 Quick-Connect Inlet	2 Quick-Connect Inlets 1 Quick-Connect Outlet	2 Quick-Connect Inlets
			

Manifold Labels

Manifold label sheets (like the sample shown below) for use with Watts Type 87 Manifold Label Plates, are available upon request. Please e-mail your request to: wattslit@watts.com.

Water Heater _____	Water Heater _____	Wash Machine _____	Wash Machine _____	Laundry _____	Laundry _____
Ice Maker _____	Ice Maker _____	Kitchen Sink _____	Kitchen Sink _____	Kitchen Sink _____	Kitchen Sink _____
Lav Master _____	Lav Master _____	Lav _____	Lav _____	Lav _____	Lav _____
Lav _____	Lav _____	Bidet _____	Bidet _____	Bar Sink _____	Bar Sink _____
Shower Master _____	Shower Master _____	Shower _____	Shower _____	Shower _____	Shower _____
Tub/ Shower Master _____	Tub/ Shower Master _____	Tub/ Shower _____	Tub/ Shower _____	Bath Master _____	Bath Master _____
Bath _____	Bath _____	Bath _____	Bath _____	Toilet Master _____	Toilet _____
Toilet _____	Toilet _____	Hose Bibb _____	Hose Bibb _____	Hose Bibb _____	Hose Bibb _____

For Technical Assistance Call Your Authorized Watts Representatives.

			TELEPHONE #	FAX #
	HEADQUARTERS: Watts Regulator Company	815 Chestnut St., North Andover, MA 01845-6098 U.S.A.	978 688-1811	watts@wattswater.com
North East	Vernon Bitzer Associates, Inc. Thermco. W. P. Haney Co., Inc.	980 Thomas Drive, Warminster, PA 18974 228 Scoles Ave., Clifton, NJ 07012 51 Norfolk Ave., South Easton, MA 02375	215 443-7500 973 777-6700 508 238-2030	P009@watts.com phil@thermcoreps.com p088@watts.com
Mid Atlantic	Disney McLane & Associates J. B. O'Connor Company, Inc. The Joyce Agency, Inc.	428 McGregor Ave., Cincinnati, OH 45206 202 Commerce Blvd., Lawrence, PA 15055 8442 Alban Rd., Springfield, VA 22150	800 542-1682 724 745-5300 703 866-3111	p017@watts.com p047@watts.com p069@watts.com
South East	Billingsley & Associates, Inc. Francisco J. Ortiz & Co., Inc. GTS Sales Mid-America Marketing, Inc. Mid-America Marketing, Inc. Mid-America Marketing, Inc. Harry Warren, Inc. Harry Warren, Inc.	2728 Crestview Ave., Kenner, LA 70062-4829 Charlyn Industrial Pk Road, 190 KM1.9 - Lot #8, Carolina, Puerto Rico 00983 12428 Angel Oak Drive, Huntersville, NC 28078 203 Industrial Drive, Birmingham, AL 35211 5466 Old Hwy. 78, Memphis, TN 38118 2611 Grandview Avenue, Nashville, TN 37211 1400 North Orange Blossom Trail, Orlando, FL 32804 2861-B Bankers Industrial Drive, Suite B, Atlanta, GA 30360	504 602-8100 787 769-0085 704 274-5626 205 879-3469 901 795-0045 615 259-9944 407 841-9237 770 209-3310	p013@watts.com fjortiz@wntpr.com sales@gtssales.biz p032@watts.com sales@midamericamktg.com john@midamericamktg.com p071@watts.com p059@watts.com
North Central	Dave Watson Associates Mid-Continent Marketing Solderholm & Associates	1325 West Beecher, Adrian, MI 49221 1275 Lakeside Drive, Romeoville, IL 60446 7150 143rd Ave. NW, Anoka, MN 55303	517 263-8988 630 953-1211 763 427-9635	p085@watts.com p072@watts.com company@soderholmrep.com
South Central	Hugh M. Cunningham, Inc. Sandia Group, Inc. Mack McClain & Associates, Inc. Mack McClain & Associates, Inc. Mack McClain & Associates, Inc. Mack McClain & Associates, Inc.	13755 Benchmark, Dallas, TX 75234 3167 San Mateo #308, Albuquerque, NM 87110 4407 Meramec Bottom, Suite G, St. Louis, MO 63129 1450 NE 69th Place, Ste. 56 Ankeny, IA 50021 15090 West 116th St., Olathe, KS 66062 16628 Ames Avenue, Omaha, NE 68116	972 888-3808 800-339-0191 314 894-8188 515 288-0184 913 339-6677 515 288-0184	p031@watts.com p031@watts.com p045@watts.com p049@watts.com p083@watts.com p049@watts.com
Western	Columbia Hydronics Delco Sales, Inc. Delco Sales, Inc. Fanning & Assoc., Inc. P I R Sales, Inc. R. E. Fitzpatrick Sales, Inc. REPCOR Specification Sales Specification Sales VEMCO (main office) VEMCO VEMCO	552 W. 58th Ave., Unit A, Anchorage, AK 99518 1930 Raymer Ave., Fullerton, CA 92833 111 Sand Island Access Rd., Unit I-4, Honolulu, HI 96819 6765 Franklin St., Denver, CO 80229 3050 North San Marcos Place, Chandler, AZ 85225 4109 West Nike Dr., West Jordan, UT 84088 2455 Mercantile Drive, Ste. 100, Rancho Cordova, CA 95742 1126 8th Street, Kirkland, WA 98033 1417 NE 76th St., Vancouver, WA 98665 2016 2nd. Avenue North, Billings, MT 59101 201 N. Russell, Missoula, MT 59801 1625 3rd. Ave., Great Falls, MT 59401	907 563-3327 714 888-2444 808 842-7900 303 289-4191 480 892-6000 801 282-0700 916 386-2233 425 576-0278 360 737-2540 406 248-8373 406 549-6113 406 727-5335	tepperson@columbiahydronics.com sales@delcosales.com p021@watts.com sales@fanningandassociates.com sales@pirsales.com p007@watts.com sales@repco1.com info@specs1s.net scott@specs1s.net mail@vemcoinc.com elisak@vemcoinc.com melaniew@vemcoinc.com
1231	EXPORT Hdqtrs.: Watts Regulator Co.	815 Chestnut St., North Andover, MA 01845-6098 U.S.A.	Telephone 978 688-1811	E-mail watts@wattswater.com



A Watts Water Technologies Company



USA: Tel. (978) 688-1811 • Fax: (978) 794-1848 • www.watts.com

Canada: Tel. (905) 332-4090 • Fax: (905) 332-7068 • www.watts.ca