

or Residential and Commercial Applications

Job Name		Engineer / Architect	
Job Location		Wholesaler	
Submittal Date		Contractor	

BRPX44 Multi-Turn Straight Stop - Barbed PEX x Barbed PEX

Use: For use in potable water distribution systems. Not intended for recirculating systems that produce continuous use temperatures above 115° F. For those applications, use our KT™ series ball stop.

Design Features:

- **Machined one-piece brass body** provides strength, durability, and long-lasting performance
- **Knurled oval handle** provides a secure grip and smooth on/off operation
- **Easy-to-remove handle** with screw attachment helps protect against accidental stop operation during rough-ins
-  **No Lead**
- **PEX end** designed to ASTM F1807
- **For use with** ASTM F876 PEX tubing, in ASTM F877 water distribution systems using ASTM F1807, and/or F2098 connection methods

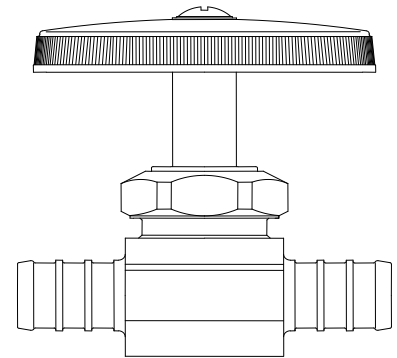

Operating Specifications:

Temperature: 40° - 140° F

Pressure: 125 PSI maximum



Standard

STOP MATERIAL SPECIFICATIONS	
Body	Brass or brass, chrome plated
Stem	POM
Bib & Packing Washer	Rubber
Packing Nut	Brass, chrome plated
Handle	Polycarbonate
Handle Screw	Zinc-plated steel

No Lead

STOP MATERIAL SPECIFICATIONS	
Body	No-Lead brass or No-Lead brass, chrome plated
Stem	POM
Bib & Packing Washer	Rubber
Packing Nut	Brass, chrome plated
Handle	Polycarbonate
Handle Screw	Zinc-plated steel

Standard Part Listing:

- ☐ BRPX44 R 1/2" nom barb (for PEX) x 1/2" nom barb (for PEX), rough brass
- ☐ BRPX44T R 1/2" nom barb (for PEX) x 1/2" nom barb (for PEX), rough brass, no tray

No-Lead Part Listing:

- ☐ BRPX44X C 1/2" nom barb (for PEX) x 1/2" nom barb (for PEX), chrome plated
- ☐ BRPX44X R 1/2" nom barb (for PEX) x 1/2" nom barb (for PEX), rough brass

This specification and all information contained herein is the confidential and exclusive property of BrassCraft Manufacturing, and shall not be disclosed to others without the written consent of BrassCraft Mfg. This specification must be returned to BrassCraft Mfg. if requested.

400.73 BRPX44 Multi-Turn Straight Stop – Barbed PEX x Barbed PEX Rev 08/13

BrassCraft®

© 2013 BrassCraft Mfg.

BRPX44 Multi-Turn Straight Stop - Barbed PEX x Barbed PEX

PART DIMENSIONS (Inches)		
Model	DIM. A	DIM. B
BRPX44	1.77	2.19

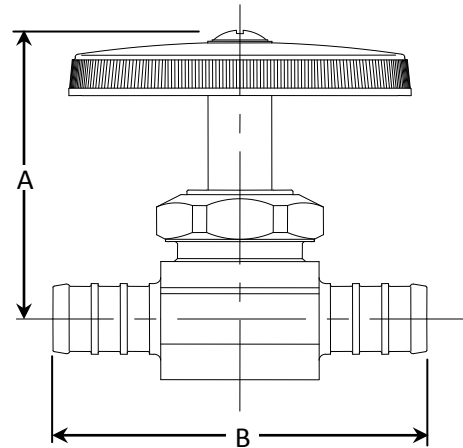

Listings & Certifications:

- IAPMO listed to ASME A112.18.1 / CSA B125.1 (File # 0645)
- CSA listed to ASME A112.18.1 / CSA B125.1 (File # 204593)
- No-Lead product CSA listed to Low Lead Content Certification Program – Plumbing Products Class 6853-01



This specification and all information contained herein is the confidential and exclusive property of BrassCraft Manufacturing, and shall not be disclosed to others without the written consent of BrassCraft Mfg. This specification must be returned to BrassCraft Mfg. if requested.

400.73 BRPX44 Multi-Turn Straight Stop – Barbed PEX x Barbed PEX Rev 08/13

BrassCraft®

© 2013 BrassCraft Mfg.