

Features

- Titan series.
- 31½" (800) x 18½" (470) x 10" (254) undermount kitchen sink.
- Super single compartment that is the size of a double bowl sink.
- Handcrafted from premium 304 stainless steel. Channel grooves in sink bottom direct water to drain. Premium brushed finish.
- Sink is available in 14 gauge and 16 gauge.
- Includes a stainless steel bottom sink grid and stainless covered flip-top sink strainer.
- 3/8" (10mm) radius corners.
- 5mm sound deadening pads.
- Fits 36" (914) base cabinet width.

Components

Product includes:

TSGD3219T1 Bottom Sink Grid
2210R Covered Sink Strainer
Cutout Template
Installation Hardware
Installation Instructions

Warranty

- Lifetime Limited Warranty

Specified Model

Model	EHUT013-32
Overall Dimensions	L31½" x W18½" x D10" 800 x 470 x 254
Bowl Dimensions	L30" x W17" x D10" 763 x 433 x 254
Drain holes:	3⅝" (92mm)
Shipping Weight	40-42 lbs.
Material	14 gauge 304 stainless steel 16 gauge 304 stainless steel
Installation	under counter mounted
Required	template, included

To Be Specified

	Model No.	Stainless Steel Gauge
<input type="checkbox"/>	DUSST321910-14	14 gauge
<input type="checkbox"/>	DUSST321910-16	16 gauge

Codes/Standards

ASME A112.19.3/CSA B45.4

Notes

Install this product according to the installation instructions.

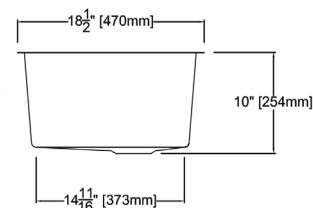
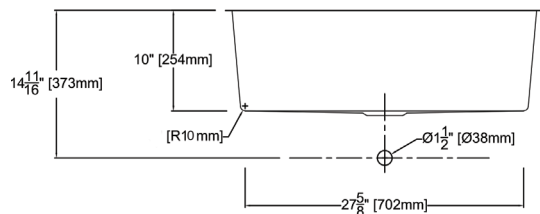
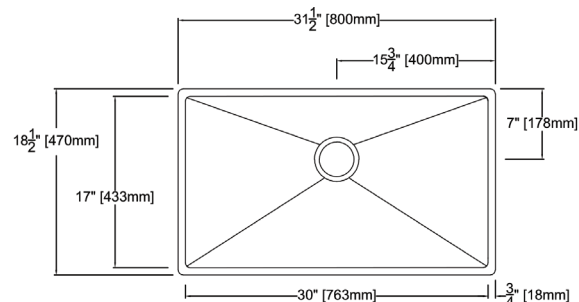

Components

Product includes:

TSGD3219T1 Bottom Sink Grid

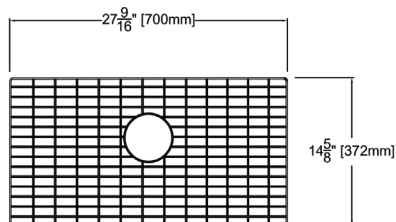

2210R Covered Flip Top Sink Strainer.

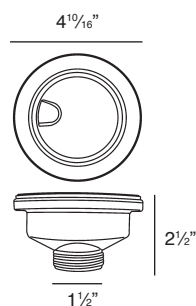

Water drains easily when cover is in place. Cover flips up with easy touch. Polypropylene housing. Fits standard 3½" opening.

Optional Accessories

4010 Covered Flip Top Disposer Strainer.

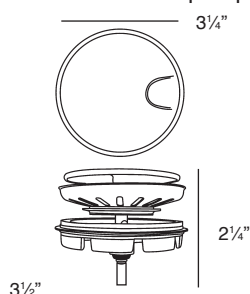

Water drains easily when cover is in place. Cover flips up with easy touch. Polypropylene housing. Top mount installation for 3½" opening.

2310 Remote Covered Flip Top Sink Strainer.

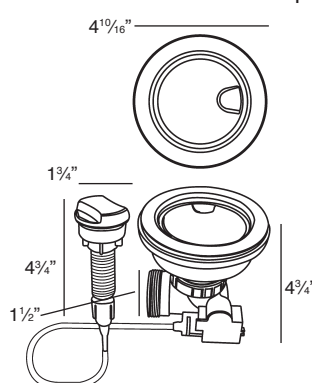

Turn the remote knob to open and close drain. Water drains easily when cover is in place. Cover flips up with easy touch. Polypropylene housing. Fits standard 3½" opening. 1⅝" hole required in countertop for remote installation. Remote cable 25½" L.