

### Features

- 32<sup>63</sup>/<sub>64</sub>" (838) x 22<sup>1</sup>/<sub>64</sub>" (559) x 8" (203) top mount kitchen sink.
- Double equal compartments.
- 18 gauge 304 stainless steel.
- Rear center drain location.
- Brushed finish.
- Superior undercoating for added sound insulation.
- 3mm sound deadening pads on all 4 sink sides and bottom. Up to 3 times heavier than competitive models.
- Fits 36" base cabinet width.

### Components

Product includes:  
Cutout Template  
Installation Hardware  
Installation Instructions

### Options

TSGC33222 Stainless Steel Bottom Sink Grid Set  
TCBC1516 Bamboo Cutting Board  
2210R Covered Sink Strainer  
4010 Covered Disposer Strainer

### Warranty

- Lifetime Limited Warranty

### Specified Model

Model	EPT220-33
Overall Dimensions	L32 <sup>63</sup> / <sub>64</sub> " x W22 <sup>1</sup> / <sub>64</sub> " x D8" 838 x 559 x 203
Bowl Dimensions (Left)	L14 <sup>1</sup> / <sub>64</sub> " x W15 <sup>63</sup> / <sub>64</sub> " x D8" 356 x 406 x 203
Bowl Dimensions (Right)	L14 <sup>1</sup> / <sub>64</sub> " x W15 <sup>63</sup> / <sub>64</sub> " x D8" 356 x 406 x 203
Drain holes:	3 <sup>5</sup> / <sub>8</sub> " (92mm)
Shipping Weight	23 lbs.
Material	18 gauge 304 stainless steel
Installation	counter top mounted
Required	template, included

### To Be Specified:

see back for configurations available for this sink

	Faucet Hole Drillings
<input type="checkbox"/>	1 Hole
<input type="checkbox"/>	2 Holes - <b>ML2</b>
<input type="checkbox"/>	2 Holes - <b>MR2</b>
<input type="checkbox"/>	3 Holes
<input type="checkbox"/>	4 Holes
<input type="checkbox"/>	5 Holes

### Codes/Standards

ASME A112.19.3/CSA B45.4

### Notes

Install this product according to the installation instructions.

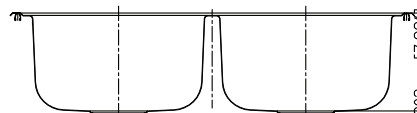
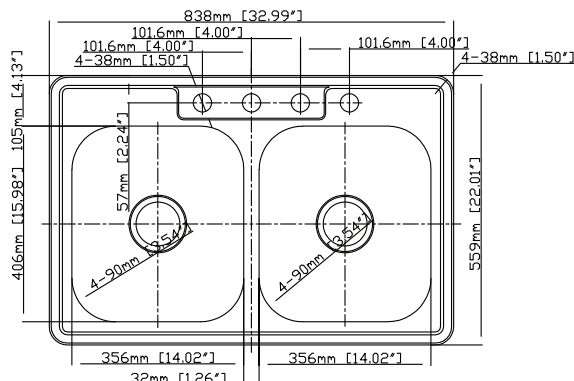

Faucet Hole Configurations available for this sink model

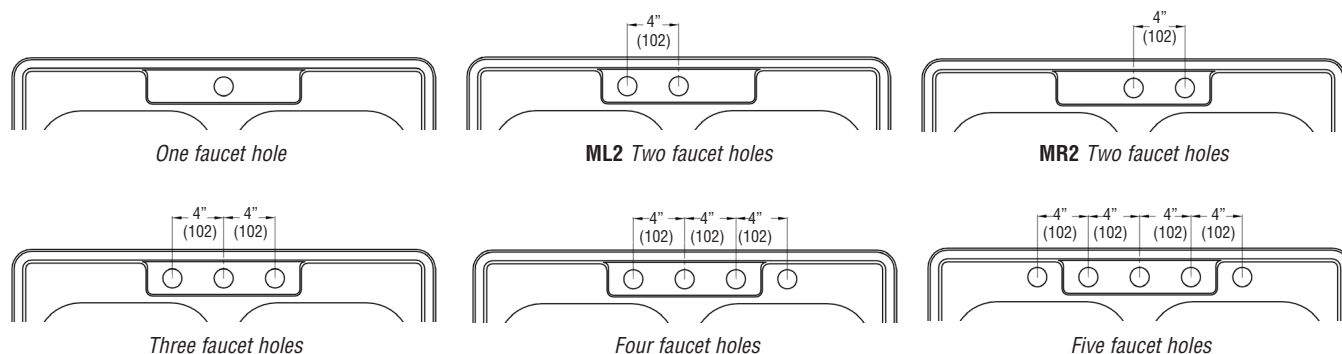

Optional Accessories

TSGC33222 Bottom Sink Grid Set

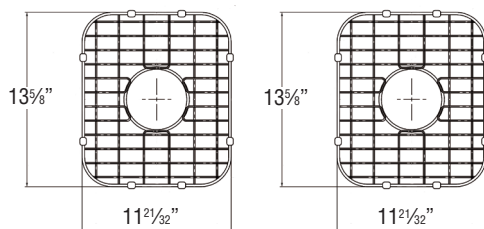

2210R Covered Flip Top Sink Strainer.

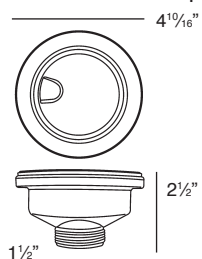

Water drains easily when cover is in place. Cover flips up with easy touch. Cover makes a flat surface at the sink bottom that prevents food waste from getting into the strainer basket for easy sink clean up. Polypropylene housing. Fits standard 3 1/2" opening.

2310 Remote Covered Flip Top Sink Strainer.

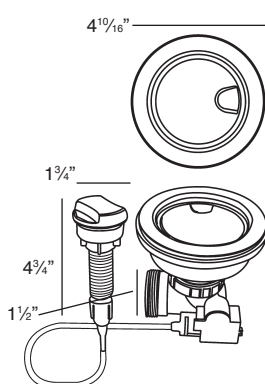

Turn the remote knob to open and close drain. Water drains easily when cover is in place. Cover flips up with easy touch. Cover makes a flat surface at the sink bottom that prevents food waste from getting into the strainer basket for easy sink clean up. Polypropylene housing. Fits standard 3 1/2" opening. 1 3/8" hole required in countertop for remote installation. Remote cable 25 1/2" L.

4010 Covered Flip Top Disposer Strainer.

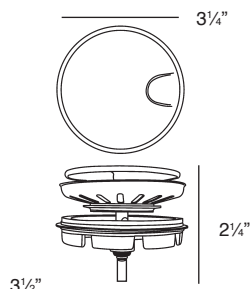

Water drains easily when cover is in place. Cover flips up with easy touch. Polypropylene housing. Top mount installation for 3 1/2" opening.