

### Features

- 23 $\frac{1}{8}$ " (587) x 17 $\frac{53}{64}$ " (453) x 9" (229) undermount kitchen sink.
- Single compartment.
- 16 gauge 304 stainless steel.
- Center drain location.
- Brushed finish with highlight rim.
- Superior undercoating for added sound insulation.
- 3mm sound deadening pads on all 4 sink sides and bottom. Up to 3 times heavier than competitive models.
- Fits 27" base cabinet width.

### Components

Product includes:

- Cutout Template
- Installation Hardware
- Installation Instructions

### Options

- TSGM2318S1 Stainless Steel Bottom Sink Grid
- TCBM1016 Bamboo Cutting Board
- 2210R Covered Sink Strainer or
- 4010 Covered Disposer Strainer

### Warranty

- Lifetime Limited Warranty



### Specified Model

Model	EPU31-23
Overall Dimensions	L23 $\frac{7}{64}$ " x W17 $\frac{53}{64}$ " x D9" 587 x 453 x 229
Bowl Dimensions	L21 $\frac{1}{32}$ " x W15 $\frac{3}{4}$ " x D9" 534 x 400 x 229
Drain hole:	3 $\frac{5}{8}$ " (92mm)
Shipping Weight	28 lbs.
Material	16 gauge 304 stainless steel
Installation	under counter mounted
Required	template, included

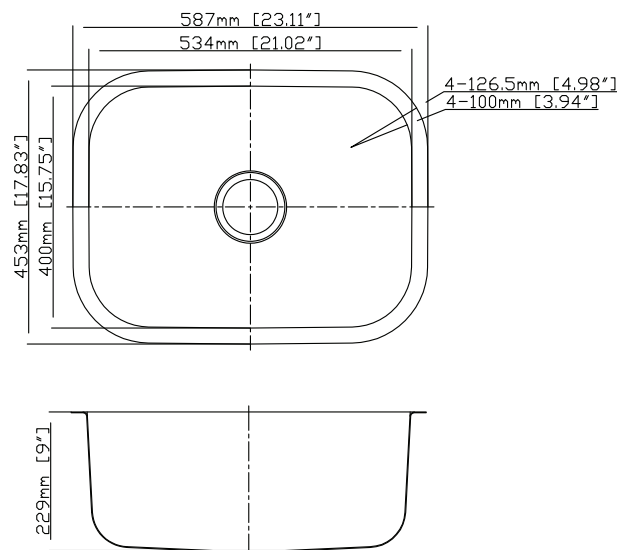

### Codes/Standards

ASME A112.19.3/CSA B45.4

### Notes

Install this product according to the installation instructions.

## Optional Accessories

### TSGM23181 Bottom Sink Grid

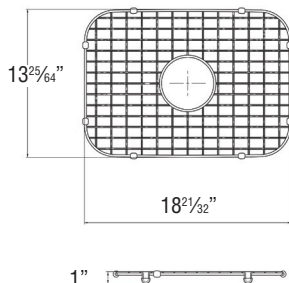

### 2210R Covered Flip Top Sink Strainer.

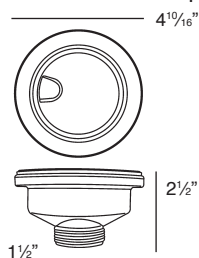

Water drains easily when cover is in place. Cover flips up with easy touch. Cover makes a flat surface at the sink bottom that prevents food waste from getting into the strainer basket for easy sink clean up. Polypropylene housing. Fits standard 3 $\frac{1}{2}$ " opening.

### 2310 Remote Covered Flip Top Sink Strainer.

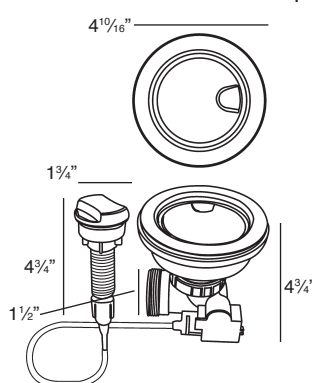

Turn the remote knob to open and close drain. Water drains easily when cover is in place. Cover flips up with easy touch. Cover makes a flat surface at the sink bottom that prevents food waste from getting into the strainer basket for easy sink clean up. Polypropylene housing. Fits standard 3 $\frac{1}{2}$ " opening. 1 $\frac{3}{8}$ " hole required in countertop for remote installation. Remote cable 25 $\frac{1}{2}$ " L.

### 4010 Covered Flip Top Disposer Strainer.

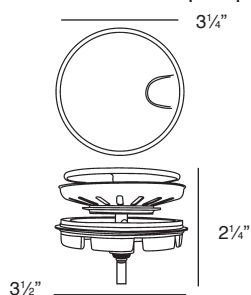

Water drains easily when cover is in place. Cover flips up with easy touch. Polypropylene housing. Top mount installation for 3 $\frac{1}{2}$ " opening.