

# ROHL

Authentic Luxury for Kitchen and Bath™

[www.rohlhome.com](http://www.rohlhome.com)



## 3-Hole Widespread Faucet

ROHL Country Bath Arcana

**AC107L-2** (Ornate Metal Lever)

**AC107LM-2** (Classic Metal Lever)

**AC107X-2** (Cross Handle)

**AC107OP-2** (Ornate Porcelain Lever)

### FEATURES

- 3 x 1 3/8" cutouts
- 1/4-turn ceramic disc valves
- Fixed spout
- Pop-up drain, 1 1/4" pipe
- Spout, valve housing, and pop-up made from solid brass
- 7 1/2" overall height
- 1.5GPM

### FINISHES

- Polished Chrome
- Polished Nickel
- Satin Nickel
- Tuscan Brass
- Inca Brass

### WARRANTY

- Limited Lifetime\*
- \* No Warranty on Tuscan Brass Finish (TCB)

AC107X

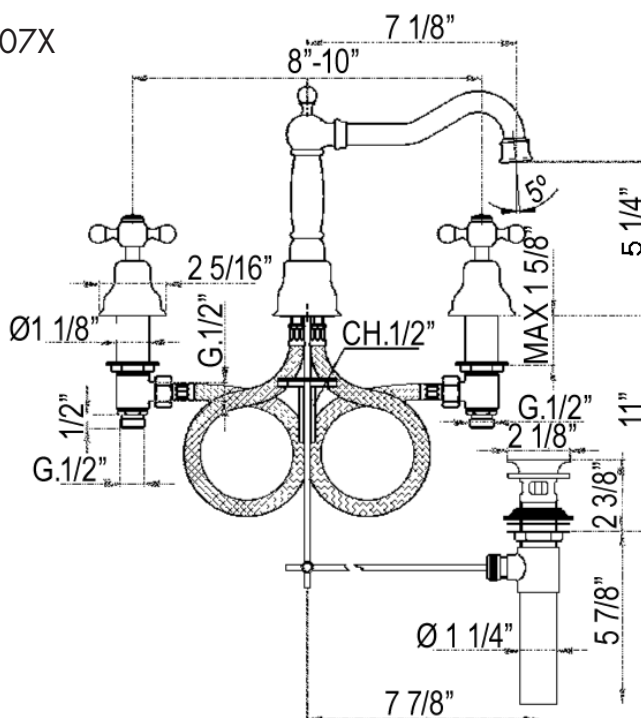

AC107L



AC107OP



AC107LM

Consult your local ROHL showroom for additional information and specifications. For complete warranty details and a list of showrooms, go to [www.rohlhome.com](http://www.rohlhome.com).

## AC107-2 Spare Parts

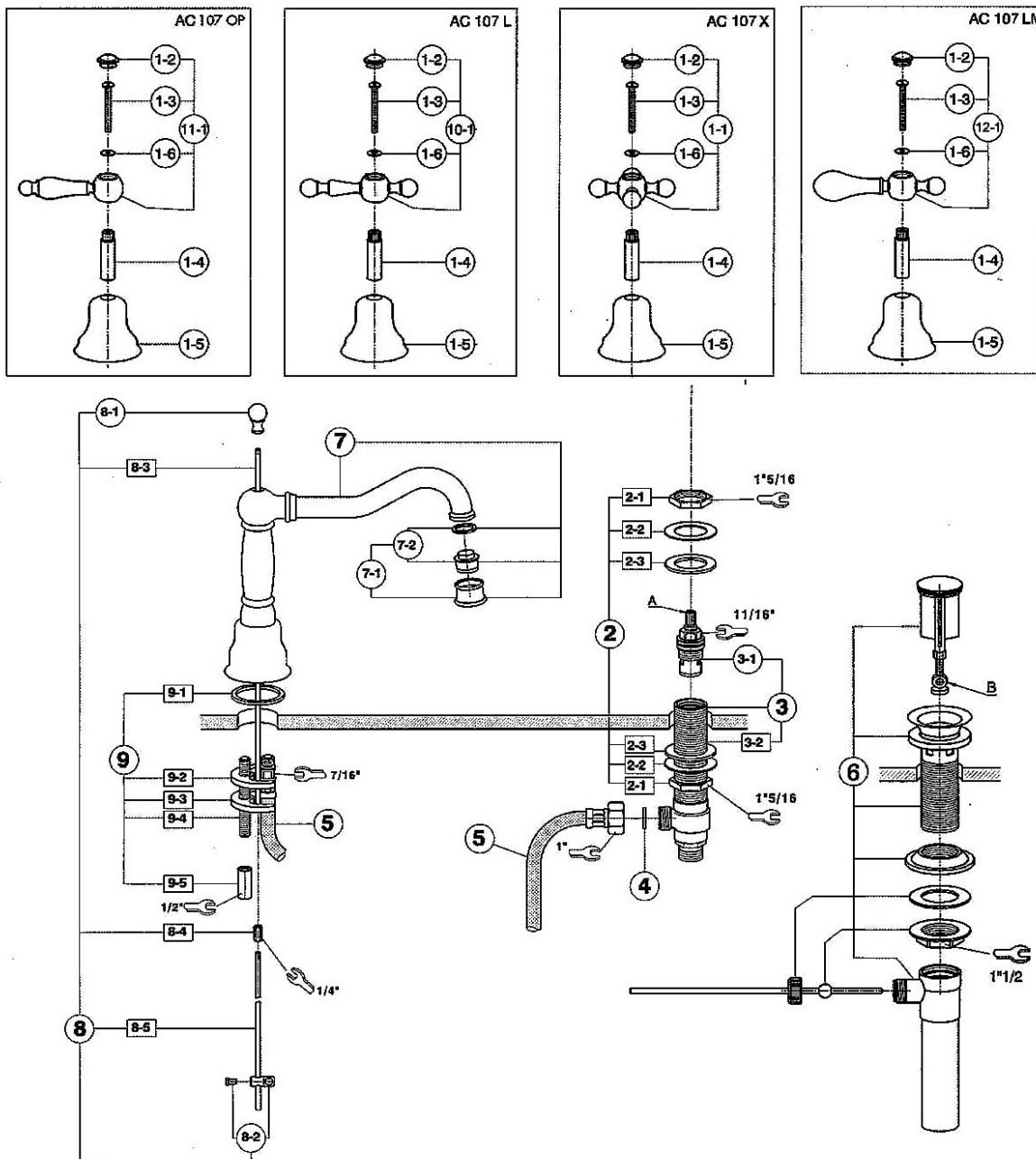

POS.	DESCRIPTION	CODE	POS.	DESCRIPTION	CODE
1-1	Cross handle "Cold" mark with screw and cap - 3 hole lavatory	ZZ 92112 0	6	American Standard pop-up waste	ZA 00755 0
1-1	Cross handle "Hot" mark with screw and cap - 3 hole lavatory	ZZ 92111 0	7	Spout basin mixer	ZZ 94242 0
1-2	Cap for handle "AR" "Cold"	ZZ 93861 0	7-1	Overfill with M.22x1 Cascade 7,6 l/min	ZZ 94057 0
1-2	Cap for handle "AR" "Hot"	ZZ 93862 0	7-2	Mousseur cartridge M.22x1 Cascade 7,6 l/min	ZZ 93393 0
1-3	Screw M.4x40	ZZ 92679 0	8	Rod Ø4	ZZ 94243 0
1-4	Extension for headvalve "AA" - long	ZZ 92672 0	8-1	Knob for pop-up rod	ZZ 94244 0
1-5	Escutcheon "AR"	ZZ 92598 0	8-2	Connection for pop-up rod	ZZ 92622 0
1-6	Ring in brass 12x4,3x1	ZZ 92673 0	9	Installation set single hole	ZZ 92851 0
2	Installation set basin mixer	ZZ 92756 0	10-1	Ormate Metal lever handle "Cold" mark - 3 hole lavatory	ZZ 92117 0
3	Tail piece-basin mixer right	ZZ 93150 0	10-1	Ormate Metal lever handle "Hot" mark - 3 hole lavatory	ZZ 92118 0
3	Tail piece-basin mixer left (only AC 102 L - AC 102 LP)	ZZ 93151 0	11-1	Ormate Porcelain lever with "Cold" mark - 3 hole lavatory	ZZ 973670 2
3-1	Ceramic headvalve 1/2" right 90°	ZZ 92907 0	11-1	Ormate Porcelain lever with "Hot" mark - 3 hole lavatory	ZZ 973680 2
3-1	Ceramic headvalve 1/2" left 90° (only AC 102 L - AC 102 LP)	ZZ 92906 0	12-1	Classic Metal lever with "Cold" mark - 3 hole lavatory	ZZ 95033 0
4	Gasket rubber 18,5x11x2	ZZ 92714 0	12-1	Classic Metal lever with "Hot" mark - 3 hole lavatory	ZZ 95034 0
5	Flex M11x1 - 1/2"	ZZ 93248 0			

## INSTALLATION INSTRUCTIONS

### INSTALLATION INSTRUCTIONS

#### PRELIMINARY INFORMATION

- We recommend the use of a professional plumber
- Flush the plumbing system before installation of the mixer. This will prevent residue from clogging the line and aerator. Especially important in new construction.
- Mixers of the ARCANA series are fit for operating with hot water collectors under pressure, instantaneous and gas water-heaters

#### TECHNICAL DATA

- Minimum dynamic pressure .....7.25 psi
- Maximum operational pressure (static).....145 psi
- Recommended operational pressure(static)..14.5-72.5 psi (N.B.: for pressures higher than 72.5 psi we suggest the installation of a pressure reducer)
- Maximum test pressure (static).....232 psi
- Maximum hot water temperature .....176°F
- Suggested hot water temperature .....140°F (for energy saving)
- Hot water connection ..... left
- Cold water connection ..... right
- Flow rate.....max 1.5gpm @ 60 psi

#### SPOUT INSTALLATION

- Screw the flexible hoses (5) to the mixer using a 7/16" crescent wrench positioning it in the special millings.
- IMPORTANT: during the flexible hose assembly operations, DO NOT HOLD the sleeve of the flexible hose with VICE GRIPS OR ADJUSTABLE PLIERS, this could damage them, and would compromise the safety of the installation.
- Screw the fixing stem (9-4) on the spout (7).
- Insert the spout (7) in the central hole of the lavatory (min. 0 1" 3/8); placing the packing (9-1) between the spout and the lavatory.
- Fix the spout on the ceramics by a shaped packing (9-2), fixing clamp (9-3) and hexagonal check-nut; using a 1/2" crescent wrench.
- Insert the pop-up's rod (8-3) and screw the knob (8-1).
- Connect the lower rod (8-5) to the upper rod (8-3) by the connection(8-4) and using a 1/4" wrench.

#### HEADVALVE INSTALLATION

1. Screw a mounting nut (2-1) on the tail-piece (3-2) and mount first a gasket (2-2); then a seal (2-3)
2. Insert the tail piece into the side hole of the sink (min. 01"18)
3. Assemble the other seal (2-3); then the other gasket (2-2) and then screw down the other mounting nut.

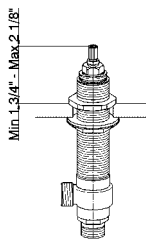

4. The head valves height on the sink should be between min. 1 3/4" and max. 2 1/8" (recommended height 1 7/8").
5. Screw the flexible hose (5) to the cross connection and insert the seals (4).
6. Screw down the joint (1-5) on the tail-piece.
7. Assemble on the rod (A) of the head valve (3-1) the extension (1-4) first; then the handle (1-7) (10-7) (11-7) on the extension and place the gasket (1-3) inside the handle.
8. Screw down the screw (1-3) and mount the cover cap (1-2)

#### POP UP DRAIN INSTALLATION

1. Insert the drain (6-2) into the hole of the sink. Use an approved sealant under the drain (6-2) to make a watertight seal.
2. Mount on the drain the tapered seal (6-4) first; then the gasket (6-5) and screw down the check nut (6-6).
3. Screw the body (6-7) to the drain.
4. Unscrew the nut (6-9), insert the horizontal rod (6-8) into the body; taking care that the end is inserted into the hole (B) on the plug (6-1) and then mount the nut again.
5. Connect the stick (8-5) with the horizontal rod (6-8), using the connection piece (8-2).

#### MAINTENANCE

The faucets are fitted with an aeration device in the Hot/Cold water outlet. This may need occasional cleaning especially in hard water areas. This is accomplished by unscrewing the outlet in a counter clockwise direction, dismantling and leaving the inner screen mesh immersed over night in a solution of a 50% / 50% solution of vinegar and water.

#### WARRANTY INFORMATION

There is no warranty on the Tuscan Brass finish.

## INSTALLATION INSTRUCTIONS

### FINISH CARE

1. WIPE DOWN AFTER USE TO AVOID SPOTTING
2. USE A SOFT BRUSH FOR DETAIL CLEANING
3. DO NOT USE SPRAY CLEANERS WITH AMMONIA, ALCOHOL OR BLEACH
4. DO NOT USE ABRASIVES LIKE COMET, AJAX OR BONAMI

FINISH	CLEANING	CARE
CHROME	50-50 VINEGAR AND WATER	FLITZ WAX OR GAGNON, SIMICHROME
INCA BRASS	50-50 VINEGAR AND WATER	<b>DO NOT USE FLITZ –</b> GAGNON OK
POLISHED NICKEL	50-50 VINEGAR AND WATER	FLITZ WAX OR GAGNON, SIMICRHOME
SATIN NICKEL	50-50 VINEGAR AND WATER	FLITZ WAX OR GAGNON
TUSCAN BRASS	PAT DRY AFTER USE	FLITZ WAX. NO WARRANTY. DO NOT RUB OR WIPE.

FOR WATER SPOTTING ON CHROME, POLISHED NICKEL OR SATIN NICKEL, USE SIMICHROME PASTE.



**ROHL LLC**  
3 PARKER  
IRVINE, CA 92618-1605 USA  
Phone: 800.777.9762 Fax: 714.557.8635  
[www.rohlhome.com](http://www.rohlhome.com)



**Rubinetteria CISAL S.p.A.**  
Via Pietro Durio, 160  
28010 Alzo di Pella (Novara) – ITALIA  
Tel.+39.0322.918111 – Fax +39.0322.969518  
E-mail: [cisal@cisal.it](mailto:cisal@cisal.it) - [www.cisal.it](http://www.cisal.it)