

BBC36,BBC42, BBC45
ASSEMBLY INSTRUCTIONS

- STEP 1: Joint side panel with back panel
STEP 2: Joint bottom panel with side panel
STEP 3: Joint side panel with bottom & back panel
STEP 4: Attach frame on and toe/kick board
STEP 5: Joint the drawer together, then install the drawer guide.
STEP 6: Attach the wood block on the top corner, and put on the adjustable shelf
STEP 7: Fix drawer head on the drawer front and fix door onto the frame and adjust the cover-space

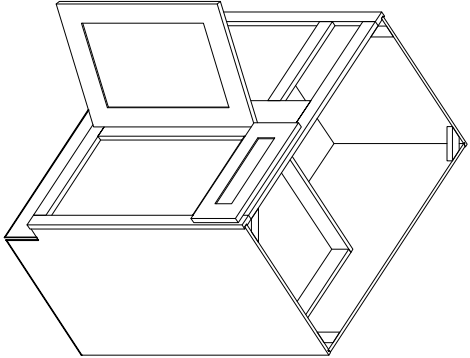

PARTS LIST		
NO.	Description	QTY
A	BACK PANEL	1
B	SIDE PANEL	2
C	TOP&BOTTOM PANEL	1
D	TOE KICK	1
E	FACE FRAME	1
F	DRAWER BOX FRONT AND BACK	2
G	DRAWER BOX SIDE	2
H	DRAWER BOX BOTTOM	1
I	ADJUSTABLE SHELF	1
J	CABINET'S DOOR	1
K	DRAWER HEAD	1

STEP1

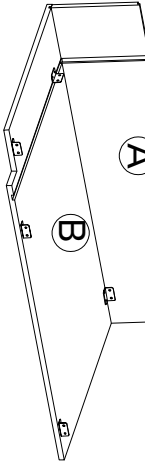

STEP2

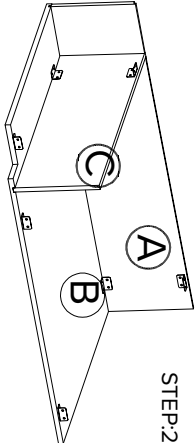

STEP3

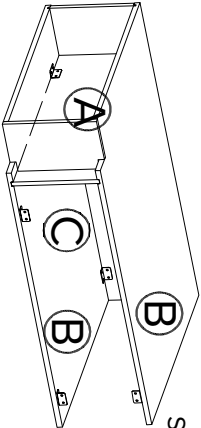

STEP4

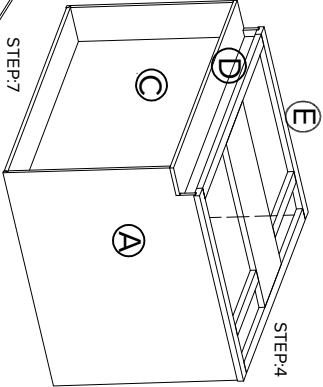

STEP5

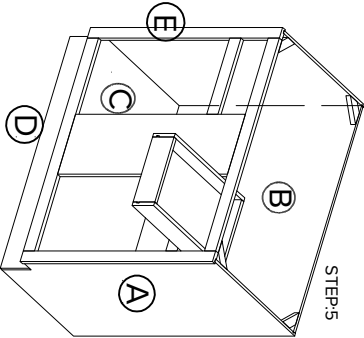

STEP6

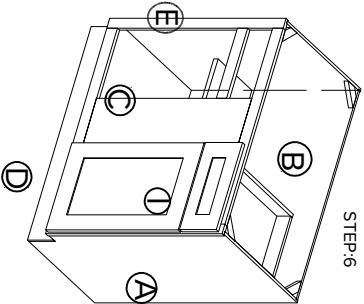

STEP7

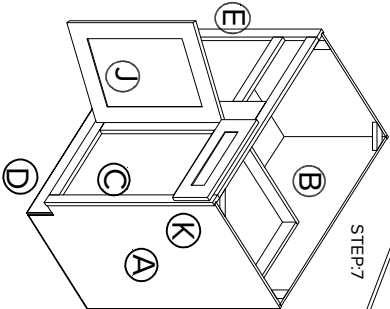

Full extension concealed drawer runners

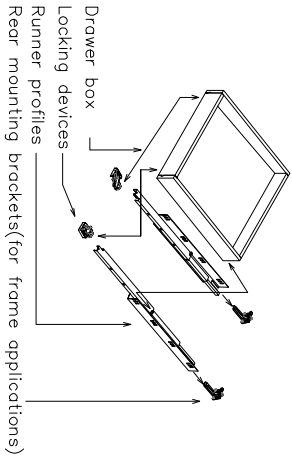

NO.	Description	QTY	PICTURE
11	SOFTCLOSE HINGE	2	
10	3/4" ROUND HEAD SCREW	2	
9	BUMPER	6	
8	1" ROUND HEAD SCREW	4	
7	Selfclose slider	1	
6	SHELF CLIP	4	
5	9/16"ROUND HEAD SCREW	44	
4	CLEAT	11	
3	TFLAT HEAD SCREW FOR CARCASS	5	
2	WOOD BLOCK	4	
1	1" FLAT HEAD SCREW FOR WOOD BLOCK	8	

HARDWARE LIST