

## FEATURES

- An attractive hinged pivot shower door with fixed panel features a special Nano Protected surface treatment that keeps glass looking clean.
- Can be trimmed up to 4" width adjustment.
- Door & fix panel are reversible.
- Walk-in opening: 24-3/4".
- The top rail is 304 Stainless Steel presenting a hardly there appearance.
- Two side wall profiles give up to 1/4" each side out of plumb (uneven wall) adjustment.
- Clearance height is 75-1/2" high.
- Tempered glass is ANSI Z97.1 certified.
- 3/8" (10mm) Glass thickness, available in Clear Glass.
- Hardware finishes: Polished Chrome, Brushed Stainless and Matte Black.
- Shower base threshold minimum requirement is 2" wide.
- Various handle selection of your choice.
- Easy to install.
- Limited Lifetime Warranty for residential and 1 year for commercial.
- **IMPORTANT!** All measurements should be taken only AFTER walls are finished (tile, back walls, etc.); Professional installation recommended.
- **Handles are not included. See the handle selection next page. Add the handle model no. to the shower door model no. to complete the order.**



## Specify Model

	SIZE	Model	Glass	Width	Height	Depth	Weight
<input type="checkbox"/>	60" x 76"	SMIPD607610C-	Clear (10mm)	59"	76"	1.6"	126
<input type="checkbox"/>	48" x 76"	SMIPD487610C-	Clear (10mm)	47"	76"	1.6"	156
<input type="checkbox"/>	36" x 76"	SMIPD367610C-	Clear (10mm)	35"	76"	1.6"	186

## To Be Specified: Color

<input type="checkbox"/>	<b>PC</b> Chrome
<input type="checkbox"/>	<b>BS</b> Brushed Stainless
<input type="checkbox"/>	<b>MB</b> Matte Black



Chrome



Brushed Stainless

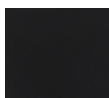

Matte Black

## To Be Specified: Glass

<input type="checkbox"/>	<b>C</b> Clear
--------------------------	----------------



Clear

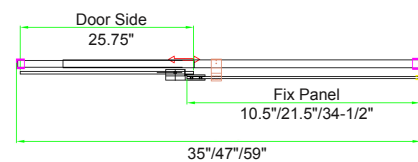
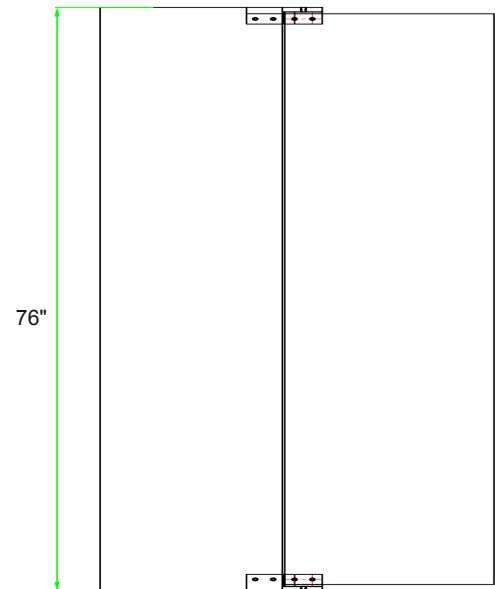

## FEATURES

- Handles are available in 3 distinctive series.
- Handle size is 19.69" (500mm) center hole to center hole.
- Finish: Polished Chrome (PC), Brushed Stainless (BS), Matte Black (MB) and Champagne Bronze (CB).
- Limited Lifetime Warranty for residential use and 1 year when used commercially.

## Pinnacle, Diamond & Meridian Series Shower Door Handles

Our extensive collection of high end handles add a distinctive look to your shower door and bathroom.

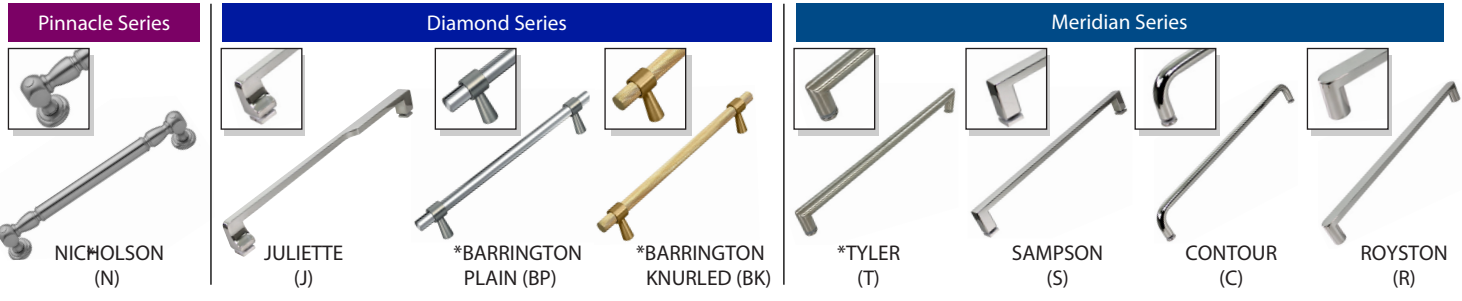

\* Matching grab bar available in different sizes.

### 1. Specify Model: Series & Style

Model	Style	Weight
-------	-------	--------

#### PINNACLE SERIES

<input type="checkbox"/>	SMPH-BPD-	Pinnacle <b>Bypass</b> Handles (Pair)	6 lbs.
<input type="checkbox"/>	SMPH-BND-D-	Pinnacle <b>Barn Door Double Sided</b>	6 lbs.
<input type="checkbox"/>	SMPH-BND-K-	Pinnacle <b>Barn Door Handle &amp; Knob</b>	4 lbs.

#### DIAMOND SERIES

<input type="checkbox"/>	SMDH-BPD-	Diamond <b>Bypass</b> Handles (Pair)	4 lbs.
<input type="checkbox"/>	SMDH-BND-D-	Diamond <b>Barn Door Double Sided</b>	3 lbs.
<input type="checkbox"/>	SMDH-BND-K-	Diamond <b>Barn Door Handle &amp; Knob</b>	2 lbs.

#### MERIDIAN SERIES

<input type="checkbox"/>	SMMH-BPD-	Meridian <b>Bypass</b> Handles (Pair)	4 lbs.
<input type="checkbox"/>	SMMH-BND-D-	Meridian <b>Barn Door Double Sided</b>	3 lbs.
<input type="checkbox"/>	SMMH-BND-K-	Meridian <b>Barn Door Handle &amp; Knob</b>	2 lbs.



Juliette Handle



Barn Door Double Sided



Barn Door Handle & Knob

### 2. To Be Specified: Handle Name

#### PINNACLE SERIES

☐ **N** Nicholson

#### DIAMOND SERIES

☐ **J** Juliette  
☐ **BP** \*Barrington Plain  
☐ **BK** \*Barrington Knurled

#### MERIDIAN SERIES

☐ **T** Tyler  
☐ **S** Sampson  
☐ **C** Contour  
☐ **R** Royston

### 3. To Be Specified : Color

☐ **PC** Polished Chrome  
☐ **BS** Brushed Stainless  
☐ **CB** Champagne Bronze  
☐ **MB** Matte Black

Chrome



Brushed Stainless



Champagne Bronze



Matte Black

\* **Barrington Plain** handles are only available in Chrome finish.

**Barrington Knurled** handles are available in Brushed Nickel, Matte Black and Champagne Bronze.