

SB24,SB27,SB30S
ASSE MBL Y INSTRUCTIONS

Getting started:

prepare a protection layer, a screwdriver

STEP 1: Joint side panel with back panel

STEP 2: Joint bottom panel with side panel

STEP 3: Joint side panel with bottom & back panel

STEP 4: Attach frame on and toe/kick board

STEP 5: Attach the wood block on the top corner and put on the adjustable shelf

STEP 6: Fix door&drawer head onto the frame and adjust the cover-space

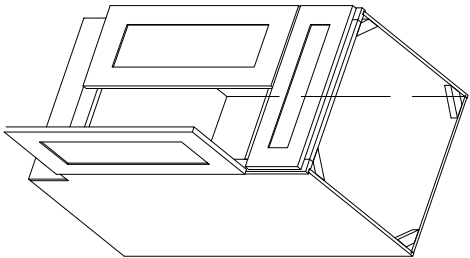

| PARTS LIST | | |
|------------|------------------|-----|
| NO. | Description | QTY |
| A | BACK PANEL | 1 |
| B | SIDE PANEL | 2 |
| C | TOP&BOTTOM PANEL | 1 |
| D | TOE KICK | 1 |
| E | FACE FRAME | 1 |
| F | CAB INETS DOOR | 2 |
| G | DRAWER HEAD | 1 |

| | | | |
|-----|------------------------------------|-----|---------|
| 8 | SOFTCLOSE HINGE | 4 | |
| 7 | 3/4" ROUND H EAD SCR EW 4 | | |
| 6 | BUMPER | 4 | |
| 5 | 9/16"ROUND HEAD SCR EW | 44 | |
| 4 | CLEAT | 11 | |
| 3 | 1"FLAT HEAD SCR EW FOR CARC ASS | 3 | |
| 2 | WOOD BLOCK | 4 | |
| 1 | 1" FLAT HEAD SCR EW FOR WOOD BLOCK | 8 | |
| NO. | Description | QTY | PICTURE |

