

# INSTALLATION STEPS SUPPORT BAR

	<b>1 Wall base</b>  X1	<b>2 Support bar</b>  X1	<b>3 Glass clips</b>  X1	<b>4 Screw ST4*35</b>  X1	<b>5 Anchor</b>  X1
---	---	---	---	--	--

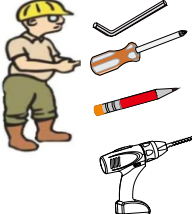
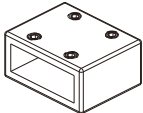
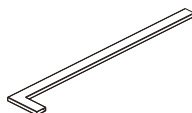
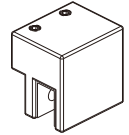
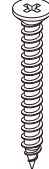
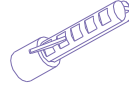
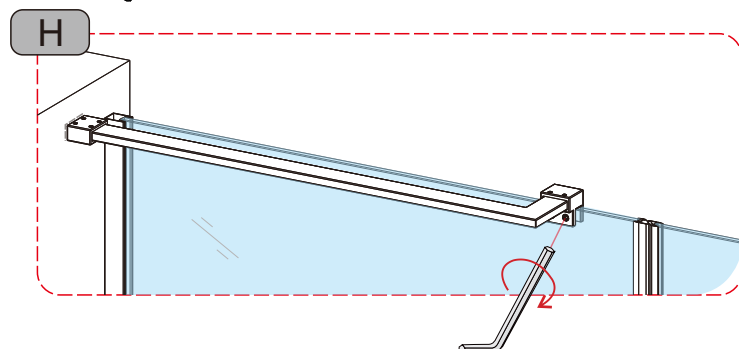
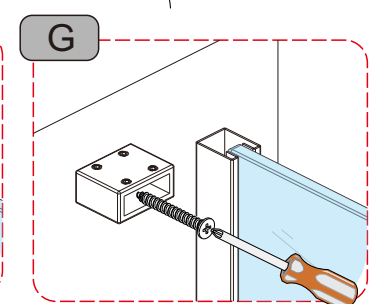
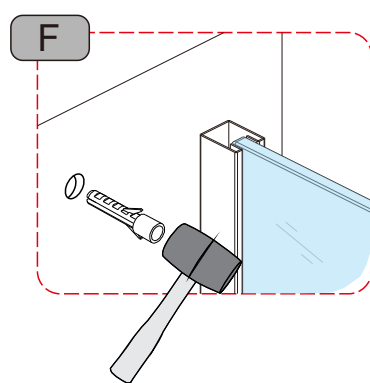
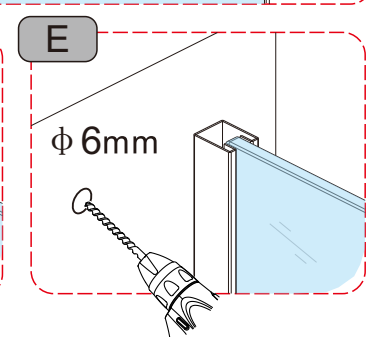
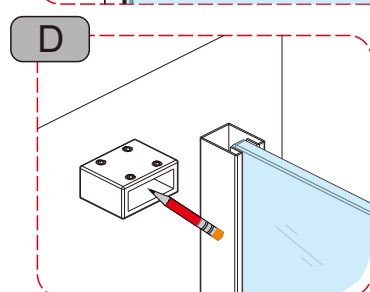
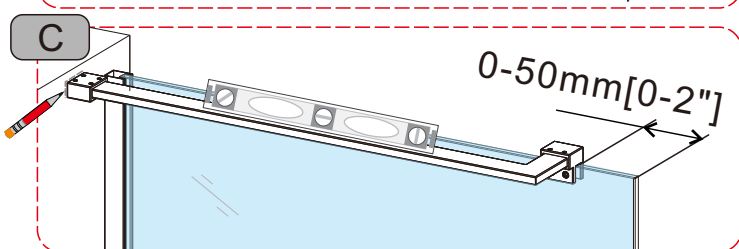
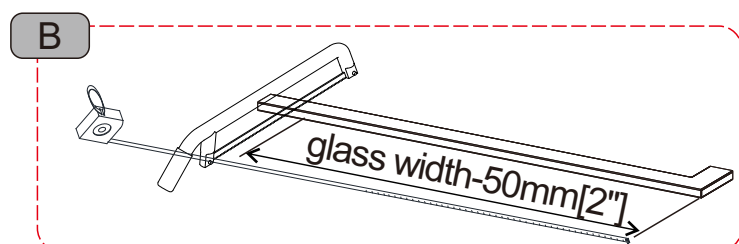
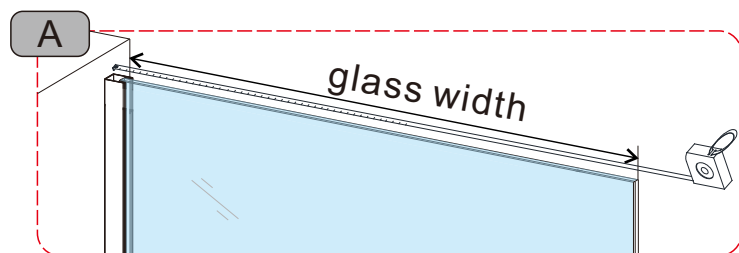

**Note:**

if fix glass size < 600mm[23 5/8"] = fix glass - 50mm[2"]

if fix glass size > 600mm[23 5/8"] no need cut the rod

