

## FEATURES

- Single threshold for alcove installation.
- Heavy duty integral 1" high tiling flange for a waterproof installation.
- 3" wide threshold as well as a 3" threshold height for a modern design.
- Designed for installation for a new or existing construction.
- Easy installation. Level with thinset mortar mix.
- 10 Year Limited Residential Warranty / 3 Year Commercial Warranty

## SMFL CLASSIC SHOWER BASES

- SMC sheet molding compound material is made from a composite material composed of resin, fiberglass, and stone filler. Compression molded solid surface for a precise radius and angles. It is strong, lightweight, slip resistant and scratch resistant.
- Features a stainless steel concealed drain removable cover that brings both a design element and comfort to your shower experience. Lift-off cover allows for easy cleaning. ABS drain is included.



Modern Slip Resistance with a light rectangular comfortable texture. Easy to clean as well as slip resistant.

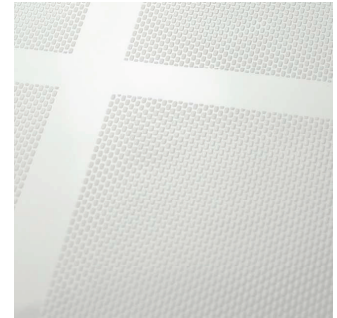

## Specify Model

SMFL Center Drain Shower Bases											
	Model	A	B	C	D	E	F	G	H	I	Wt.
<input type="checkbox"/>	SMFL6036C	36"	18.9"	17.1"	30"	60"	60"	57.7"	31.9"	36"	72
<input type="checkbox"/>	SMFL6034C	34"	19"	15"	30"	60"	60"	55.6"	29.8"	34"	67
<input type="checkbox"/>	SMFL6032C	32"	16.9"	15.1"	30"	60"	60"	57.7"	27.9"	32"	62
<input type="checkbox"/>	SMFL4836C	36"	18.9"	17.1"	24"	48"	48"	45.7"	31.9"	36"	52
<input type="checkbox"/>	SMFL4832C	32"	16.9"	15.1"	24"	48"	48"	46.2"	28.3"	32"	47

## To Be Specified: Color

<input type="checkbox"/>	31 White			
<input type="checkbox"/>	32 Cameo			
<input type="checkbox"/>	39 Grey			

White 31 Cameo 32 Grey 39

## Compliance Certifications - Meets or Exceeds the Following Specifications

- IGC 154-2012
- ASME A112.18.1 / CSA B125.125.1-11
- IAPMO 
- cUPC®

## SMFL Classic Linear Base

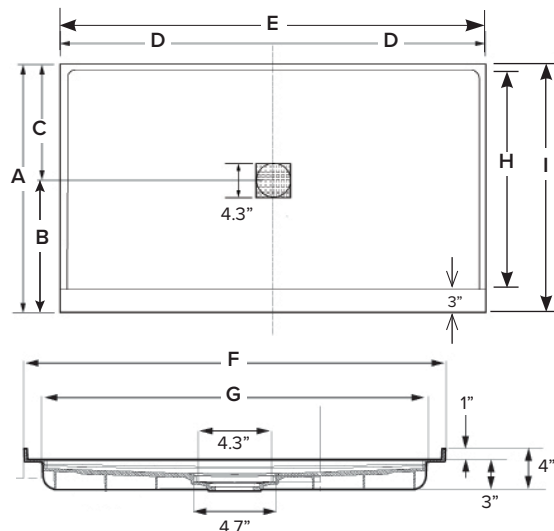

SHOWER BASES