

Features

- Heavy Duty SMC Sheet Molding Compound Material.
- Light weight. Natural stone effect.
- Bases can be custom sized within a range. See chart on next page for range sizing.
- 63" length bases or longer meets ADA requirements.
- Modern stainless steel drain cover conceals a conventional 2" shower drain (not supplied). Color-matched cover for SMFZS5140C, SMFZS6040C, SMFZS6340C and SMFZS7940C.
- Stock bases can be used as a Single, Double or Triple Threshold.
- The shower has an ultra-low 1" threshold front curb, making it easy to access. Once the underlayment and finished floor are installed, the entrance to the shower becomes virtually flush with the bathroom floor.
- The slate floor has a lightly textured and slip-resistant surface that makes it safe, yet remains easy to clean.
- 10 Year Limited Residential / 3 Year Commercial Warranty



Modern, low-profile design with a slate look and slip-resistant texture surface.

Stock Sized Specified Models

	Model No.	Length A	Width B	Height	Ctr C	Ctr D
<input type="checkbox"/>	SMFZS4836C	47.2"	35.5"	1.0"	23.6"	17.75"
<input type="checkbox"/>	SMFZS5140C	51.2"	39.4"	1.0"	25.6"	19.70"
<input type="checkbox"/>	SMFZS6032C	59.1"	31.5"	1.0"	29.55"	15.75"
<input type="checkbox"/>	SMFZS6036C	59.1"	35.5"	1.0"	29.55"	17.75"
<input type="checkbox"/>	SMFZS6040C	59.1"	39.4"	1.0"	29.55"	19.70"
<input type="checkbox"/>	SMFZS6042C	59.1"	41.5"	1.0"	29.55"	20.75"
<input type="checkbox"/>	SMFZS6048C	59.1"	47.5"	1.0"	29.55"	23.75"
<input type="checkbox"/>	SMFZS6332C*	63"	31.5"	1.0"	31.5"	15.75"
<input type="checkbox"/>	SMFZS6336C*	63"	35.5"	1.0"	31.5"	17.75"
<input type="checkbox"/>	SMFZS6340C*	63"	39.4"	1.0"	31.5"	19.70"
<input type="checkbox"/>	SMFZS6642C*	64.9"	41.5"	1.0"	32.45"	20.75"
<input type="checkbox"/>	SMFZS6648C*	64.9"	47.5"	1.0"	32.45"	23.75"
<input type="checkbox"/>	SMFZS6736C*	67"	35.5"	1.0"	33.5"	17.75"
<input type="checkbox"/>	SMFZS7236C*	70.9"	35.5"	1.0"	35.45"	17.75"
<input type="checkbox"/>	SMFZS7242C*	70.9"	41.5"	1.0"	35.45"	20.75"
<input type="checkbox"/>	SMFZS7248C*	70.9"	47.5"	1.0"	35.45"	23.75"
<input type="checkbox"/>	SMFZS7940C*	78.7"	39.4"	1.0"	39.35"	19.70"

* Meets ADA requirements.



Modern drain cover for 32C, 36C, 42C, & 48C widths



Slate-look slip-resistant texture



Matching drain for 40C widths

CUSTOMIZABLE BASE

Note: Bases can be built to accommodate unique sizes. Notches can also be cut from the bases to allow for columns in a corner.

Base can be built to custom sizes within certain limitations. Can be trimmed up to 4" in width from either side or up to 2" from depth. Base is designed to be used as a single, double or triple threshold in stock sizes and single or double threshold models in custom sizes.



<input type="checkbox"/>	31 White
<input type="checkbox"/>	32 Cameo
<input type="checkbox"/>	40 Dk Grey
<input type="checkbox"/>	09 Black



White 31



Cameo 32



Dark Grey 40



Black 09

Compliance Certifications

Meets or Exceeds the Following Specification

- IGC 154-2012
- ASME A112.18.1 / CSA B125.125.1-11
- IAPMO
- cUPC®

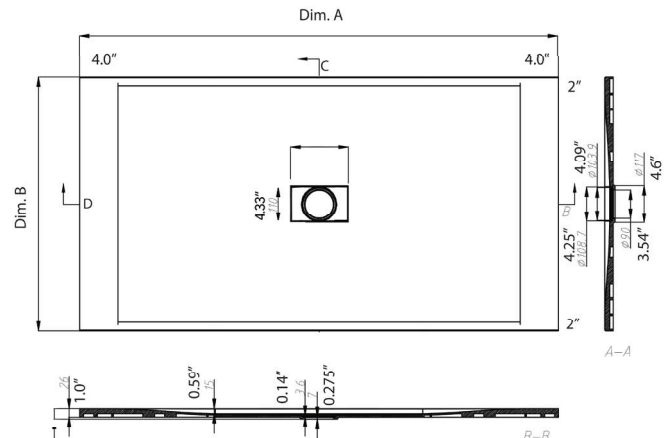

Features

- Heavy Duty SMC Sheet Molding Compound Material.
- Light weight. Natural stone effect.
- Bases can be custom sized within a range. See chart below for range sizing.
- 63" length bases or longer meets ADA requirements.
- Modern stainless steel drain cover conceals a conventional 2" shower drain (not supplied). Color-matched cover for SMCFZS5140C, SMCFZS6040C, SMCFZS6340C, and SMCFZS7940C.
- Stock bases can be used as a Single, Double or Triple Threshold.
- The shower has an ultra-low 1" threshold front curb, making it easy to access. Once the underlayment and finished floor are installed, the entrance to the shower becomes virtually flush with the bathroom floor.
- The slate floor has a lightly textured and slip-resistant surface that makes it safe, yet remains easy to clean.
- 10 Year Limited Residential / 3 Year Commercial Warranty



Modern, low-profile design with a slate look and slip-resistant texture surface.

Custom Sized Specified Models (specify length / depth) Can ONLY be used as a Single or Double Threshold base if custom

	Model No.	Max Lngth A	Min Lngth A	Max Depth B	Min Depth B
<input type="checkbox"/>	SMCFZS4836C	47.2"	39.2"	35.5"	33.5"
<input type="checkbox"/>	SMCFZS5140C	51.2"	43.2"	39.4"	37.5"
<input type="checkbox"/>	SMCFZS6032C	59.1"	51.1"	31.5"	29.5"
<input type="checkbox"/>	SMCFZS6036C	59.1"	51.1"	35.5"	33.5"
<input type="checkbox"/>	SMCFZS6040C	59.1"	51.1"	39.40"	37.4"
<input type="checkbox"/>	SMCFZS6042C	59.1"	51.1"	41.5"	39.5"
<input type="checkbox"/>	SMCFZS6048C	59.1"	51.1"	47.5"	45.5"
<input type="checkbox"/>	SMCFZS6332C*	63"	55"	31.5"	29.5"
<input type="checkbox"/>	SMCFZS6336C*	63"	55"	35.5"	33.5"
<input type="checkbox"/>	SMCFZS6340C*	63"	55"	39.4"	37.4"
<input type="checkbox"/>	SMCFZS6642C*	64.9"	56.9"	41.5"	39.5"
<input type="checkbox"/>	SMCFZS6648C*	64.9"	56.9"	47.5"	45.5"
<input type="checkbox"/>	SMCFZS6736C*	67"	59"	35.5"	33.5"
<input type="checkbox"/>	SMCFZS7236C*	70.9"	62.9"	35.5"	33.5"
<input type="checkbox"/>	SMCFZS7242C*	70.9"	62.9"	41.5"	39.5"
<input type="checkbox"/>	SMCFZS7248C*	70.9"	62.9"	47.5"	45.5"
<input type="checkbox"/>	SMCFZS7940C*	78.7"	70.7"	39.4"	37.4"

* Meets ADA requirements.



Modern drain cover for 32C, 36C, 42C, & 48C widths



Slate-look slip-resistant texture



Matching drain for 40C widths

CUSTOMIZABLE BASE

Note: Bases can be built to accommodate unique sizes. Notches can also be cut from the bases to allow for columns in a corner.

Base can be built to custom sizes within certain limitations. Can be trimmed up to 4" in width from either side or up to 2" from depth. Base is designed to be used as a single, double or triple threshold in stock sizes and single or double threshold models in custom sizes.

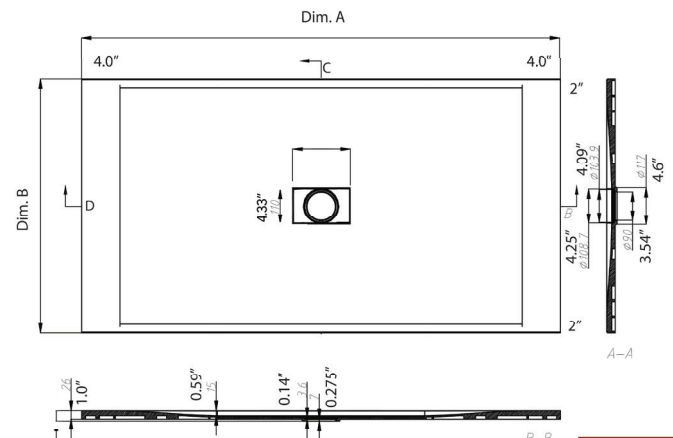

<input type="checkbox"/>	31 White
<input type="checkbox"/>	32 Cameo
<input type="checkbox"/>	40 Dk Grey
<input type="checkbox"/>	09 Black

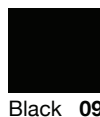
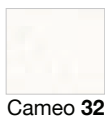

White 31

Cameo 32

Dark Grey 40

Black 09

Compliance Certifications

Meets or Exceeds the Following Specification

- IGC 154-2012
- ASME A112.18.1 / CSA B125.125.1-11
- IAPMO
- cUPC®