

**TRIM**

- Brass trim plate and handle
- 9" stainless steel shower arm
- 7" ABS round magnetic docking hand showerhead with 59" stainless steel shower hose
- 2.5 gpm
- ADA compliant lever handle

**VALVE**

- Pressure balance shower valve
- Single function
- Ceramic cartridge
- Solid brass body material
- Plastic built-in box
- Screw stop to adjust water flow rate
- 1/2" NPT male thread

**Warranty:** Limited Lifetime Residential /  
1-Year Limited Commercial

**SHOWER SET KIT COLORS**

<input type="checkbox"/>	<b>PC</b> Polished Chrome
<input type="checkbox"/>	<b>BN</b> Brushed Nickel
<input type="checkbox"/>	<b>MB</b> Matte Black



**INCLUDED SHOWER COMPONENTS:**

**PAX 3 Function Magnetic Docking Hand Shower SMMPMS3F-**

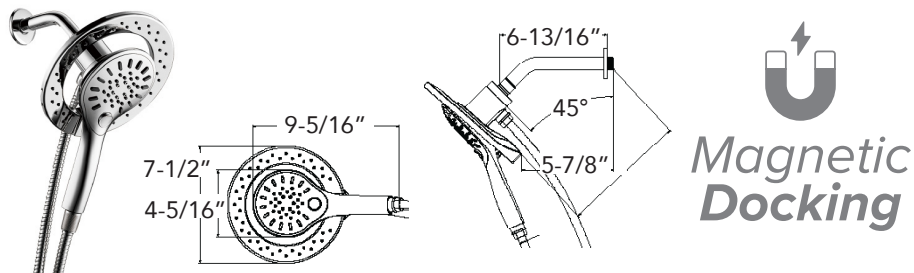

**THEO Single Function Pressure Balance Valve SMVTP1R-**

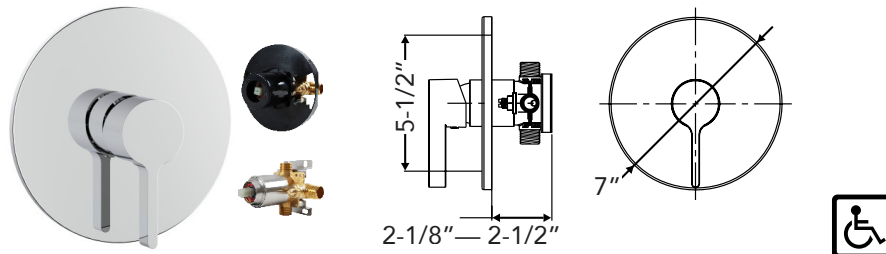

**BASIC 9" Shower Arm w/ Round Escutcheon SMBSA9R-**

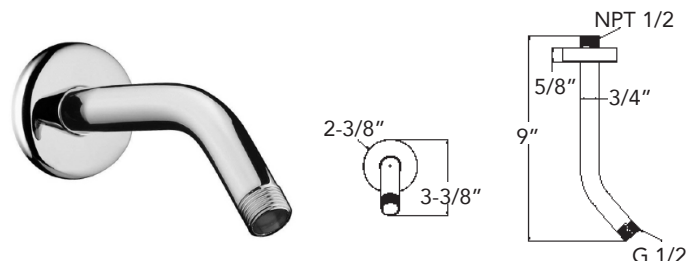

**Compliance Certifications-  
Meet or Exceed the Following Specifications**



Meets the Americans with Disabilities Act guidelines and ANSI A1171 requirements for accessible and usable building facilities-check local codes when installed per accessibility guidelines of the act.