

FEATURES

- Made of high-quality plywood, offering superior sturdiness and longevity.
- UV Coated Natural Interior
- Glue and Staple or Metal Clip Assembly
- Framed Cabinet with Full Overlay Doors and Drawer Fronts
- Remington Frame: 3" Wide
- Latitude Frame: 3/4" Wide
- Drawer Front: Five-Piece with 3/4" Thick Solid Birch Frame and 1/2" Thick MDF Center Panel
- Cabinet Face Frame: 1-1/2" Wide and 3/4" Thick Solid Birch
- Cabinet Box: 1/2" Thick Plywood with UV Coated Matching Exterior
- Door: Five-Piece with 3/4" Thick Solid Birch Frame and 1/4" Thick MDF Center Panel
- Hinges: Concealed Six-Way Adjustable European Style with Soft Close Features
- Toe Kick Panel: 1/2" Thick x 4-1/2" high finished plywood
- Has removable front
- Includes (1) 30" x 3/4" vanity filler
- Touch-Up Kit (SMTouchUpKIT) available to repair minor nicks and scratches (sold separately)



COLORS

- 3 colors available. White and Light Grey are both Painted colors. Tan Wood is a Stained Wood color.

WARRANTY

- 5-Year Limited Residential Warranty.

Vanity Models

	Model No.	Overall Size W x H x D	Door Dimensions	Drawer Front Dimensions	Ship Wt.(lbs)
REMINGTON CABINETS					
<input type="checkbox"/>	SMVS30-ADA-FR01	30" x 32 1/2" x 21"	14 3/4" x 20 1/2" x 3/4"	14 3/4" x 6 1/4" x 3/4"	106
<input type="checkbox"/>	SMVS36-ADA-FR01	36" x 32 1/2" x 21"	17 3/4" x 20 1/2" x 3/4"	17 3/4" x 6 1/4" x 3/4"	119
LATITUDE CABINETS					
<input type="checkbox"/>	SMVS30-ADA-FR02	30" x 32 1/2" x 21"	14 3/4" x 20 1/2" x 3/4"	14 3/4" x 6 1/4" x 3/4"	106
<input type="checkbox"/>	SMVS36-ADA-FR02	36" x 32 1/2" x 21"	17 3/4" x 20 1/2" x 3/4"	17 3/4" x 6 1/4" x 3/4"	119

Remington FR01

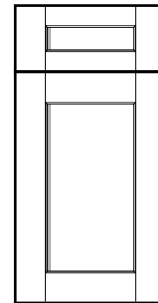

Latitude FR02

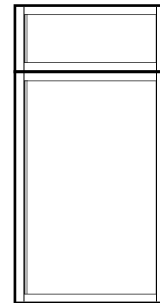

Cabinets available Assembled (ASM) and Ready to Assemble (RTA).
Add "ASM-" or "RTA-" to model number in front of "FR". Example: SMVS30-ADA-RTA-FR01-

VANITY COLOR OPTIONS			
<input type="checkbox"/>	TW Tan Wood	<input type="checkbox"/>	WH White
<input type="checkbox"/>	LG Light Grey		

Cabinet Colors:

