

**VS24,VS27,VS30S,VS33S**  
**ASSE MBL Y INSTUCTIONS**

Getting started:

prepare a protection layer, a screwdriver

STEP 1: Joint side panel with back panel

STEP 2: Joint bottom panel with side panel

STEP 3: Joint side panel with bottom & back panel

STEP 4: Attach frame on and toe/kick board

STEP 5: Attach the wood block on the top corner and put on the adjustable shelf

STEP 6: Fix door&drawer head onto the frame and adjust the cover-space

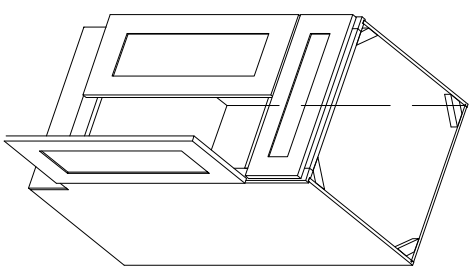

PARTS LIST		
NO.	Description	QTY
A	BACK PANEL	1
B	SIDE PANEL	2
C	TOP&BOTTOM PANEL	1
D	TOE KICK	1
E	FACE FRAME	1
F	CABINETS DOOR	2
G	DRAWER HEAD	1

NO.	Description	QTY	PICTURE
8	SOFTCLOSE HINGE	4	
7	3/4" ROUND HEAD SCREW	4	
6	BUMPER	4	
5	9/16"ROUND HEAD SCREW	44	
4	CLEAT	11	
3	1"FLAT HEAD SCREW FOR CARC ASS	3	
2	WOOD BLOCK	4	
1	1" FLAT HEAD SCREW FOR WOOD BLOCK	8	

