



# McAllister®

## 32" undermount double-bowl kitchen sink

### 32021

#### Features

- 36" (914 mm) minimum base cabinet width for undermount installation
- Double-equal bowls
- 5-1/2" (140 mm) depth
- No faucet holes; requires wall- or counter-mount faucet
- Rear drains increase workspace in the sink and storage space underneath
- Includes installation hardware
- Sink drain with strainer sold separately

#### Material

- Premium 18-gauge stainless steel

#### Installation

- Undermount

#### Recommended Products/Accessories

- K-23726 Drain treatment
- K-23729 Stainless steel cleaner
- 7400 Stainless Steel Sink Drain and Strainer



ADA

#### Codes/Standards

ASME A112.19.3/CSA B45.4  
ADA  
ICC/ANSI A117.1  
IAPMO Certification

#### STERLING® Stainless Steel Sinks

#### Lifetime Limited Warranty

See website for detailed warranty information.

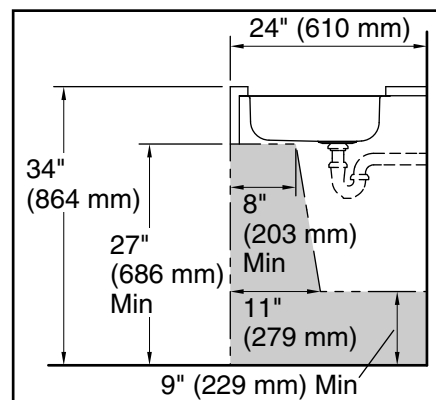
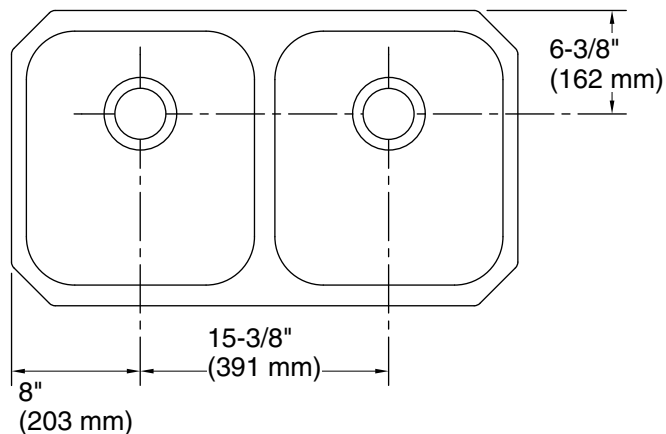

**Recommended ADA Installation**

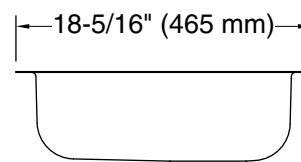
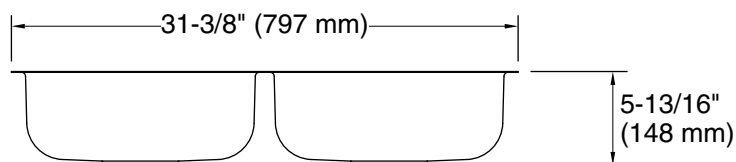

## Technical Information

All product dimensions are nominal.

Bowl configuration: Double equal

Min. base cabinet width: 36" (914 mm)

Bowl area (Left): Length: 15-3/4" (400 mm)  
Width: 14-1/8" (359 mm)  
Bowl depth: 5-1/2" (140 mm)  
Water depth: 5-1/2" (140 mm)

Bowl area (Right): Length: 15-3/4" (400 mm)  
Width: 14-1/8" (359 mm)  
Bowl depth: 5-1/2" (140 mm)  
Water depth: 5-1/2" (140 mm)

Drain hole: 3-5/8" (92 mm)

Template: Undermount, 1315846-7, required, included

## Notes

Install this product according to the installation instructions.

ADA compliant when installed to the specific requirements of these regulations.