



**GUARD+®**

60" x 42" shower base, center drain  
**95081**

### Features

- Low-threshold design for easy entry and exit
- Full-length water-containment guard and weep channels redirect water into the base, providing four-sided water containment
- Single threshold for alcove installation
- Molded-in textured floor
- Three-sided integral flange

### Material

- Acrylic

### Installation

- Center drain
- Alcove

### Recommended Products/Accessories

K-9132 Shower Drain  
K-23726 Drain treatment  
K-23732 Tub & shower cleaner



### Codes/Standards

CSA B45.5/IAPMO Z124  
ASTM E162  
ASTM E662  
IAPMO Certification

### STERLING® Vikrell® or Acrylic Baths and Shower Bases Ten-Year Limited Warranty

See website for detailed warranty information.

### Available Colors/Finishes

*Color tiles intended for reference only.*

Color	Code	Description
-------	------	-------------

	0	White
---	---	-------

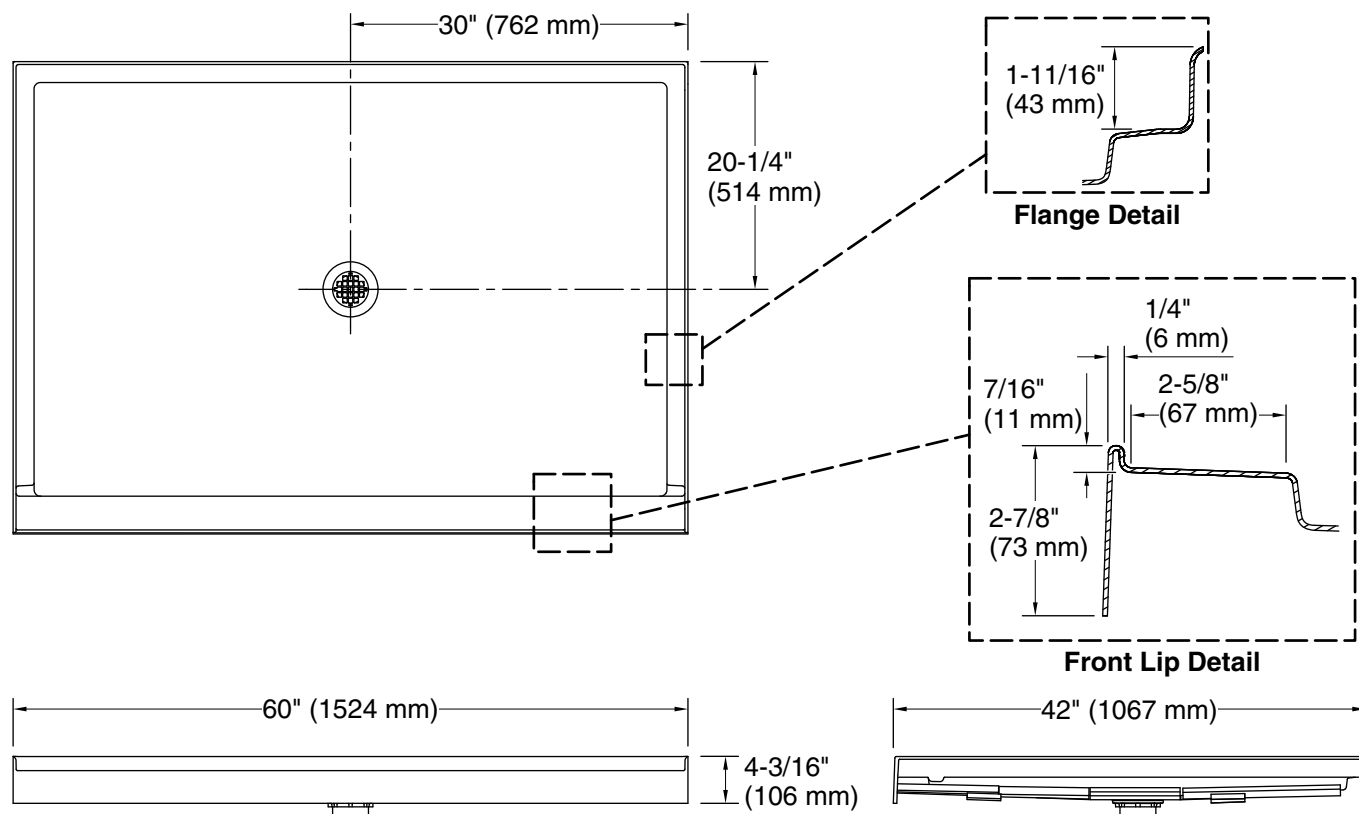

### Technical Information

All product dimensions are nominal.

Drain location: Center  
Weight: 56.2 lbs (25.5 kg)  
Minimum flat for door: 2-5/8" (67 mm)

### Notes

Install this product according to the installation instructions.

Subfloor must be within 1/2" (13 mm) of level.

This receptor has a front lip. This should be taken into account when installing a shower door.

Measure your actual product for rough-in details. If roughing-in prior to having product, stud opening to be 1/2" (12.7 mm) larger than product dimension.