

Quartz
Dual Mount
Undermount or
Drop-in Sink
Installation Guide
and Cutout Template
for:
QZDM-1816

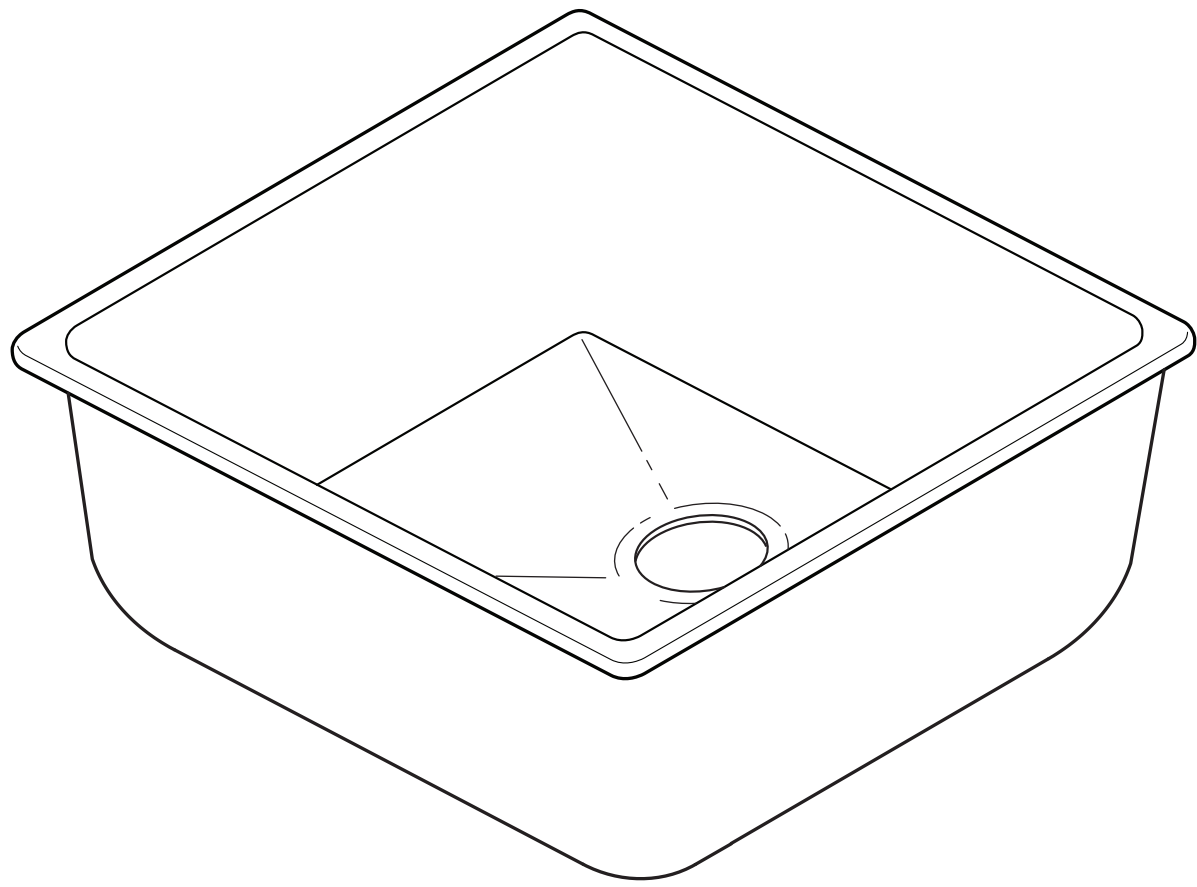

The Swan Assurance — if our product is properly installed and maintained, as stated in these instructions, it will not leak.

Remember –
Safety First

NOTICE

The Swan Corporation, the makers of the Swan products, cannot anticipate every possible circumstance that might involve a potential hazard during the installation of our product(s). The warnings and instructions in this installation guide are, therefore, not all-inclusive. If a tool, installation procedure, or work method that is not specifically recommended by The Swan Corporation is used, you must satisfy yourself that it is safe. You should also make sure that the Swan product(s) will not be damaged by the methods you choose. The Swan Corporation will not be held responsible for water damage of any kind in connection with the installation of one of our Swan bath/shower/panel kits.

WARNING

To avoid product damage, personal injury, or even possible death, carefully read, understand, and follow all the instructions in this installation guide before installing this product(s). Do not use cleaning fluids or operate power tools unless you read and understand the instructions and warnings in this and all other applicable labels or manuals. Proper use of tools and the products described in this guide is your responsibility.

WARRANTY

This product is covered by a Limited Lifetime Warranty. Refer to the Warranty section in this guide for complete details.

Save this instruction sheet/template for future reference.

Read and Understand the Guide. It is the responsibility of any individual who installs or maintains this product to fully understand and follow proper installation and maintenance procedures. Be aware of the inherent dangers in the use of power tools when installing this product. Read and understand all Warnings, Cautions, and Notices in this guide.

Disclaimer

- The information contained in this Installation Guide is given free of charge. It is based upon technical data which we believe to be reliable and is intended for use, by persons having knowledge of this technical area, at their own discretion and risk. Swan Corporation assumes no responsibility for results obtained or damage incurred from the use of this material either in whole or in part by the buyer.
- This guide will give you basic instructions for the installation of the product in a step-by-step sequence that will work in most types of installations. If you have an installation application that is not covered in this guide, please call your local Swan Corporation distributor or contact the Swan Corporation directly for additional information about your application.
- Follow all installation instructions. Failure to follow these instructions could result in personal injuries, water damage, or other damage to floors, pipes, walls, or other portions of your building or home.

Product Warnings
Safety Guidelines
Kit Contents
Required Tools
Preparation Tips
Installation Procedure
Cleaning & Maintenance
Surface Repair
Warranty Information
Sink Cutout Template

SAFETY

NOTICE

Work Safely
DO NOT proceed if any doubt arises about the correct or safe method of performing anything found in this or other Swan Corporation manuals. The installation of this product can require using power tools. Do not use power tools without adequate training. If necessary, hire or consult a trained professional for expert assistance before continuing.

Use Proper Tools
Always use proper tools which are in good, working condition during the installation of the Swanstone products. Using tools other than those listed could adversely affect the integrity of floors, pipes, walls, or this product and could result in water damage or other damage to floors, pipes, walls, or other portions of your building or home.

CAUTION

Use Proper Installation Methods
Follow all instructions related to sink preparation. Failure to follow these instructions could result in water damage.

Tripping Hazard
Personal injury can result from tripping over power cords, tools, or other items. DO NOT leave items laying around the work area.

Personal Protection
Be sure to use all personal protective equipment, such as sturdy work boots, preferably with steel toes, gloves, and hard hat, if necessary, to ensure your own safety. To prevent possible damage to your hearing, always wear ear protection, such as earmuffs or earplugs, when working around power tools.

Cutting Hazard
The installation of the Swanstone product may require using power tools. Keep hands away from the cutting edge of any tool used in the installation of our product. Placing fingers in or around the cutting blades could result in serious personal injury.

Sharp Edge Hazard
After cutting the opening for the drop-in sink, the countertop edge can be sharp. Wear protective gloves to prevent personal injury.

Room Temperature
Allow the Swanstone sink and silicone sealants to adjust to room temperature for at least six hours before installation. The product should not be installed at temperatures below 65°F.

Mounting the Sink (Undermount)

- Locate and drill eight 1/4" (6 mm) holes 5/16" (7 mm) deep from the underside of the countertop. The holes should be located approximately 1" (25 mm) from each corner and approximately 1-1/2" (45 mm) from the edge, as shown.

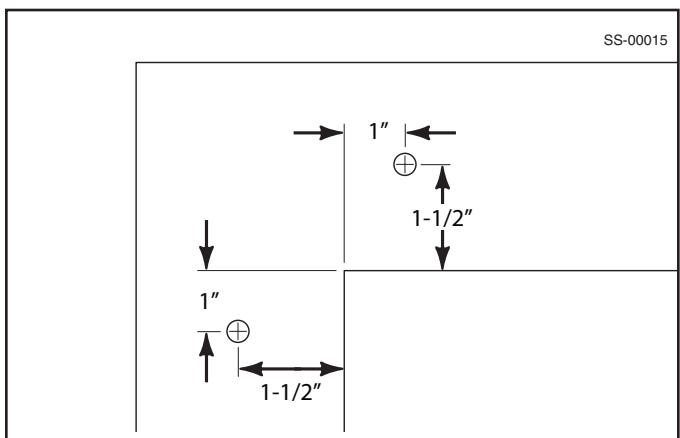
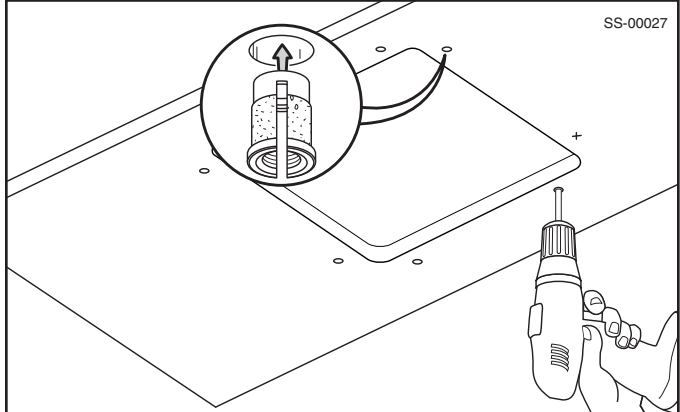

NOTICE

Be careful not to drill through the countertop when drilling the holes for the inserts.

- Insert the brass inserts into the holes.

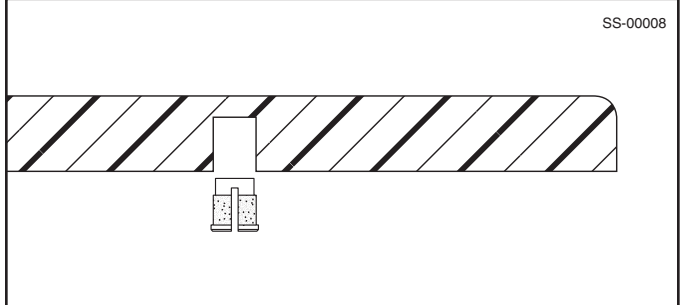

- Clean the mating surfaces of the countertop and sink with denatured alcohol. Remove all dust and allow the surface to dry completely. Refer to the safety instructions above for the safe use of cleaning solvents.

- Install the screws, wing nuts, and washers, as shown.

NOTICE
Do not overtighten the screws in the threaded inserts. Overtightening may crack or deform the solid surface or stone material.

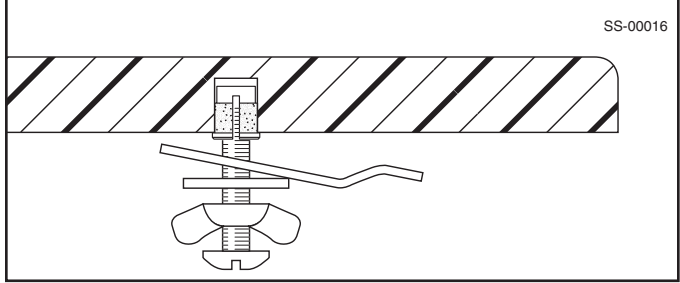

- Trial fit the sink to check for proper fit.
- Apply a bead of silicone (not included) to the top side of the sink flange and place the sink in the opening.

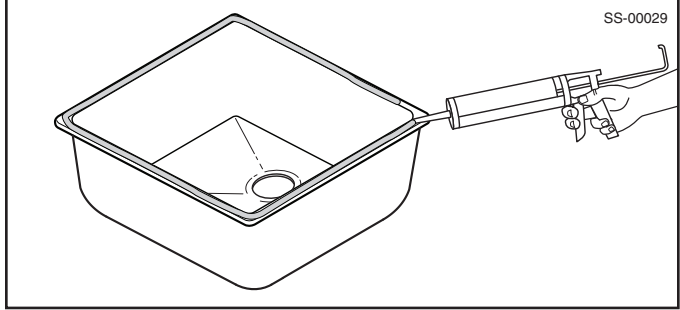

GENERAL INFORMATION

Contents

Confirm that the sink is not damaged and the mounting hardware is included before beginning installation.

QZDM-1816 — 16" x 18" Quartz Composite, Undermount or Drop-in Single Bowl Sink with mounting hardware.

Unpack Carton

- Use care when opening the box not to damage the sink.
- This product is shipped to you or your retail center after careful inspection. After purchasing the sink, carefully unpack and inspect the product for any shipping damage that may have occurred. If damage is found, report it immediately to the store of purchase. After inspection and during installation, protect the products from construction damage by moving them to another room or area until ready to install.
- Please use the model number located on the side of the box, or the front of this guide, when contacting us with questions concerning the installation of this unit.
- Make sure the sink is the correct size and in good condition. Installation of damaged product will void the warranty.

Helpful Hints

- Read these instructions carefully and familiarize yourself with the various parts of the sink.
- The variety of installations possible for this sink may require procedures other than those shown.
- Allow sufficient time for the sink to adjust to room temperature. We do not recommend installation of this product at temperatures below 65 degrees.
- Store unused materials away from the work area to prevent accidental damage.
- Turn off the hot and cold water supply before starting the installation.

INSTALLATION PROCEDURE

Required Tools

- Safety Glasses
- Ruler/Tape Measure
- Drill and 1/2" (Drop-in) or 3/4" Drill Bit (Undermount)
- 1-3/8" Hole Saw (if faucet cutouts are required)
- Saber Saw* (if laminated counter top cutout is required)
- Dust Mask
- Screwdriver
- Caulking Gun
- Silicone
- Denatured Alcohol

* When mounting the sink into solid surface material or stone, use the appropriate tools for cutting the chosen type of material.

Drop-In Installation Method

- Invert the sink and position it onto the countertop. Locate sink front-to-rear and right-to-left so the bowl will not interfere with the cabinets below.

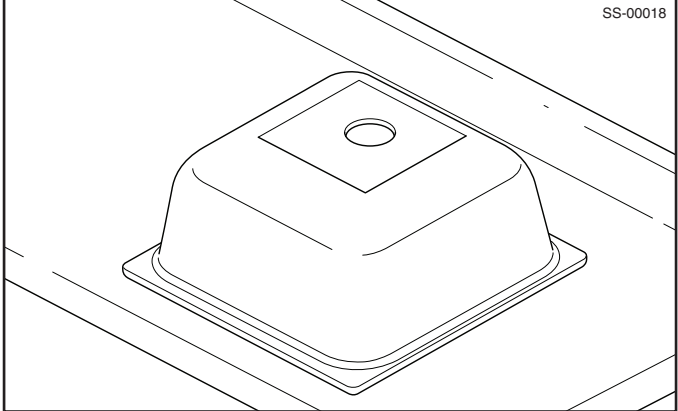

- Trace a pencil line around the outside edge of the sink and remove the sink from the countertop.

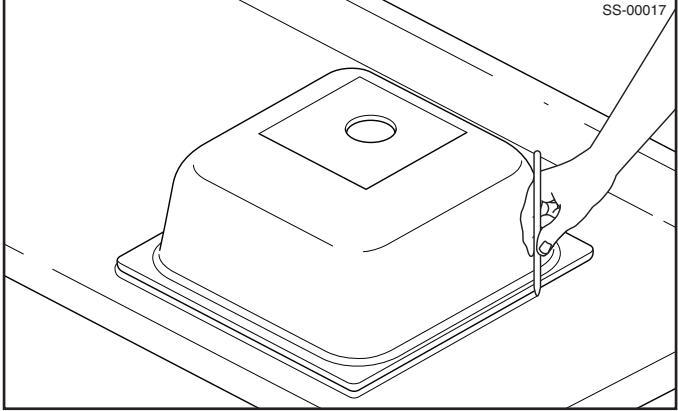

- Measure and mark a line 3/8" (9.5 mm) inside the initial sink outline and draw a second line inside of the first. Draw a 1/4" (6 mm) radius at each corner. The second inside line will be the cutout line.

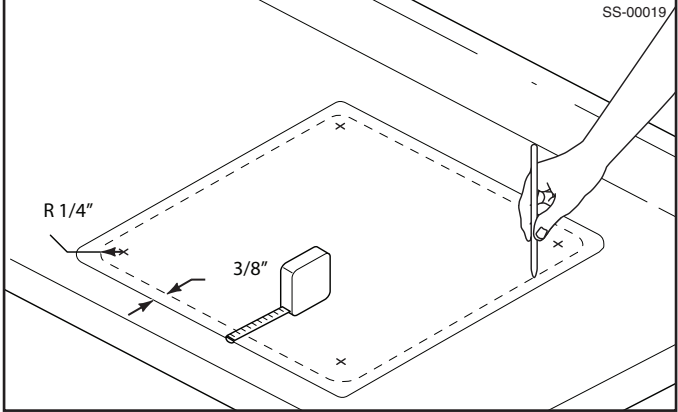

- Drill a 1/2" hole inside of the cutout line in all four corners. Refer to the safety instructions above for the safe use of power tools.

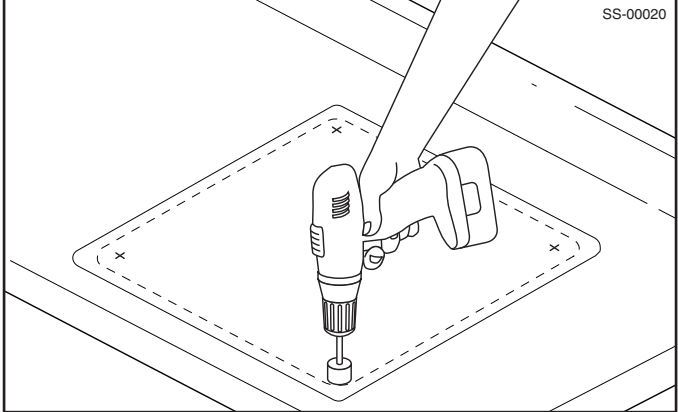

- Cut the opening in the countertop following the inside pencil line. Trial fit the sink to check for proper fit.

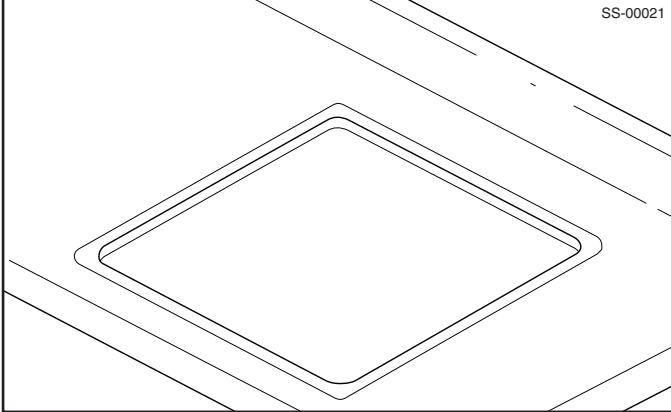

- Clean the mating surfaces of the countertop and sink with denatured alcohol to remove the pencil line and any dust from the cutting operation. Remove all dust and allow the surface to dry completely. Refer to the safety instructions above for the safe use of cleaning solvents.

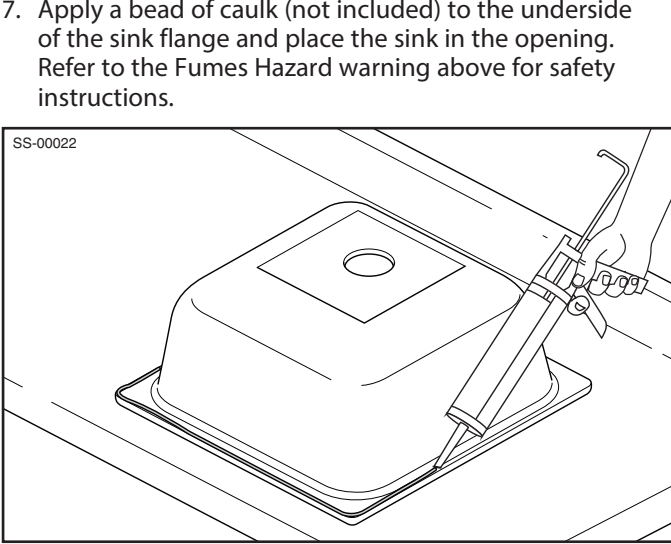

- Position the sink in the opening. Do not move the sink until the silicone is set. No mechanical hardware is necessary for this type of installation.

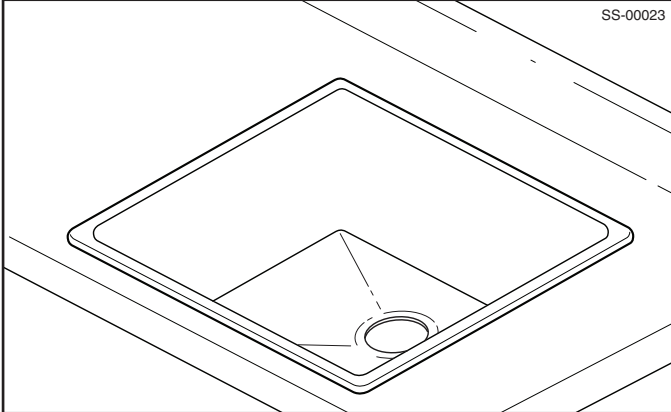

Undermount Installation Method

This procedure and template (dashed line on this sheet) provides instructions for under-mounting the quartz sink directly to a solid surface or stone countertop. The rim of an under-mounted sink will have a 1/8" recess under the countertop when using this template.

- If working from the underside of the countertop, cover the work table with a clean drop cloth, thin foam pad, or corrugated cardboard to prevent damaging the countertop's surface.



This cutout template (inside the dashed lines) will create an opening for undermount sinks of 14-3/16" x 16-3/16" with an overhang of approximately 1/8" (3 mm) using the inside of the line. We strongly recommended that you make sure this overhang will provide the desired appearance for your customer. Swan Corporation is not responsible for improper sink or countertop installations.

Sink template for:
QZDM-1816

Save these Installation Instructions for future reference. They provide important information on cleaning, maintenance, and surface repair of the Swanstone Products.

WARNING

Eye Protection
Be sure to use all personal protective equipment to ensure your own safety. To avoid eye injury, always wear protective glasses with side shields when using power tools. Also, make sure no one else can be injured by flying particles when using power tools.

Fire Hazard
Personal injury or death can result from a fire caused by flammable liquids or silicone sealants. Cleaners or solvents can be highly explosive, resulting in personal injury or even death, when not used properly. Clean up any flammable substance immediately. Sparks or open flames can cause flammable substances to ignite. DO NOT smoke while working on or near any flammable substance.

Fumes Hazard
Follow all manufacturers' safety instructions for silicone sealants and denatured alcohol. Alcohol vapors are both flammable and hazardous to breathe. Silicone vapors may irritate eyes and nose. Personal injury can result from improperly handling or use of products, such as denatured alcohol. Always follow the manufacturer's recommendations for the safe use of these products. Ventilate any work area before beginning to apply silicone sealants, cleaning agents, or solvents. To keep the area well-ventilated, open windows and use exhaust fans. If adequate ventilation is not achievable or practical, use respiratory protective equipment.

Power Tool Hazard
To prevent personal injury or possible death, always follow the electrical safety recommendations of the power tool's manufacturer. Do not use power tools in an unsafe manner. Power tools should only be connected to a circuit protected by a ground-fault circuit interrupter (GFI).

WARNING

Breathing Hazard
When cutting or drilling, use a dust collection method which prevents dust particles from going into the air. Always work in a well-ventilated area. To keep the area well ventilated, open windows and use exhaust fans. Always use an OSHA approved dust mask when cutting, drilling, or sanding.

Shock Hazard
Never use electric power tools around water, condensation, or other liquids. Electric shock can cause severe burns, significant injuries, and even death. If an extension cord is required, always use an OSHA approved extension cord. Power cords should only be connected to a circuit protected by a ground-fault circuit interrupter (GFI).

Electrical Shock Hazard
Contacting live electrical wiring with power tools or hand tools can cause serious injury or death. Make sure all related circuit breakers are turned OFF. Test for live circuits or wiring inside any wall where installation of the Swanstone product requires cutting into a wall.

Electrocution Hazard
Water and other liquids conduct electric current and can create a short circuit, resulting in injury or death. Keep all liquids away from electrical cords and power tools. DO NOT create a short circuit between a source of electricity and a liquid by being in contact with both simultaneously.

RECOMMENDATIONS FOR PROPER MAINTENANCE

General Maintenance

- Several times a month, use a stone cleaner and polisher designed for quartz sinks to brighten the stone's natural color while maintaining its finish.
- To help prevent staining from occurring, wipe a coat of Stone Sealer designed for quartz sinks over the surface yearly.

Hard Water, Calcium, Lime, and Rust Stains

- Use vinegar or a commercial lime and rust remover.
- With vinegar, dilute 50% with water and let it soak into the affected areas for 20 minutes. Rinse thoroughly; then dry.
- With a commercial lime and rust remover, follow the directions for use on the packaging, then rinse sink thoroughly and dry. Do this whenever necessary.

Stubborn Stains

- Mix 1 part household bleach with 15 parts water and let the solution soak in the sink for 1 hour. Do not use undiluted chlorine in the sink. Drain, rinse thoroughly, and dry. Do this whenever necessary.

Things to Avoid

- Do not place hot pans or skillets in the sink or items that may scratch the surface.
- Do not use the inside of the sink as a cutting surface.
- Many common foods and drinks contain acids which can etch or dull the sink surface. Do not allow this type of food/liquid to dry onto the sink's surface.
- Staining liquids, such as dyes and vegetable juices, should be rinsed with water immediately.
- Do not allow liquid soap or other household cleansers to dry on the surface of the sink. Most brands contain chemical additives which will affect the surface finish.
- Do not allow standing water in the sink; it causes a build-up of mineral deposits, which can affect the appearance of your sink.
- Do not leave rubber mats, sponges, cloths, or cleaning pads laying in the sink as they can cause surface discoloration.
- Do not clean the sink with harsh abrasive powders, scouring pads, rough sponges, or steel wool. Scratches from this type of cleaning can make the sink more prone to future stains.
- Do not use strong alkalis such as ammonia, caustic soda solutions, or any drain cleaning products containing acid. Silver cleaners can also contain acids that may damage the sink surface. Also avoid drain unclogging chemicals which require the sink to be filled with the water/chemical solution.

WARRANTY

If a Swan product covered by this warranty is found to be defective in materials or workmanship, after inspection by an authorized Swan Corporation representative, we will repair, or at our option, exchange the product for a similar model. This warranty extends for a designated period of time, so long as it remains in use in its original place of installation.

This warranty covers products installed in accordance with the Swan Corporation's installation instructions, used as recommended, and not damaged due to misuse, abuse, or improper installation. It does not apply to any seams or changes made to the product by professional tradesmen or fabricators.

The Swan Corporation's option to repair or exchange the products under this warranty does not cover any labor or other costs of removal or installation, nor shall the Swan Corporation be responsible for any other incidental or consequential damages attributable to a product defect or to the repair or exchange of a defective product.

Residential Limited Lifetime Warranty

The warranty applies only to the original purchaser and installation of these products in residential applications. It does not apply to commercial applications.

Commercial 10-Year Limited Warranty

The warranty applies only to the original purchaser and installation of these products in commercial applications.



The Swan Corporation — Swanstone
www.swanstone.com
800-325-7008 Form #780-04-2014