

STS-3738 Swanstone Transfer Shower Floors

With Fit-Flo™ Drain



Manufactured from Swanstone Solid Surface

Recommended for high-use traffic areas and commercial surfaces.

FEATURES

- Reinforced solid surface means color and texture run all the way through and cannot wear away.
- Will not mold or mildew, no grout to clean.
- Coordinates with Swanstone shower and bath systems.
- "S" pattern molded into floor provides a slip-resistant surface.

Model	A	B	C	D
STS-3738	38"	37"	19"	18"

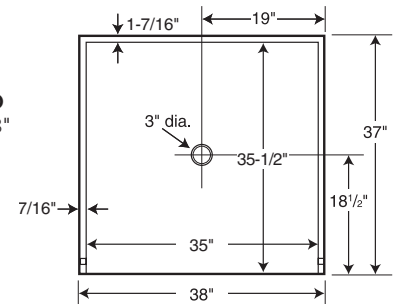

Model	Nominal Size	Rough-In Dimensions			
		A	B	C	D
STS-3738	37" x 38"	38 3/8"	37 3/16"	19 3/16"	18 9/16"

IMPORTANT: Rough-in dimensions are provided for reference only. You must measure the actual shower pan and check local building code requirements before construction of the stud wall.

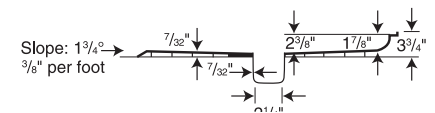

SPECIFICATIONS

Model	Part	Ship Wt. Lb.	Carton Dims. In.	Cu. Ft.
STS-3738	SF03738MD	46	45 x 43 x 10	12

Includes: One code-approved compression-molded Swanstone pan with molded-in Fit-Flo drain.

Packaging: Each pan packed in a rectangular carton.

COLORS

Solid Colors:

- White (010)
- Bisque (018)
- Bone (037)

Aggregate Colors:

- Bermuda Sand (040)
- Black Galaxy (015)
- Carrara (221)
- Concrete Ash Gray (203)
- Concrete Birch (226)
- Concrete Charcoal Gray (209)
- Concrete Clay (212)
- Concrete Limestone (218)
- Concrete Sandstone (215)
- Ice (130)
- Tahiti White (011)

STANDARDS AND RATINGS

American National Standard Institute—ANSI Z124.1.2

International Association of Plumbing and Mechanical Officials (IAPMO)—Listed

CSA Standard B45.5 by IAPMO

Uniform Plumbing Code (UPC)

For a complete list of tests and results see the Technical Data Sheet.

MAINTENANCE AND CLEANING INFORMATION

Clean regularly with common household liquid cleaners and a sponge or soft cloth. For hard water stains, scale removers can be used. If necessary, abrasive cleaners can be used with a nylon brush or pad to remove build up on the shower pan surface. **Do not** use a metal-scouring pad or a wire brush, as it will damage the surface. **Do not** use "leave on" cleaning products, such as automatic spray shower cleaners. Prolonged contact with harsh chemicals could have an adverse reaction over time and discolor surfaces. **Do not** use cleaning agents that caution use on acrylic, polyester or plastics.

SUPPORT DOCUMENTS

Installation instructions available at swanstone.com.

