

Features

- Heavy Duty SMC Sheet Molding Compound Material
- Light weight. Natural stone effect.
- 63" length bases or longer meet ADA requirements.
- Bases can be custom sized within a range. See chart below for range sizing.
- SMC color-matched drain cover conceals a conventional 2" shower drain (not supplied).
- Stock bases can be used as a Single, Double or Triple Threshold.
- The shower has an ultra-low 1" threshold front curb, making it easy to access. Once the underlayment and finished floor are installed, the entrance to the shower becomes virtually flush with the bathroom floor.
- The slate floor has a lightly textured and slip-resistant surface that makes it safe, yet remains easy to clean.
- 13-3/4" center drain location for FZS and CFZS models. 8-1/2" center drain location for FZSR models provides a direct replacement for an existing bathtub.
- 10 Year Limited Residential / 3 Year Commercial Warranty

Stock Sized Specified Models

	Model No.	Length A	Width B	Height
<input type="checkbox"/>	**FZS6032R/L	59.1"	31.5"	1.0"
<input type="checkbox"/>	**FZS6036R/L	59.1"	35.5"	1.0"
<input type="checkbox"/>	**FZS6332R/L*	63"	31.5"	1.0"
<input type="checkbox"/>	**FZS6336R/L*	63"	35.5"	1.0"
<input type="checkbox"/>	FZS6736R/L*	67"	35.5"	1.0"
<input type="checkbox"/>	FZS7236R/L*	70.9"	35.5"	1.0"
<input type="checkbox"/>	FZSR6032R/L	59.1"	31.5"	1.0"
<input type="checkbox"/>	FZSR6036R/L	59.1"	35.5"	1.0"
<input type="checkbox"/>	FZSR6332R/L*	63"	31.5"	1.0"
<input type="checkbox"/>	FZSR6336R/L*	63"	35.5"	1.0"

** Limited Availability



* Meets ADA requirements.

Custom Sized Models (Specify Lgth, Depth, RH or LH) can only be used as a Single or Double Threshold

	Model No.	Max Lgth A	Min Lgth A	Max Depth B	Min Depth B
<input type="checkbox"/>	**CFZS6032R/L	59.1"	55.1"	31.5"	29.5"
<input type="checkbox"/>	**CFZS6036R/L	59.1"	55.1"	35.5"	33.5"
<input type="checkbox"/>	**CFZS6332R/L*	63"	59"	31.5"	29.5"
<input type="checkbox"/>	**CFZS6336R/L*	63"	59"	35.5"	33.5"
<input type="checkbox"/>	CFZS6736R/L*	67"	63"	35.5"	33.5"
<input type="checkbox"/>	CFZS7236R/L*	70.9"	66.9"	35.5"	33.5"

* Meets ADA requirements.

To Be Specified: Color

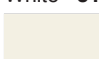
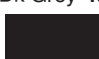
<input type="checkbox"/>	31 White		White 31		Dk Grey 40
<input type="checkbox"/>	32 Cameo		Cameo 32		Black 09
<input type="checkbox"/>	40 Dark Grey				
<input type="checkbox"/>	09 Black				

Meets or Exceeds the Following Specification

• ASME A112.18.1 / CSA B125.125.1-11

• IGC 154-2012 • cUPC® • IAPMO 

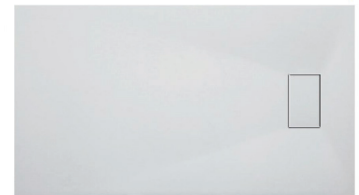
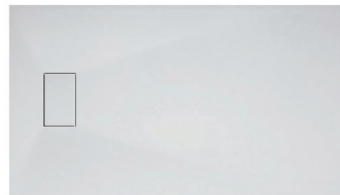

Modern Slip Resistance with a stone look texture. Easy to clean as well as slip resistant.



CUSTOMIZABLE BASE

Note: Bases can be built to accommodate unique sizes. Notches can also be cut from the bases to allow for columns in a corner.

Base can be built to custom sizes within certain limitations. Can be trimmed up to 4" in width from side opposite drain or up to 2" from depth. Base is designed to be used as a single, double or triple threshold in stock sizes and single or double threshold models in custom sizes.

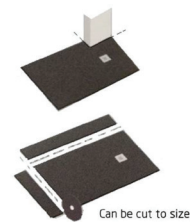

Can be cut to size

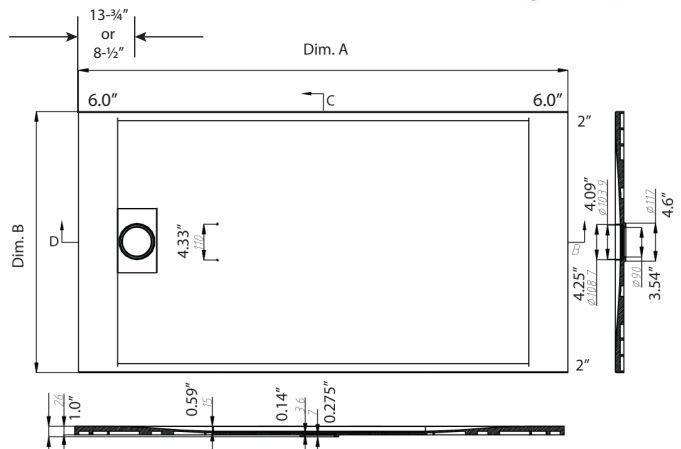

SHOWER BASES