

## FEATURES

- Silhouette Walls for new or existing construction.
- Thick 5mm Expressions® compression molded solid surface material for superior strength, beauty and easy cleaning. Surface will not support bacteria growth.
- Easier to install than tile. Walls glue right over existing surface. Walls have a beveled outside edge and are trimmable for custom fit.
- EWK Wall Kits include three wall panels, two color coordinated inside corner trim pieces.
- EWKX Wall kits include three 72" / 84"H wall panels, two color coordinated inside corner trim pieces, SMPTK seam trim kit and extension wall kit that adds up to an additional 24" / 12" in height.
- Solid color/pattern wall kits included 2 end wall in a solid color (White, Cameo/Biscuit or Grey) and back wall in pattern color (Bianca, Sorento, Sea Fog, Bleached Oak, and Houndstooth).
- EWK603272 only available in 31 White and 41 Bianca.
- 10 Year Limited Residential Warranty / 3 Year Commercial Warranty

## COLOR

- 3 Solid colors and 5 Pattern colors.

## OPTIONS

- Storage pods & caddies, grab bars, storage shelves, shower seats & benches are available to coordinate with the walls.

## RECOMMENDED ADHESIVE *(sold separately)*

- 72" Kits: (3) T100 clear & (2) T200 color-matched, mildew-resistant silicone
- 96" Kits: (2) T200 color-matched, mildew-resistant silicone

## Specified Model:

	SIZE	MODEL NO.	Width	Depth	Height	Weight(lbs)
<b>SHOWER WALL KITS 72"</b>						
<input type="checkbox"/>	36" x 36" x 72"	EWK363672	36"	36"	72"	156
<input type="checkbox"/>	48" x 36" x 72"	EWK483672	48"	36"	72"	168
<input type="checkbox"/>	48" x 48" x 72"	EWK484872	48"	48"	72"	171
<input type="checkbox"/>	60" x 32" x 72"	EWK603272	60"	32"	72"	185
<input type="checkbox"/>	60" x 36" x 72"	EWK603672	60"	36"	72"	190
<input type="checkbox"/>	60" x 48" x 72"	EWK604872	60"	48"	72"	210
<input type="checkbox"/>	60" x 60" x 72"	EWK606072	60"	60"	72"	240
<b>SHOWER WALL KITS 96"</b>						
<input type="checkbox"/>	36" x 36" x 96"	EWK363696	36"	36"	96"	193
<input type="checkbox"/>	48" x 36" x 96"	EWK483696	48"	36"	96"	223
<input type="checkbox"/>	48" x 48" x 96"	EWK484896	48"	48"	96"	228
<input type="checkbox"/>	60" x 36" x 96"	EWK603696	60"	36"	96"	252
<input type="checkbox"/>	60" x 48" x 96"	EWK604896	60"	48"	96"	280
<input type="checkbox"/>	60" x 60" x 96"	EWK606096	60"	60"	96"	320

## To Be Specified : Color

	Shower Walls Solid Colors	Color-Coordinated Inside Corner Trim
<input type="checkbox"/>	31 White	31 White
<input type="checkbox"/>	32 Cameo/Biscuit	32 Cameo/Biscuit
<input type="checkbox"/>	39 Grey	39 Grey

	Pattern Colors	Inside Corner Trim
<input type="checkbox"/>	41 Bianca	31 White
<input type="checkbox"/>	43 Sorento	32 Cameo/Biscuit
<input type="checkbox"/>	44 Sea Fog	39 Grey
<input type="checkbox"/>	45 Bleached Oak	32 Cameo/Biscuit
<input type="checkbox"/>	46 Houndstooth	32 Cameo/Biscuit



EWK603296 shown with FLU6032L Shower Base

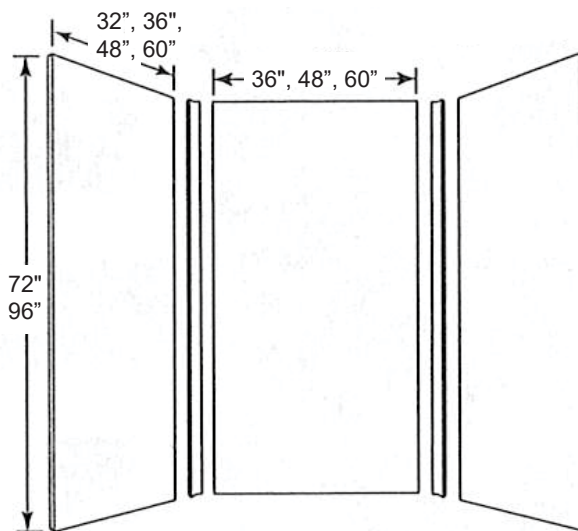

## Transition Wall Kits

## Specified Model:

	SIZE	MODEL NO.	Width	Depth	Height	Weight(lbs)
<b>TRANSITION SHOWER WALL KITS 72"/24"</b>						
<input type="checkbox"/>	36"x36"x72"/24"	EWKX36367224	36"	36"	96"	195
<input type="checkbox"/>	48"x36"x72"/24"	EWKX48367224	48"	36"	96"	226
<input type="checkbox"/>	48"x48"x72"/24"	EWKX48487224	48"	48"	96"	232
<input type="checkbox"/>	60"x36"x72"/24"	EWKX60367224	60"	36"	96"	257
<input type="checkbox"/>	60"x48"x72"/24"	EWKX60487224	60"	48"	96"	285
<input type="checkbox"/>	60"x60"x72"/24"	EWKX60607224	60"	60"	96"	325
<b>TRANSITION SHOWER WALL KITS 84"/12"</b>						
<input type="checkbox"/>	36"x36"x84"/24"	EWKX36368412	36"	36"	96"	195
<input type="checkbox"/>	48"x36"x84"/24"	EWKX48368412	48"	36"	96"	226
<input type="checkbox"/>	48"x48"x84"/24"	EWKX48488412	48"	48"	96"	232
<input type="checkbox"/>	60"x36"x84"/24"	EWKX60368412	60"	36"	96"	257
<input type="checkbox"/>	60"x48"x84"/24"	EWKX60488412	60"	48"	96"	285
<input type="checkbox"/>	60"x60"x84"/24"	EWKX60608412	60"	60"	96"	325

## Single Panel

## Specified Model:

	SIZE	MODEL NO.	DESCRIPTION	Width	Height	Weight (lbs)
<b>SHOWER WALL PANEL 72"</b>						
<input type="checkbox"/>	36" x 72"	EW3672	Shower Wall	36"	72"	48
<input type="checkbox"/>	48" x 72"	EW4872	Shower Wall	48"	72"	63
<input type="checkbox"/>	60" x 72"	EW6072	Shower Wall	60"	72"	80
<b>SHOWER WALL PANEL 96"</b>						
<input type="checkbox"/>	36" x 96"	EW3696	Shower Wall	36"	96"	64
<input type="checkbox"/>	48" x 96"	EW4896	Shower Wall	48"	96"	85
<input type="checkbox"/>	60" x 96"	EW6096	Shower Wall	60"	96"	107

## To Be Specified: Color

Shower Walls Solid Colors	Color-Coordinated Inside Corner Trim	Pattern Colors	Inside Corner Trim
<input type="checkbox"/> 31 White	31 White	<input type="checkbox"/> 41 Bianca	31 White
<input type="checkbox"/> 32 Cameo/Biscuit	32 Cameo/Biscuit	<input type="checkbox"/> 43 Sorento	32 Cameo/Biscuit
<input type="checkbox"/> 39 Grey	39 Grey	<input type="checkbox"/> 44 Sea Fog	39 Grey
		<input type="checkbox"/> 45 Bleached Oak	32 Cameo/Biscuit
		<input type="checkbox"/> 46 Houndstooth	32 Cameo/Biscuit

## Shower Wall w/ Deco Strip Kits:

	SIZE	MODEL NO.	DESCRIPTION	Weight (lbs)
<b>DECO WALL KITS 96"</b>				
<input type="checkbox"/>	60" x 36" x 96"	EDWK603696-	Wall Deco Kits	235
<input type="checkbox"/>	60" x 48" x 96"	EDWK604896-	Wall Deco Kits	235

EDWK includes 60" height 3-pc bottom component set where each panel includes an overlap joint, 36" height 3-pc top component wall set, and a 3-pc Deco Strip Kit (2) 5"H x 36"W, (1) 5"H x 60"W

## To Be Specified: Color

Wall Color	Included Deco
<input type="checkbox"/> Calcite 60	Grey: GD (Garden)/ MS (Mosaic)
<input type="checkbox"/> Lustrous Gold 63	Beach: GD (Garden)/ MS (Mosaic)

(Note: Single panels not available for purchase)

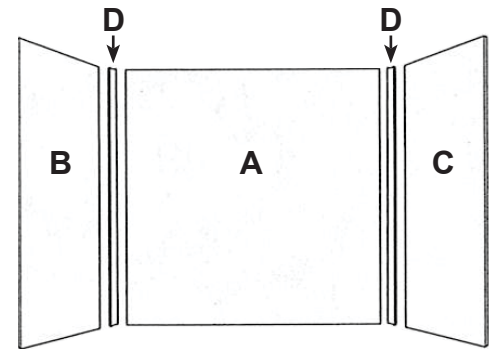
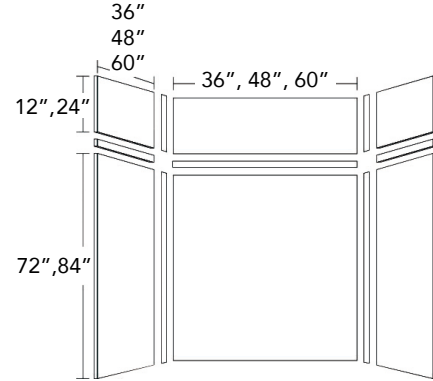

	DESCRIPTION
A	Back Wall (1 panel)
B	Left End Wall (1 panel)
C	Right End Wall (1 panel)
D	Optional Inside Corner Trim (2 pcs.)

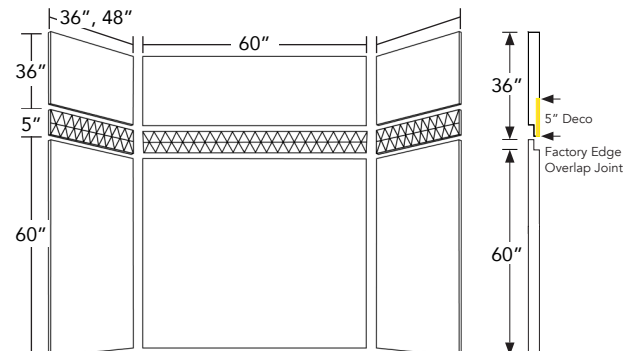

## FEATURES

- Single threshold for alcove installation.
- Heavy duty integral 1" high tiling flange for a waterproof installation.
- 3" wide threshold as well as a 3" threshold height for a modern design.
- Designed for installation for new or existing construction.
- Easy installation. Level with thinset mortar mix.
- 10 Year Limited Residential Warranty / 3 Year Commercial Warranty.

## FL CLASSIC SHOWER BASES

- SMC sheet molding compound material is made from a composite material composed of resin, fiberglass, and stone filler. Compression molded solid surface for a precise radius and angles. It is strong, lightweight, slip resistant and scratch resistant.
- Features a stainless steel concealed drain removable cover that brings both a design element and comfort to your shower experience. Lift-off cover allows for easy cleaning. ABS drain is included.





## Specified Model

FL Center Drain Shower Bases											
	Model	A	B	C	D	E	F	G	H	I	Wt.
<input type="checkbox"/>	FL6036C	36"	18.9"	17.1"	30"	60"	60"	57.7"	31.9"	36"	72
<input type="checkbox"/>	FL6034C	34"	19"	15"	30"	60"	60"	55.6"	29.8"	34"	67
<input type="checkbox"/>	FL6032C	32"	16.9"	15.1"	30"	60"	60"	57.7"	27.9"	32"	62
<input type="checkbox"/>	FL4836C	36"	18.9"	17.1"	24"	48"	48"	45.7"	31.9"	36"	52
<input type="checkbox"/>	FL4832C	32"	16.9"	15.1"	24"	48"	48"	46.2"	28.3"	32"	47

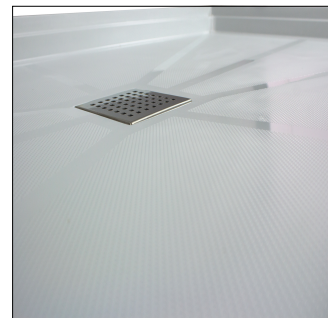
Modern Slip Resistance with a light rectangular comfortable texture. Easy to clean as well as slip resistant.

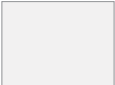
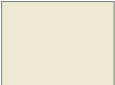

## To Be Specified: Color

<input type="checkbox"/>	31 White			
<input type="checkbox"/>	32 Cameo	White 31	Cameo 32	Grey 39
<input type="checkbox"/>	39 Grey			

## Compliance Certifications - Meets or Exceeds the Following Specifications

- IGC 154-2012
- ASME A112.18.1 / CSA B125.125.1-11
- ASTM 1028-96 coefficient of friction test (minimum rating of 0.67)
- IAPMO 
- cUPC®

## FL Classic Linear Base

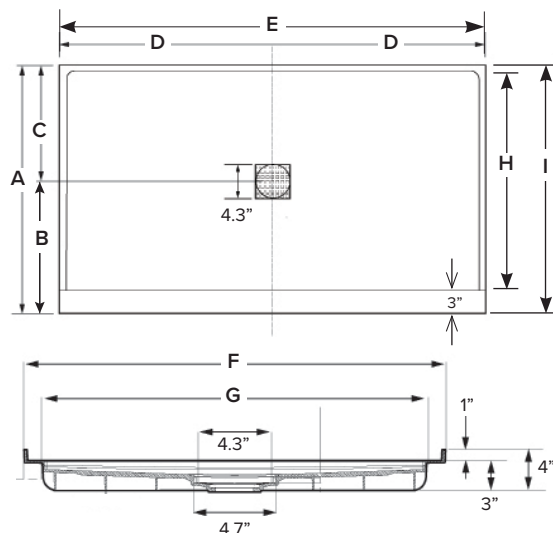

## FEATURES

- An attractive, semi-frame smooth by-pass shower door that features a special Nano protected surface treatment that keeps glass looking clean.
- Walk-in Opening has 19" -- 20-1/4" for 48" width door and 25" -- 26-1/4" for 60" width door.
- New TruMotion technology features premium engineered rolling mechanism system for easy gliding and quiet soft closing sliding doors.
- Up to 3/8" adjustment per side and 3/4" overall for out-of-plumb (uneven) walls within wall profiles.
- Tempered glass is ANSI Z97.1. certified. Glass thickness: 5/16" (8mm) available in Clear and Frost.
- Hardware finishes: Polished Chrome, Brushed Nickel, and Matte Black.
- Shower base threshold minimum requirement is 2-3/8" wide.
- IMPORTANT! All measurements should be taken only AFTER walls are finished (tile, back walls, etc.); Professional installation recommended
- Limited Lifetime Warranty for residential use and 1 year when used commercially.

## Specify Model

	Size	Model	Glass		Depth	Weight
<input type="checkbox"/>	60" x 66"	FBPT606608C-*	Clear (8mm)	66"	2.08"	129 lbs.
<input type="checkbox"/>	60" x 76"	FBPT607608C-	Clear (8mm)	76"	2.08"	149 lbs.
<input type="checkbox"/>	60" x 76"	FBPT607608F-	Frosted (8mm)	76"	2.08"	149 lbs.
<input type="checkbox"/>	48" x 76"	FBPT487608C-	Clear (8mm)	76"	2.08"	122 lbs.
<input type="checkbox"/>	48" x 76"	FBPT487608F-	Frosted (8mm)	76"	2.08"	122 lbs.
<input type="checkbox"/>	60" x 70"	FBPT607008C-	Clear (8mm)	70"	2.08"	138 lbs.
<input type="checkbox"/>	60" x 70"	FBPT607008F-	Frosted (8mm)	70"	2.08"	138 lbs.
<input type="checkbox"/>	48" x 70"	FBPT487008C-	Clear (8mm)	70"	2.08"	113 lbs.
<input type="checkbox"/>	48" x 70"	FBPT487008F-	Frosted (8mm)	70"	2.08"	113 lbs.
<input type="checkbox"/>	60" x 58"	FBPT605808C-	Clear (8mm)	58"	2.08"	116 lbs.
<input type="checkbox"/>	60" x 58"	FBPT605808F-	Frosted (8mm)	58"	2.08"	116 lbs.

\*Limited quantity. Only available in PC.

	60" x 66"	60" x 76"	48" x 76"	60" x 70"	48" x 70"	60" x 58"
Minimum Width	57-3/4"	57-3/4"	45-3/4"	57-3/4"	45-3/4"	57-3/4"
Maximum Width	59"	59"	47"	59"	47"	59"

## To Be Specified : Hardware Color

<input type="checkbox"/>	PC Chrome
<input type="checkbox"/>	BN Brushed Nickel
<input type="checkbox"/>	MB Matte Black



Chrome



Brushed Nickel

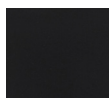

Matte Black



Clear



Frosted

## To Be Specified : Glass

<input type="checkbox"/>	C Clear
<input type="checkbox"/>	F Frosted

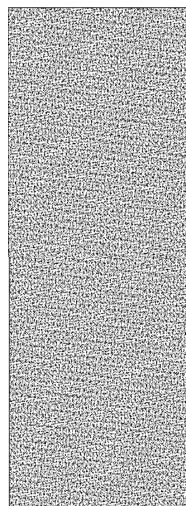

Full Frosted Glass

TruMOTION

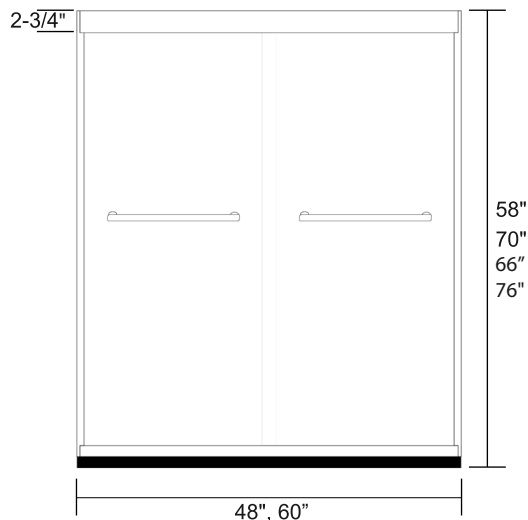

SHOWER DOORS

## FEATURES

- Handles are available in 3 distinctive series.
- Handle size is 19.69" (500mm) center hole to center hole.
- Finish: Polished Chrome (PC), Brushed Stainless (BS), Matte Black (MB) and Champagne Bronze (CB)
- Limited Lifetime Warranty for residential use and 1 year when used commercially.

## Pinnacle, Diamond & Meridian Series Shower Door Handles

Our extensive collection of high end handles add a distinctive look to your shower door and bathroom.

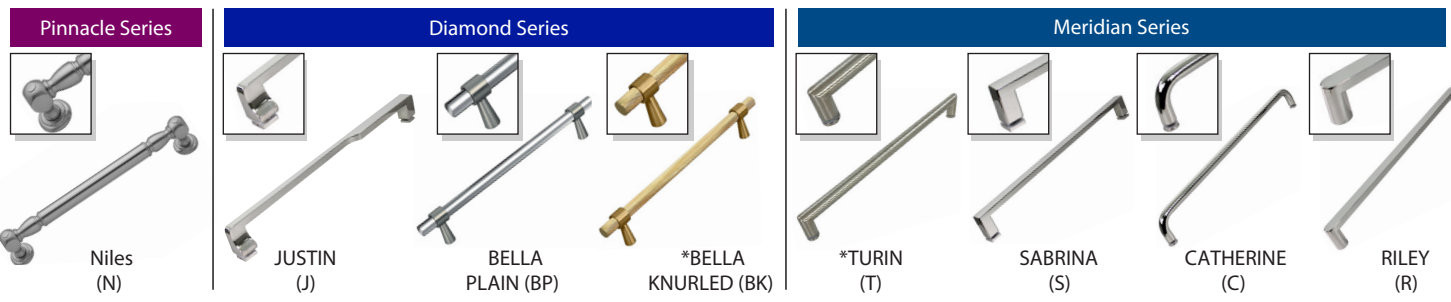

\* Matching grab bar available in different sizes.

### 1. Specify Model: Series & Style

Model	Style	Weight
-------	-------	--------

#### PINNACLE SERIES

<input type="checkbox"/>	PH-BPD-	Pinnacle <b>Bypass</b> Handles (Pair)	6 lbs.
<input type="checkbox"/>	PH-BND-D-	Pinnacle <b>Barn Door Double Sided</b>	6 lbs.
<input type="checkbox"/>	PH-BND-K-	Pinnacle <b>Barn Door Handle &amp; Knob</b>	4 lbs.

#### DIAMOND SERIES

<input type="checkbox"/>	DH-BPD-	Diamond <b>Bypass</b> Handles (Pair)	4 lbs.
<input type="checkbox"/>	DH-BND-D-	Diamond <b>Barn Door Double Sided</b>	3 lbs.
<input type="checkbox"/>	DH-BND-K-	Diamond <b>Barn Door Handle &amp; Knob</b>	2 lbs.

#### MERIDIAN SERIES

<input type="checkbox"/>	MH-BPD-	Meridian <b>Bypass</b> Handles (Pair)	4 lbs.
<input type="checkbox"/>	MH-BND-D-	Meridian <b>Barn Door Double Sided</b>	3 lbs.
<input type="checkbox"/>	MH-BND-K-	Meridian <b>Barn Door Handle &amp; Knob</b>	2 lbs.



### 2. To Be Specified: Handle Name

#### PINNACLE SERIES

☐ **N** Niles

#### DIAMOND SERIES

☐ **J** Justin

☐ **BP** \*Bella

☐ **BK** \*Bella Knurled

#### MERIDIAN SERIES

☐ **T** Turin

☐ **S** Sabrina

☐ **C** Catherine

☐ **R** Riley

### 3. To Be Specified : Color

☐ **PC** Polished Chrome  
☐ **BN** Brushed Nickel  
☐ **CB** Champagne Bronze  
☐ **MB** Matte Black



Chrome

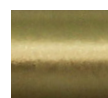

Brushed Stainless

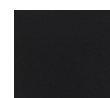

Champagne Bronze



Matte Black

\* **Bella Plain** handles are only available in Chrome finish.

**Bella Knurled** handles are available in Brushed Stainless, Matte Black and Champagne Bronze.



## Features

- Foldable Seat
- Stainless steel mounting bracket for durability
- Holds up to 300 lbs. capacity
- Anti-microbial seat for sanitation

## Warranty

- Lifetime Limited Warranty for residential use
- 5 Year Limited Warranty for commercial use

## Colors & Finishes

- 2 seat colors available: White (01) & Black (09)
- 4 bracket finishes available (See below)

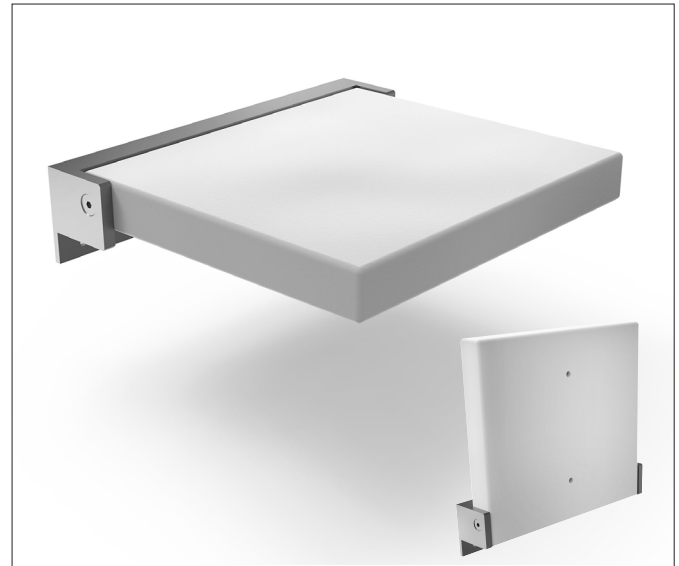

## Specified Model

Model	PPS1414UP-
Size	13.6" x 14" x 1.8"
Shipping Weight	14 lbs.

Model	PPS1420UP-
Size	13.6" x 20" x 1.8"
Shipping Weight	20 lbs.

## To Be Specified:

	Bracket Finishes
<input type="checkbox"/>	PC Polished Chrome
<input type="checkbox"/>	BS Brushed Steel
<input type="checkbox"/>	MB Matte Black
<input type="checkbox"/>	CB Champagne Bronze

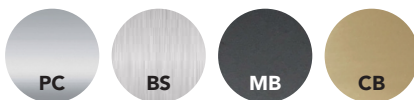

SMPPS1414UP- only available in Polished Chrome

SMPPS1420UP- available in all four finishes

