



Features

- 22" (559) x 19½" (495) top mount kitchen sink.
- Single compartment.
- 18 gauge 304 stainless steel.
- ADA compliant.
- Rear center drain location.
- Brushed finish.
- 15mm radius corners.
- 3mm sound deadening pads.
- Fits 30" base cabinet width.

Components

Product includes:
Cutout Template
Installation Hardware
Installation Instructions

Options

2210R Covered Sink Strainer
4010 Covered Disposer Strainer
TMTK1 Magnetic Tool Set

Warranty

- Lifetime Limited Warranty

Specified Model

	MODEL NO.	Length	Width	Depth	Ship Wt.
<input type="checkbox"/>	CTSB222055	22" (559)	19½" (495)	5½" (140)	9
<input type="checkbox"/>	CTSB22206	22" (559)	19½" (495)	6" (152)	10
<input type="checkbox"/>	CTSB222065	22" (559)	19½" (495)	6½" (165)	11

Model	CTSB2220
Bowl Dimensions	L18" (457) x W14" (355)
Drain holes:	3⅝" (92mm)
Material	18 gauge 304 stainless steel
Installation	counter top mounted
Required	template, included

To Be Specified:

see back for configurations available for this sink

	Faucet Hole Drillings
<input type="checkbox"/>	1 Hole
<input type="checkbox"/>	2 Holes
<input type="checkbox"/>	2 Holes - MR2
<input type="checkbox"/>	3 Holes
<input type="checkbox"/>	4 Holes
<input type="checkbox"/>	5 Holes

Codes/Standards

ASME A112.19.3/CSA B45.4



This sink is compliant to ADA and ANSI/ICC A117.1 accessibility requirements when installed according to the requirements outlined in these standards.

Notes

Install this product according to the installation instructions.

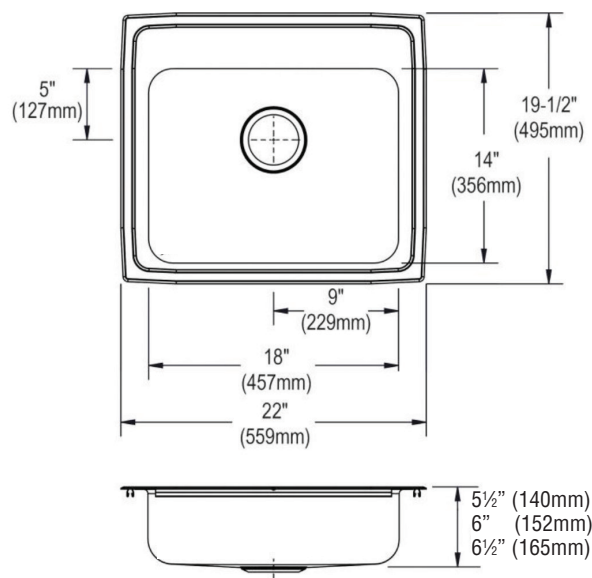

Faucet Hole Configurations available for this sink model

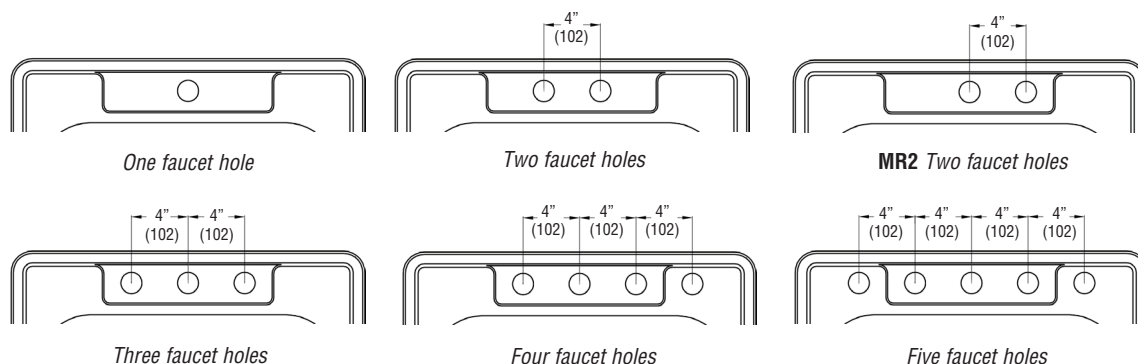

Optional Accessories

2210R Covered Flip Top Sink Strainer.

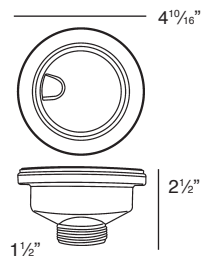

Water drains easily when cover is in place. Cover flips up with easy touch. Polypropylene housing. Fits standard 3½" opening.

2310 Remote Covered Flip Top Sink Strainer.

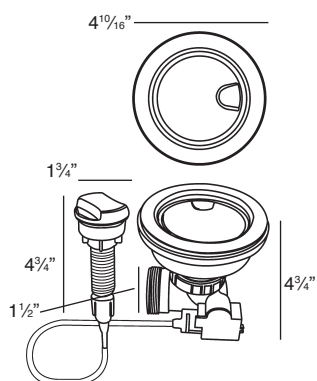

Turn the remote knob to open and close drain. Water drains easily when cover is in place. Cover flips up with easy touch. Polypropylene housing. Fits standard 3½" opening. 1 3/8" hole required in countertop for remote installation. Remote cable 25½" L.

4010 Covered Flip Top Disposer Strainer.

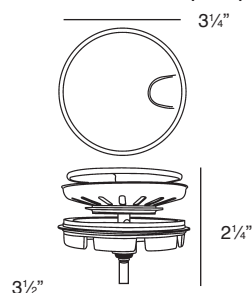

Water drains easily when cover is in place. Cover flips up with easy touch. Polypropylene housing. Top mount installation for 3½" opening.