

Features

- 31½" (800) x 18½" (470) x 10" (254) undermount kitchen sink.
- Double (large/medium) compartments
- Handcrafted from 16 gauge 304 stainless steel. Channel grooves in sink bottom direct water to drain. Premium brushed finish.
- Low 6" (152) high divide.
- Includes 2 stainless steel bottom sink grids, stainless covered flip-top square sink and disposer strainers.
- 10mm radius corners.
- 5mm sound deadening pads.
- Fits 36" (914) minimum base cabinet width.

Components

Product includes:

TSG32192Q Bottom Sink Grid Set
2210Q Square Covered Sink Strainer
4010Q Square Covered Disposer Strainer
Cutout Template
Installation Hardware
Installation Instructions

Warranty

- Lifetime Limited Warranty



Specified Model

Model	DUDOQ321910
Overall Dimensions	L31½" x W18½" x D10" 800 x 470 x 254
Bowl Dimensions (Left)	L17½" x W16⅞" x D10" 445 x 421 x 254
Bowl Dimensions (Right)	L11⅝" x W16⅞" x D10" 295 x 421 x 254
Drain holes:	3½" (89mm)
Shipping Weight	lbs.
Material	16 gauge 304 stainless steel
Installation	under counter mounted
Required	template, included

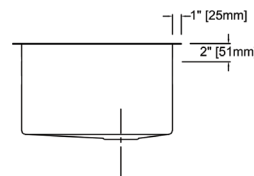
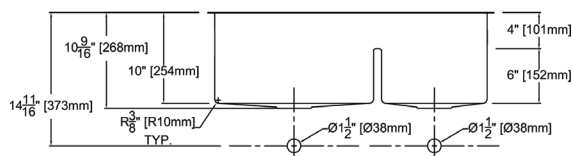
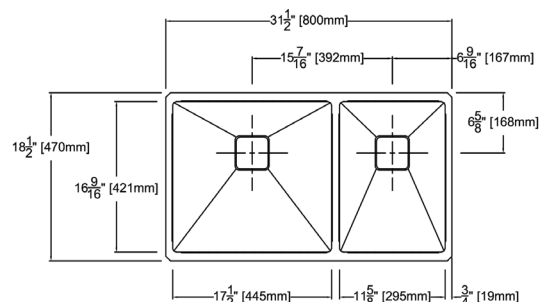

Codes/Standards

ASME A112.19.3/CSA B45.4

Notes

Install this product according to the installation instructions.

Components

Product includes:

TSG32192Q Bottom Sink Grid Set

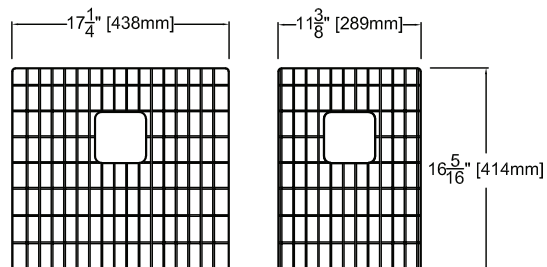

2210Q Square Covered Flip Top Sink Strainer.
Water drains easily when cover is in place. Cover flips up with easy touch. Polypropylene housing.
Fits standard 3½" opening.

4010Q Square Covered Flip Top Disposer Strainer.
Water drains easily when cover is in place. Cover flips up with easy touch. Polypropylene housing.
Top mount installation for 3½" opening.