

### Features

- 23 $\frac{1}{8}$ " (587) x 17 $\frac{53}{64}$ " (453) x 9" (229) undermount kitchen sink.
- Single compartment.
- 16 gauge 304 stainless steel.
- Center drain location.
- Brushed finish with highlight rim.
- 10mm radius corners.
- 3mm sound deadening pads.
- Fits 27" base cabinet width.

### Components

Product includes:

Cutout Template  
Installation Hardware  
Installation Instructions

### Options

TSG23181 Bottom Sink Grid Set  
2210R Covered Sink Strainer or  
4010 Covered Disposer Strainer  
TMTK1 Magnetic Tool Set

### Warranty

- Lifetime Limited Warranty



### Specified Model

Model	MUSB23189
Overall Dimensions	L23 $\frac{7}{64}$ " x W17 $\frac{53}{64}$ " x D9" 587 x 453 x 229
Bowl Dimensions	L21 $\frac{1}{32}$ " x W15 $\frac{3}{4}$ " x D9" 534 x 400 x 229
Drain hole:	3 $\frac{5}{8}$ " (92mm)
Shipping Weight	lbs.
Material	16 gauge 304 stainless steel
Installation	under counter mounted
Required	template, included

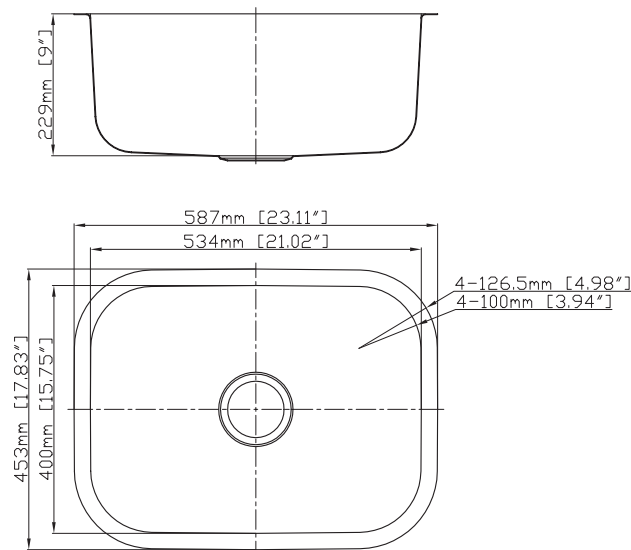

### Codes/Standards

ASME A112.19.3/CSA B45.4

### Notes

Install this product according to the installation instructions.

### Optional Accessories

TSG23181 Bottom Sink Grid

#### 2210R Covered Flip Top Sink Strainer.

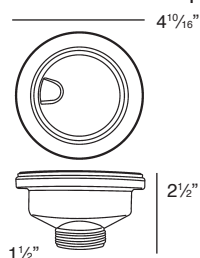

Water drains easily when cover is in place. Cover flips up with easy touch. Polypropylene housing. Fits standard 3 $\frac{1}{2}$ " opening.

#### 2310 Remote Covered Flip Top Sink Strainer.

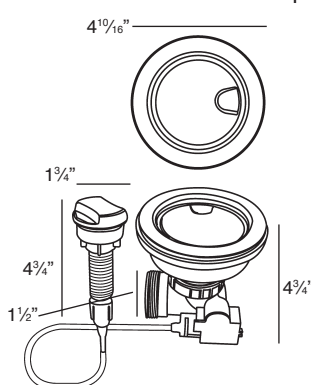

Turn the remote knob to open and close drain. Water drains easily when cover is in place. Cover flips up with easy touch. Polypropylene housing. Fits standard 3 $\frac{1}{2}$ " opening. 1 $\frac{3}{8}$ " hole required in countertop for remote installation. Remote cable 25 $\frac{1}{2}$ " L.

#### 4010 Covered Flip Top Disposer Strainer.

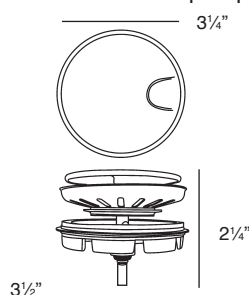

Water drains easily when cover is in place. Cover flips up with easy touch. Polypropylene housing. Top mount installation for 3 $\frac{1}{2}$ " opening.