

### FEATURES

- Kit includes close coupled 2-pc. HET toilet. Combination round front bowl and tank with seat. Wax seal, hold-down bolts, and 2 color-matched bolt caps
- 12" (305mm) rough-in.
- Vitreous china.
- High efficiency (1.28 gpf/4.8 Lpf).
- Gravity feed, siphon action bowl.
- 2" fully-glazed trapway.
- 16-1/2" comfort height.
- Chrome trip lever.
- 5 Year Limited Residential Warranty / 1 Year Commercial Warranty
- Meets strict flushing performance criterion established by the EPA (environmental protection Agency) WaterSense program
- High efficiency toilets use at least 20% less water than standard 1.6 GPF toilets
- This product can help a building earn Water Efficiency points in the LEED Green Building Rating System™

### COLORS

- White

### OPTIONS

- Tank with right-hand trip lever.

### Specified Model

	MODEL NO.	DESCRIPTION	Length	Width	Height
<b>COMPLETE TOILET KITS</b>					
<input type="checkbox"/>	TBTS1-1550	Round Front Toilet Kit	27½"	18⅞"	31⅞"

**To Be Specified:** Color (see below)

☐ **01 White**



TOILETS/LAVS

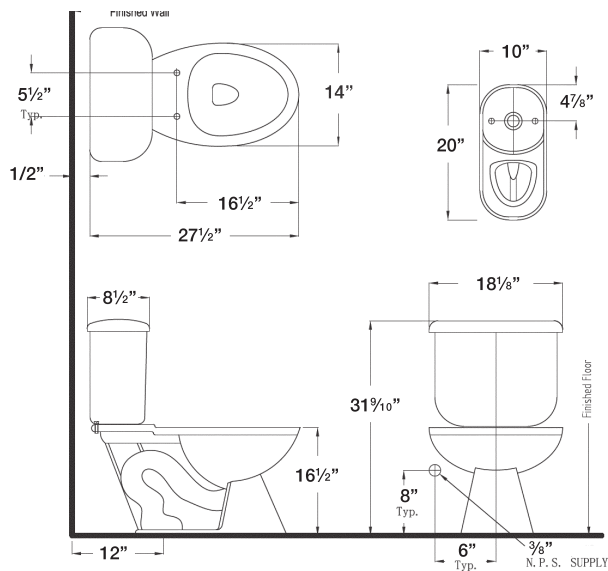

### Compliance Certifications -

#### Meets or Exceeds the Following Specifications

- ASME A112.19.2M-2008/CSA B45.1-2008
- UPC®, National Plumbing Code of Canada, IPC & IRC
- EPA Water Sense Tank-Type High Efficient Toilet Specs

This toilet is designed to rough-in at a minimum dimension of 305mm (12") from finished wall to C/L of outlet. Supply not included with fixture and must be ordered separately.

Dimension shown for location of supply is suggested. For additional information refer to installation instructions supplied.